



Dianthus Close

London, SE2 0UX

£1,600 Per Calendar Month



Situated in a quiet residential road, this well-presented two-bedroom flat is located on Dianthus Close, SE2, a convenient location within Abbey Wood. The property offers bright and practical accommodation, making it an ideal choice for first-time buyers, downsizers or investors alike.

The flat comprises a welcoming entrance hall, a spacious reception room providing ample space for both living and dining, a fitted kitchen, two well-proportioned bedrooms and a family bathroom. The property has been well maintained and offers a comfortable living environment.

Dianthus Close is well positioned for access to Abbey Wood station, which benefits from Elizabeth Line services, providing excellent connections into Central London. Journey times include approximately 11 minutes to Canary Wharf, 18 minutes to Liverpool Street, 23 minutes to Tottenham Court Road and around 28 minutes to Paddington, making this a highly convenient location for commuters.

The property is also close to a range of local shops, amenities and green open spaces, including nearby parks and woodland walks, while Lesnes Abbey Woods and its historic ruins are within easy reach.



LIVING ROOM 9'10" x 16'4" (3.02 x 4.98)

BATHROOM 7'3" x 6'0" (2.22 x 1.84)

KITCHEN 8'9" x 8'9" (2.67 x 2.69)

BEDROOM ONE 11'8" x 10'11" (3.57 x 3.34)

BEDROOM TWO 12'0" x 9'3" (3.66 x 2.82)

Area Map



Floor Plans

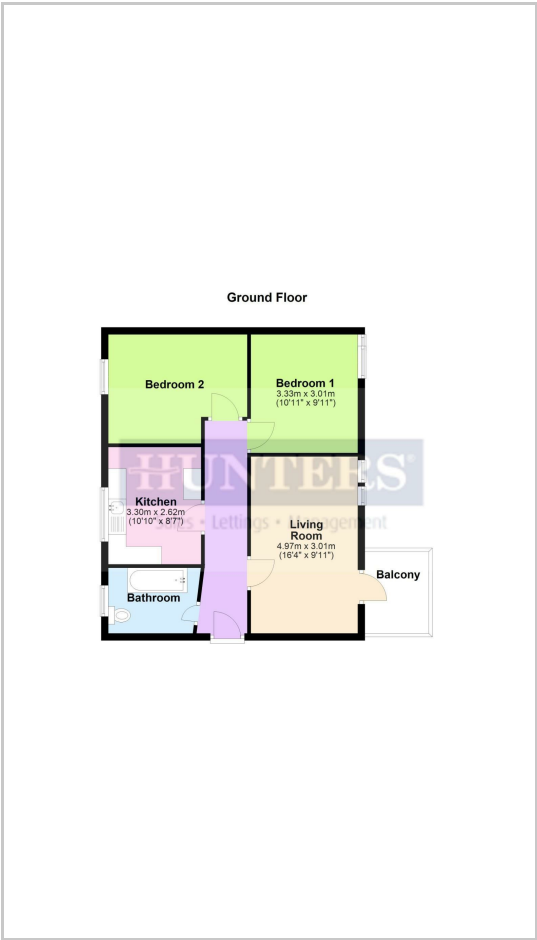

Energy Efficiency Graph



These particulars are intended to give a fair and reliable description of the property but no responsibility for any inaccuracy or error can be accepted and do not constitute an offer or contract. We have not tested any services or appliances (including central heating if fitted) referred to in these particulars and the purchasers are advised to satisfy themselves as to the working order and condition. If a property is unoccupied at any time there may be reconnection charges for any switched off/disconnected or drained services or appliances - All measurements are approximate.

THINKING OF SELLING? If you are thinking of selling your home or just curious to discover the value of your property, Hunters would be pleased to provide free, no obligation sales and marketing advice. Even if your home is outside the area covered by our local offices we can arrange a Market Appraisal through our national network of Hunters estate agents.