



Byefield, Church Lane, Albourne, BN6 9BX

A well-presented detached four bedroom chalet style bungalow sitting on a plot of over one third of an acre, with two bath/shower rooms, two garages and an in-out driveway.

In Excess of
£950,000



**MANSELL
McTAGGART**
Trusted since 1947

Byefield Church Lane

Albourne

This spacious and well-presented detached home provides four bedrooms, two bath/shower rooms and has accommodation arranged over two floors. Sitting centrally on its plot that measures in excess of one third of an acre. The house and gardens are elevated up from the lane and mature planting provides a good degree of seclusion. The in-out driveway, shingle having recently been re-laid to the garages, has two gated access/exit points one onto Church Lane and the other into Leyfield a residential cul-de-sac. There are two single garages and a large parking/turning/hardstanding area hidden away to the rear of the property.

There is a small entrance vestibule leading into the impressive dual aspect sitting/dining room having an exposed brick open fireplace as its focal point, windows to both the front and rear elevations ensure maximum light into this bright airy room. The kitchen/breakfast room is triple aspect and includes a set of double doors opening out to the rear terrace, the kitchen area fitted with a range of shaker style units at both eye and base level with contrasting wooden door furniture, the breakfast area offers space for a large breakfast/dining table and chairs. Off the kitchen there is a useful utility/boot room with a rear lobby and an outside/external boiler cupboard housing the Worcester Bosch gas fired central heating boiler.



Byefield Church Lane

Albourne, Hassocks

The master bedroom includes an extensive range of fitted wardrobe cupboards and has a door into the en-suite bath and shower room, fitted with a contemporary white suite and having 'His 'n' Hers' wash hand basins, bath and a separate shower cubicle. From the inner hallway access is gained to the two further ground floor double bedrooms both having built in double wardrobe cupboards, there is a family bathroom recently re-fitted with tongue and groove wood panelling, bath with shower head, w/c and sink.

On the first floor there is a fourth double bedroom with adjoining walk in wardrobe/storage cupboard, access to the remaining loft is via the walk-in wardrobe. Across the landing from the fourth bedroom is a w/c.

Outside, the gardens surround Byefield on three sides and are considered a feature of the property, the total plot extending to just over one third of an acre. There is a large terrace extending the length of the house with a south facing lawn measuring approx 70ft x 40ft with well stocked borders and offering maximum privacy with mature hedging. To the rear of the property there is a substantial patio which can be accessed from the kitchen/breakfast room and is partially walled offering total privacy. The remaining gardens and grounds are arranged in areas of shaped lawns and well stocked beds. The entire garden is enclosed by mature hedging and gated at both drive entrances.

Council Tax: G, EPC Rating: E



CHURCH LANE



APPROXIMATE GROSS INTERNAL AREA
(EXCLUDING GARAGE)

1712 sq ft / 159.1 sq m

APPROXIMATE GROSS INTERNAL AREA
(INCLUDING GARAGE)

2059 sq ft / 191.3 sq m

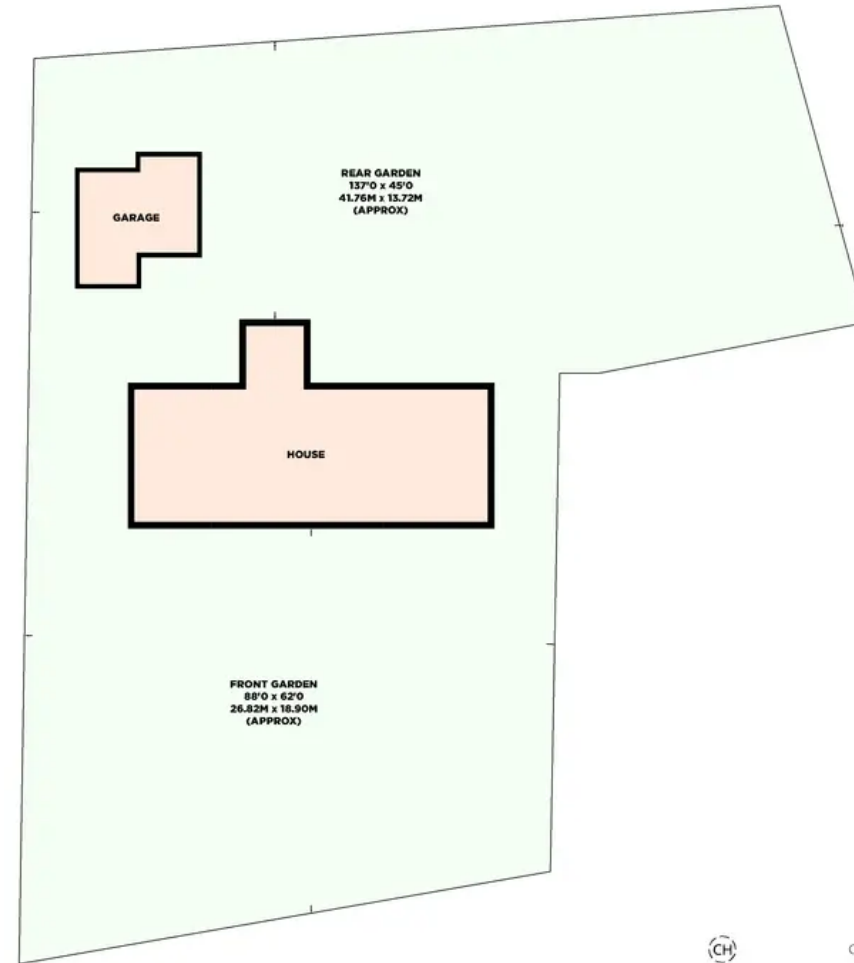

- Ceiling Height
- Hot Water Tank
- Fridge / Freezer
- Head Height Below 1.5m
- Measuring Points
- Storage Cupboard
- Fitted Wardrobes
- Garden Shortened for Display

© Mansell McTaggart 2024
Floor plan is for illustration and identification purposes only and is not to scale.
Plots, gardens, balconies and terraces are illustrative only and excluded from calculations. All site plans are for illustration purposes only and are not to scale.
This floor plan has been produced in accordance with Royal Institution of Chartered Surveyors' International Property Standards 2 (IPMS2). Every attempt has been made to ensure the accuracy however all measurements, fixtures, fittings and shown is an approximate interpretation for illustrative purposes only.

29 Keymer Road, Hassocks, West Sussex BN6 8AB
 has@mansellmctaggart.co.uk

mansellmctaggart.co.uk
 01273 843377

MANSSELL McTAGGART
Trusted since 1947



Certified Property Measurer

Consumer Protection from Unfair Trading Regulations 2008 - We have not tested any apparatus, equipment, fixtures, fittings or services and so cannot verify that they are in working order or fit for purpose. You are advised to obtain verification from your solicitor or surveyor. References to the tenure of a property are based on information supplied by the seller. We have not had sight of the title documents and a buyer is advised to obtain verification from their solicitor. Items shown in photographs are not included unless specifically mentioned within the sales particulars, but may be available by separate negotiation. We advise you to book an appointment to view before embarking on any journey to see a property and check its availability.