

OpenArch
ROOMS
TO LET
02323 864 200



Room 3, 7 Perne Avenue, Cambridge, CB1 3RY

£735 Per annum

Floor Plan

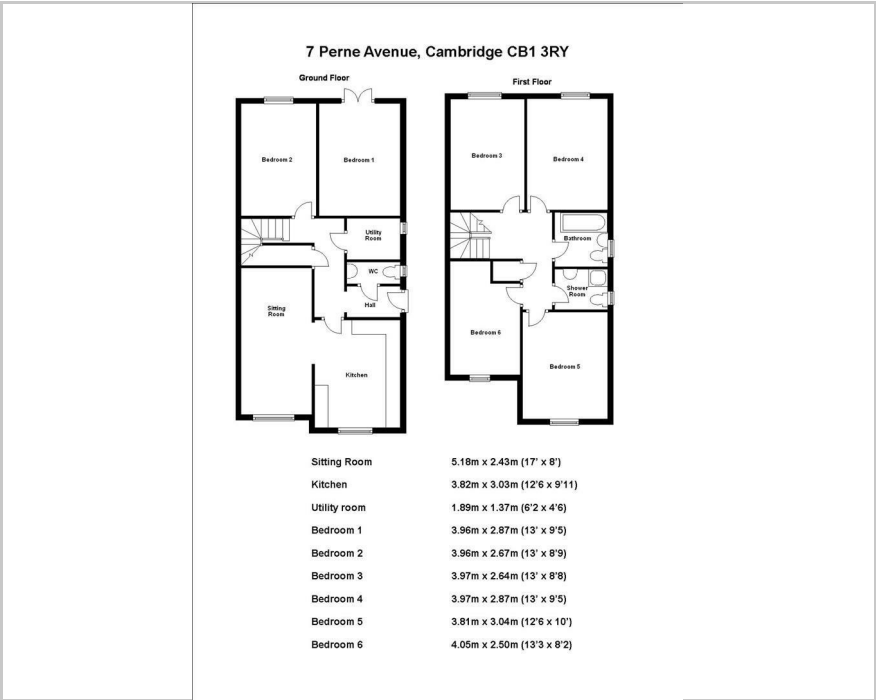

Area Map

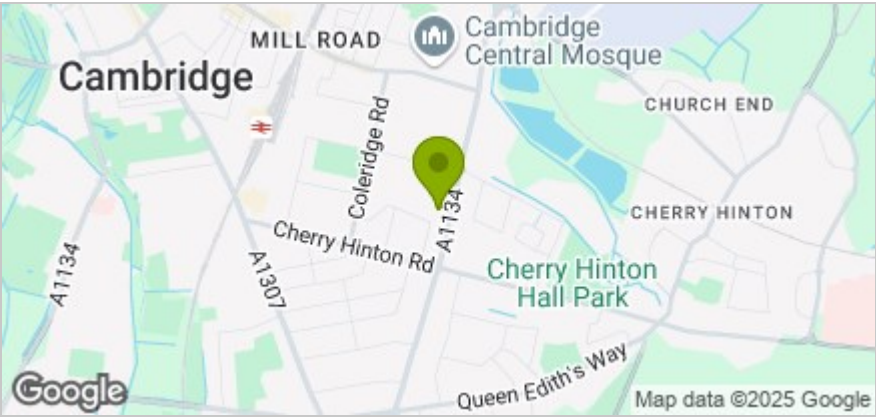

Credit References and Deposit

These particulars, whilst believed to be accurate are set out as a general outline only for guidance and do not constitute any part of an offer or contract. Intending purchasers should not rely on them as statements of representation of fact, but must satisfy themselves by inspection or otherwise as to their accuracy. No person in this firm's employment has the authority to make or give any representation or warranty in respect of the property.

The Grange Market Street, Swavesey, Cambridgeshire, CB24 4QG
Tel: 01223 664200 Email: enquiries@openarch.co.uk www.openarch.co.uk

Accommodation

- Excellent Central Location
- Room to Let
- Garden
- Large Bedroom and Living Area
- EPC: D
- Available Soon
- Utility Room
- 2 bathrooms and a WC

Viewing

Please contact our OpenArch Properties Limited Office on 01223 664200 if you wish to arrange a viewing appointment for this property or require further information.

Energy Efficiency Graph

