



## Flat 7 24 Newmarket Road

, Cambridge, CB5 8DT

£1,150 Per annum



# Flat 7 24 Newmarket Road

, Cambridge, CB5 8DT

£1,150 Per annum



## Disclaimer

Permitted charges in accordance with the Tenant Fee Act 2019

For Assured Shorthold Tenancies

Holding Fee: equal to 1 weeks rent

Deposit: equal to 5 weeks rent if annual rent is less than £50,000 or equal to 6 weeks rent where the total annual rent is more than £50,000

Tenancy Agreement update (during the term): £50

Interest on late rent (more than 14 days overdue):

3% over the Bank of England base rate

For Non-Housing Act Tenancies:

Application Fee: £375

Renewal/Extension Fee: £175

Tenancy Agreement update (during the term): £50

Interest on late rent (more than 14 days overdue):

3% over the Bank of England base rate

Property Redress Scheme:

Member No: PRS009663

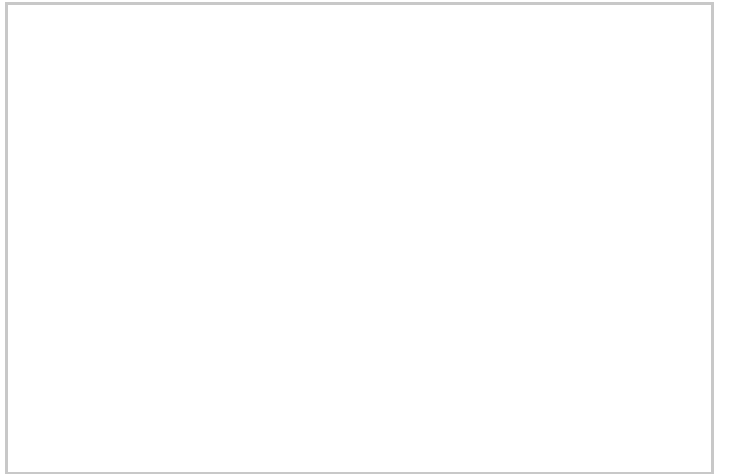
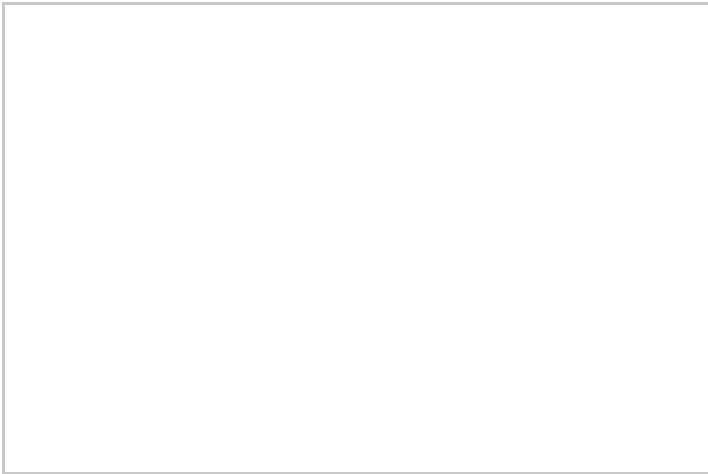
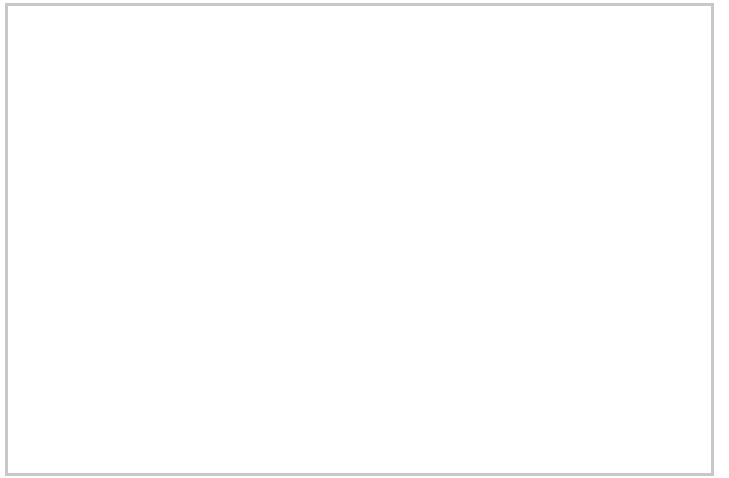

## Road Map



## Hybrid Map



## Terrain Map

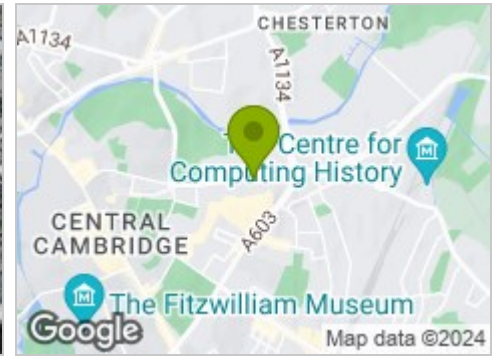

## Floor Plan

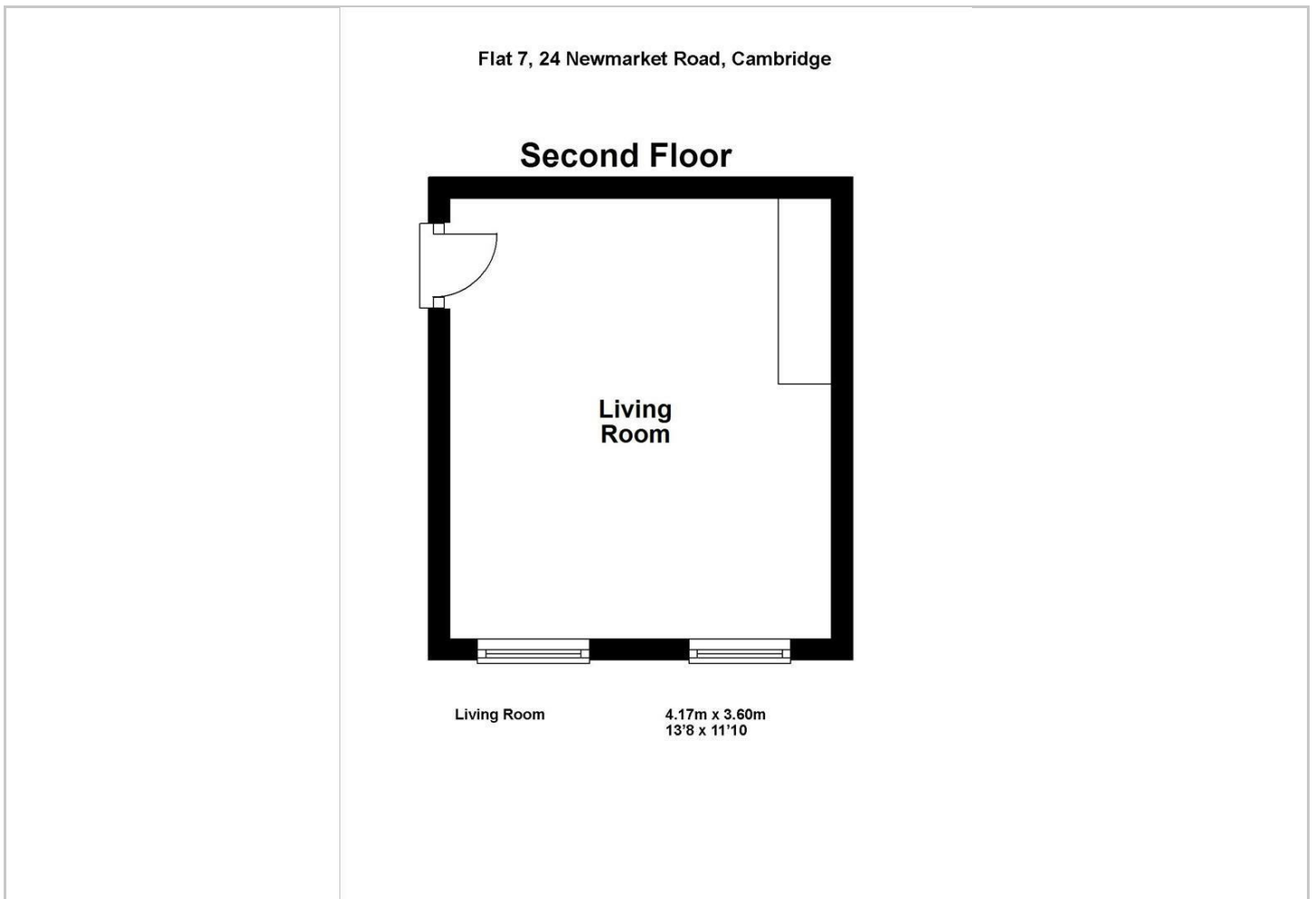

## Viewing

Please contact our OpenArch Properties Limited Office on 01223 664200 if you wish to arrange a viewing appointment for this property or require further information.

## Energy Efficiency Graph

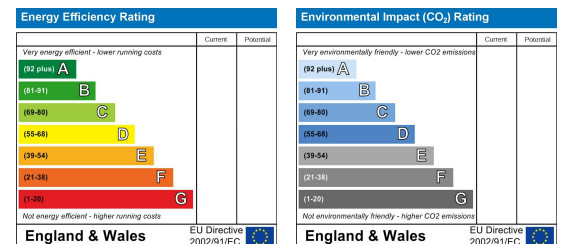

## Credit References and Deposit

Prospective tenants will be required to complete a credit referencing application payable whether successful or not. Prior to taking occupation of the property you will be required to pay a deposit of 1½ times the monthly rent, the first months rent in advance and an administration fee.

The Grange Market Street, Swavesey, Cambridgeshire, CB24 4QG  
Tel: 01223 664200 Email: [enquiries@openarch.co.uk](mailto:enquiries@openarch.co.uk) [www.openarch.co.uk](http://www.openarch.co.uk)