



Clipstone Street, W1W
£599,950

Dexters



Clipstone Street, W1W

A beautifully presented contemporary apartment offering two spacious double bedrooms. Set within a modern building overlooking communal gardens. Moments from the universities, cafés, and attractions of the West End.

The lateral apartment has a bright modern theme with a contemporary kitchen and shower room. Both double bedrooms and the reception room overlook the gardens which are internal to the building.

Please note that the contents are not included in the sale.

Local transport links are Great Portland Street, Goodge Street and Oxford Circus. Main line links are at Euston and Kings Cross St. Pancras.

Features

- Two Double Bedrooms
- Reception Room
- Modern Kitchen & Bathroom
- Opens to Balcony
- Passenger Lift
- Lease to 2107



Clipstone Street, London, W1W

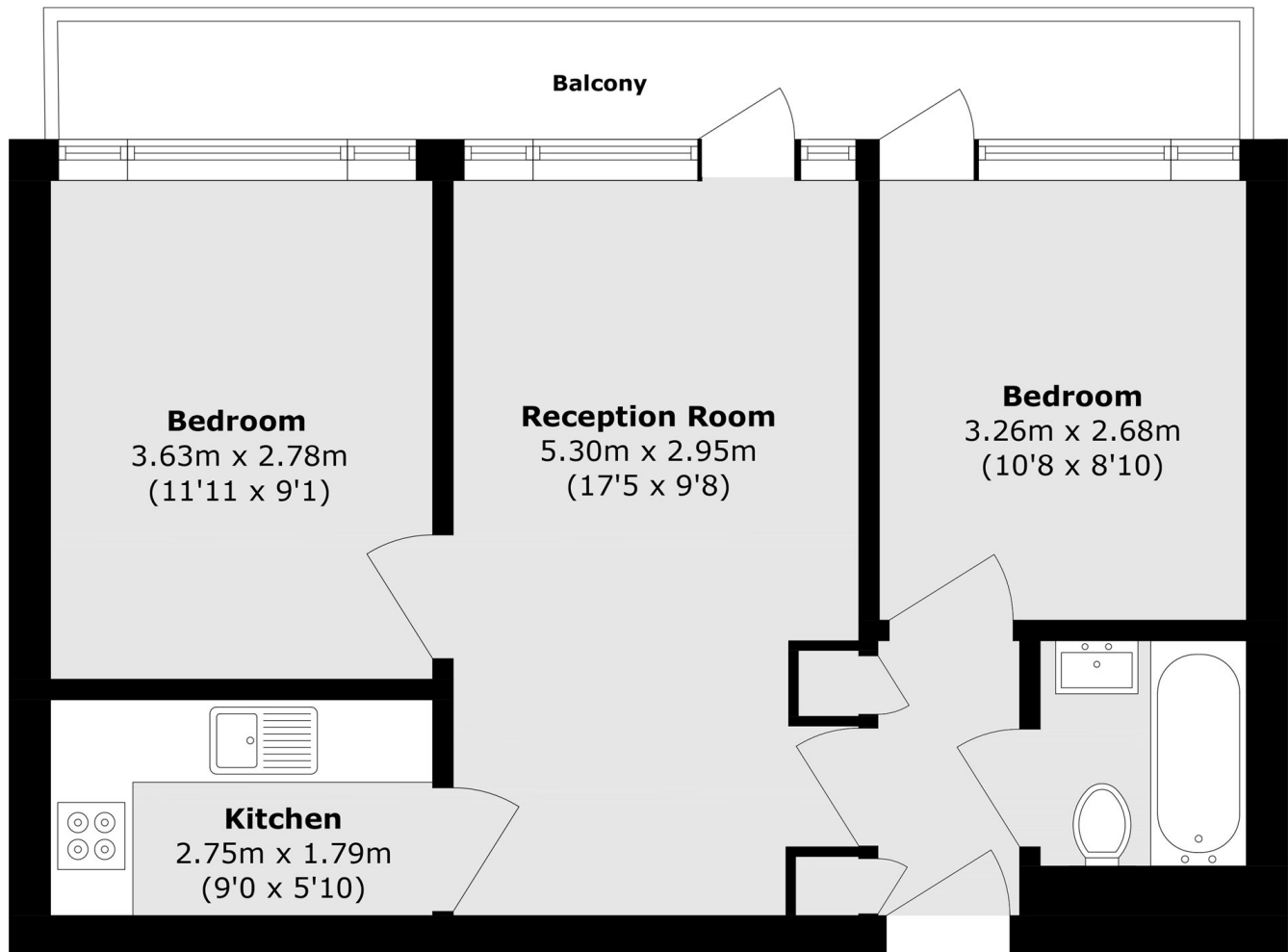

Second Floor

Total area (approx.): 46.5 sq. m (500.5 sq. ft)

Balcony area (approx.): 7.3 sq. m (78.5 sq. ft)