



Clipstone Street, W1W
£599,950

Dexters



Clipstone Street, W1W

A beautifully presented contemporary apartment offering two spacious double bedrooms. Set within a modern building overlooking communal gardens. Moments from the universities, cafés, and attractions of the West End.

Local transport links are Great Portland Street, Goodge Street and Oxford Circus.

Features

- Two Double Bedrooms
- Reception Room
- Modern Kitchen
- Bathroom
- Opens to Balcony
- Passenger Lift



Clipstone Street, London, W1W

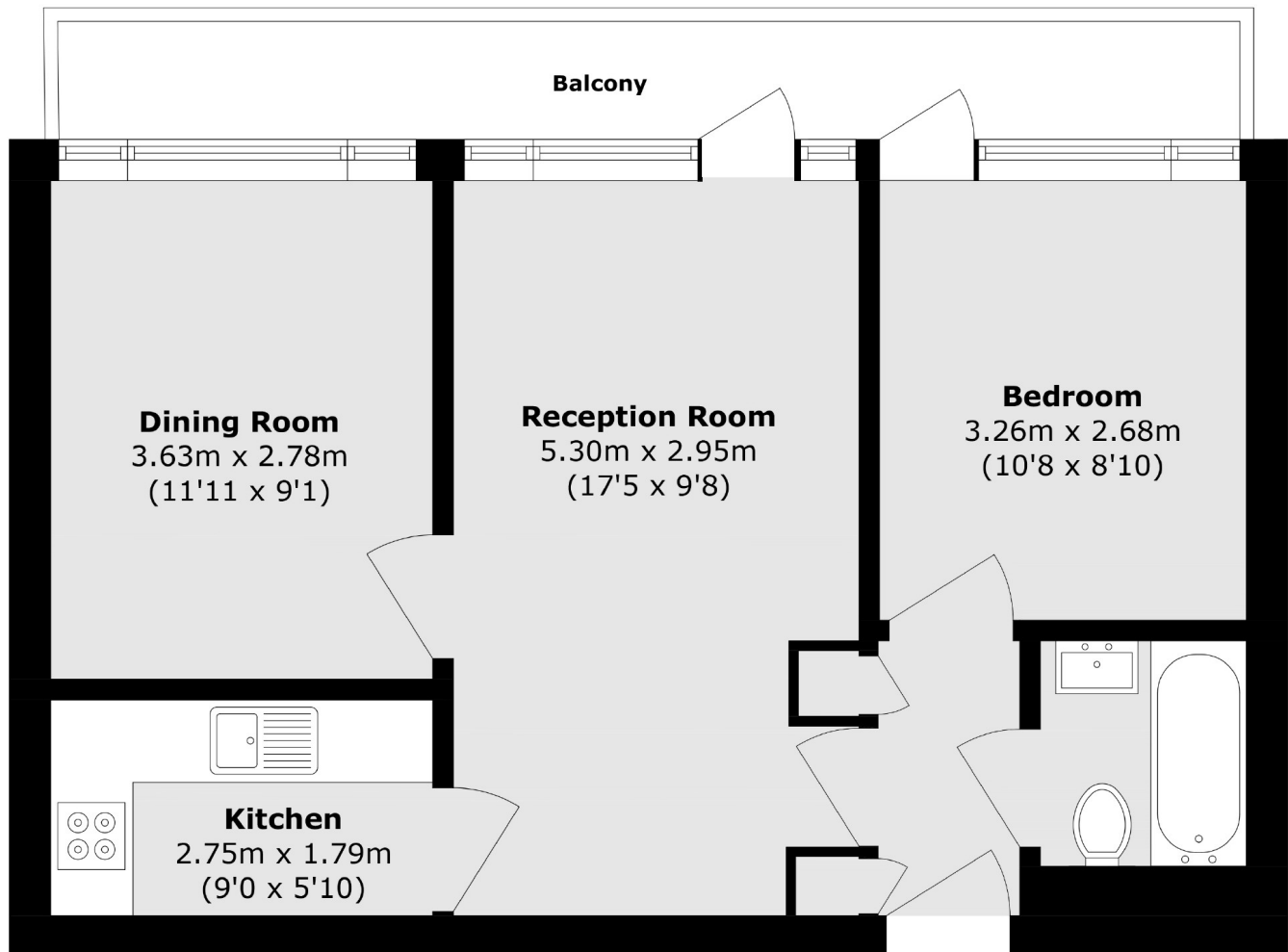

Second Floor

Total area (approx.): 46.5 sq. m (500.5 sq. ft)

Balcony area (approx.): 7.3 sq. m (78.5 sq. ft)