



Gower Mews, WC1E

£760,000

Dexters



Gower Mews, WC1E

A rarely available two bedroom apartment located on the first floor of this 1930's mews building, just a short walk from the world famous British Museum, University College London, SOAS and the University of Law.

Conveniently located within the heart of Bloomsbury and nestled between Bedford Square and Store Street, this delightful two bedroom flat offers tranquility right in the heart of London's West End. The City can be reached on foot and the Elizabeth Line underground means Heathrow is just 30 minutes away.

The accommodation comprises a bright southerly facing reception room with a large bay window, a separate kitchen, bathroom and two double bedrooms. Plenty of built-in storage is provided within the hallway and both double bedrooms.

Gower Mews Mansions are located off Gower Street within Gower Mews, which is perfectly positioned to benefit from the hustle and bustle Central London living has to offer, whilst providing you with peace and quiet when it's needed. Further benefits include access to beautiful and private Bedford Square, a secure bike shed in the Mews and on street parking (subject to Camden Council).

Features

- Two Double Bedrooms
- Reception Room
- Separate Kitchen
- Low Service Charges
- Lease to 2189



Gower Mews, London, WC1E

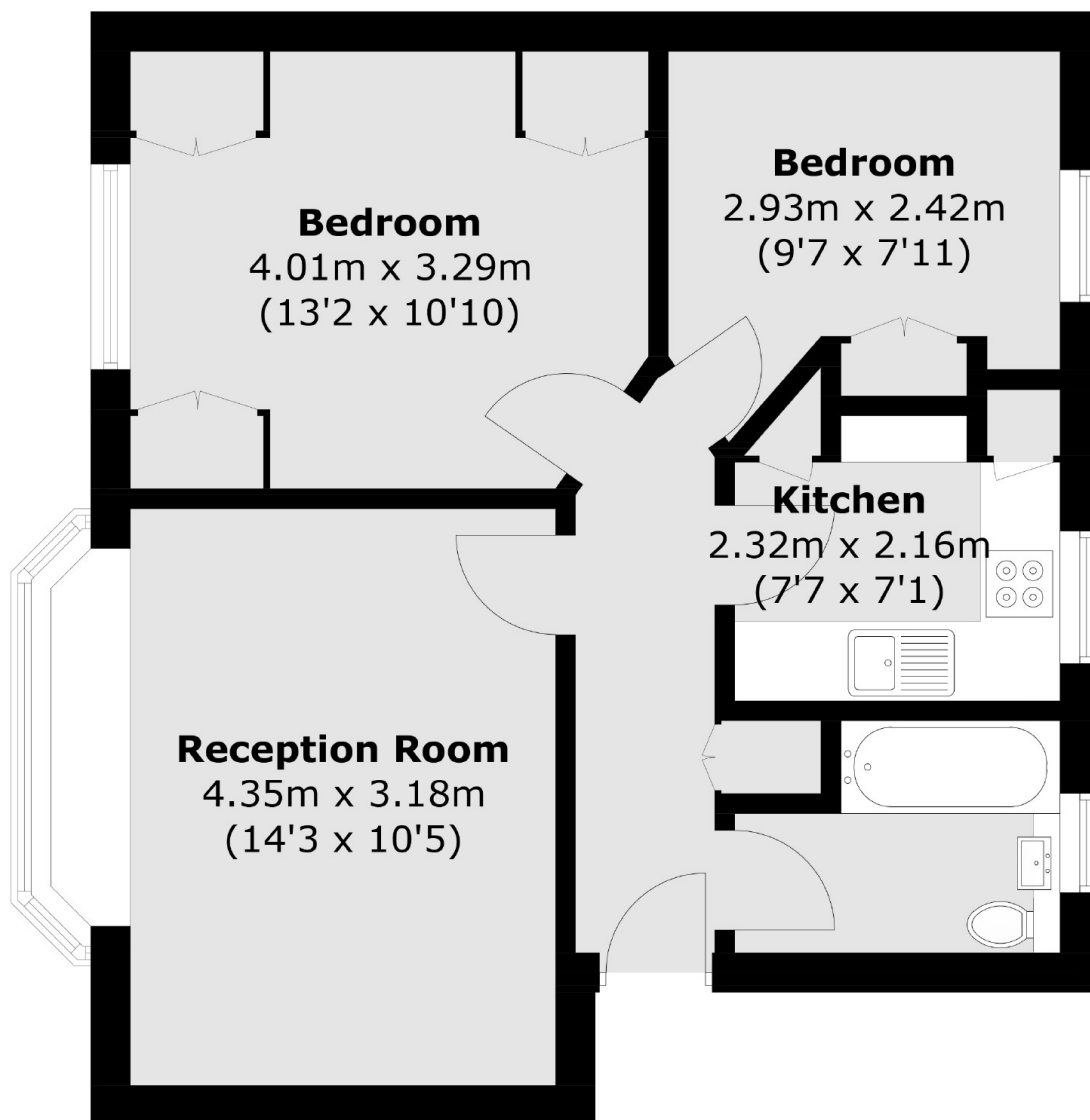

Total area (approx.): 52.5 sq. m (565.1 sq. ft)