



Manchester Street, W1U

£634 Per week

A large studio apartment on the first floor of an attractive Georgian building on Manchester Street, in the heart of Marylebone. The property has high ceilings, a separate kitchen and shower room.

Manchester Street is in the heart of Marylebone Village with Chiltern Firehouse on your doorstep. Bond Street station is only a short walk away.

Features

Marylebone Village
First Floor Studio
High Ceilings
Separate Kitchen
Unfurnished
The Portman Estate

Manchester Street,
London, W1U

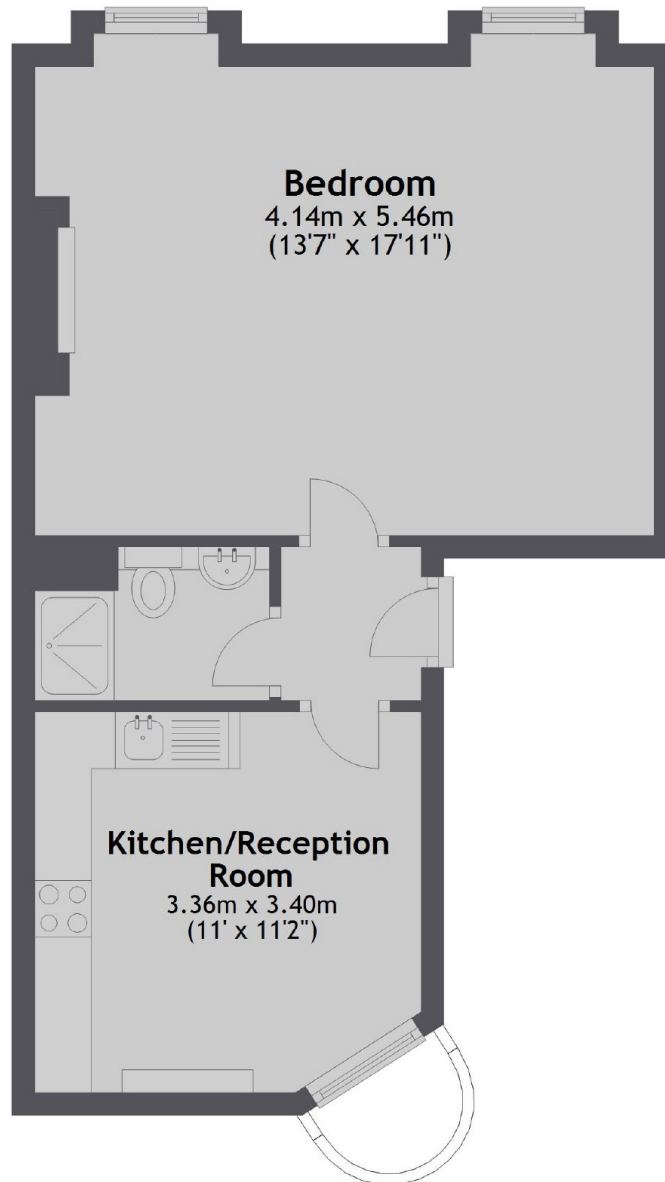

First Floor

Total area: approx. 39.6 sq. metres (425.9 sq. feet)