



Picton Place, W1U

£1,095 Per week

A well-presented and modern two bedroom apartment on the third floor of an attractive portered block, moments from Oxford Street.

The open spaces of Hyde Park are within a short walk away and there are fantastic transport links from Bond Street, Oxford Circus and Marble Arch Underground stations.

Features

- Lift And Porter
- Kitchen/Reception
- Two Bedrooms
- Bathroom
- Private Balconies
- Prime Location



Picton Place, W1U

There is an open-plan kitchen/reception room with wood flooring, high ceilings and doors leading onto a private balcony. There are two good sized bedrooms with built-in wardrobes and a shower room.

The location is unrivalled, with Selfridges adjacent to Picton Place and the shops, bars and restaurants of St.Christopher's Place on your doorstep.



Picton Place, London, W1U

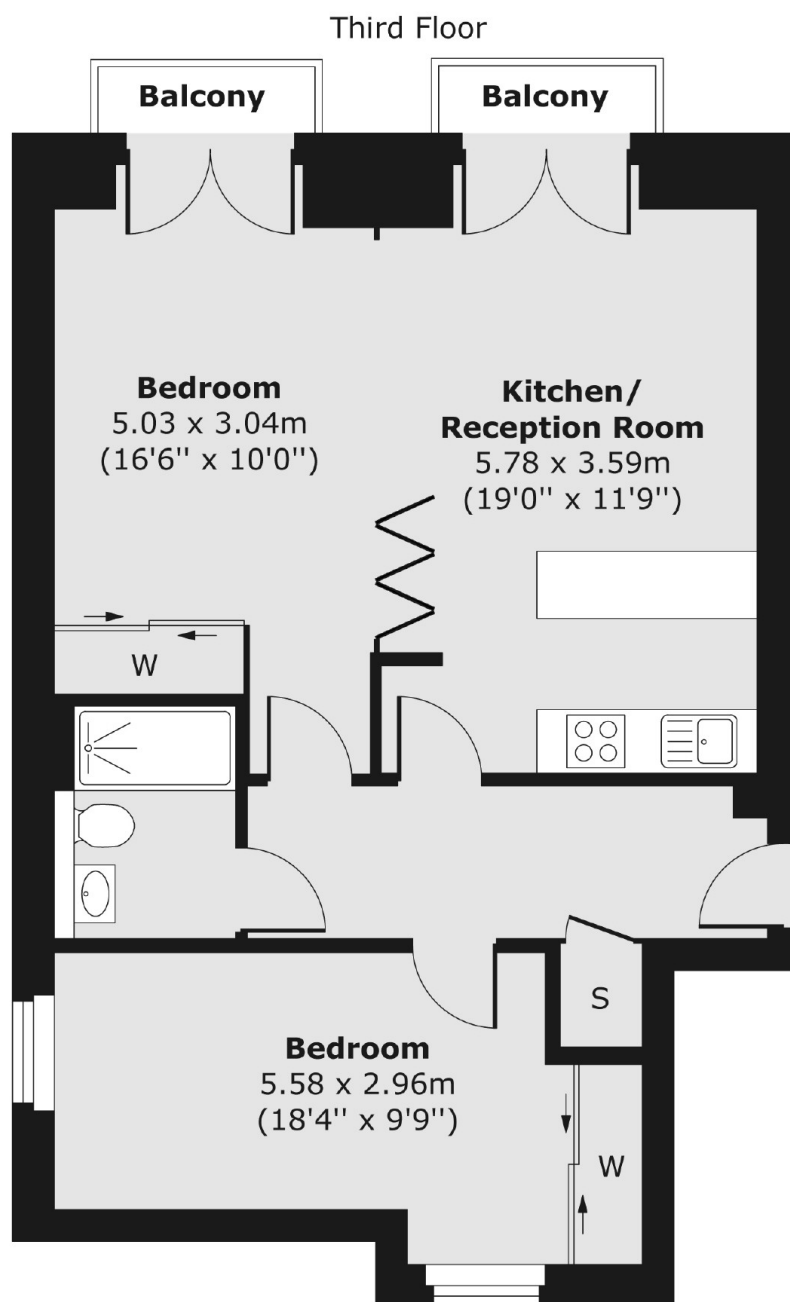

Total area (approx.) 63.13 sq. m (680 sq. ft)

Balcony area (approx.) 2.62 sq. m (28 sq. ft)

Dexters

Marylebone
53-55 Weymouth Street
London
W1G 8NJ
Lettings
0207 224 5545

Energy Rating: B. We aim to make our particulars both accurate and reliable. However they are not guaranteed; nor do they form part of an offer or contract. If you require clarification on any points then please contact us, especially if you're traveling some distance to view. Please note that appliances and heating systems have not been tested and therefore no warranties can be given as to their good working order.

 **RICS** | Regulated
Estate Agent
and Letting Agent

[dexters.co.uk](https://www.dexters.co.uk)