



Portman Square, W1H

£825 Per week

A one bedroom apartment on the seventh floor of a prestigious development on Portman Square. The building has a lift and 24 hour security.

There are fantastic transport connections with Marble Arch and Bond Street Underground stations nearby. The open spaces of Hyde Park are only a short walk away.

Features

Prestigious Garden Square
Seventh Floor Apartment
Private Balcony
Lift And 24 Hour Porter
One Double Bedroom
Phone Entry System



Portman Square, W1H

There is an open- plan kitchen/reception room with wood flooring, floor-to-ceiling windows providing superb natural light, and a door leading onto the large private balcony.

The bedroom is a good sized double room with a built-in wardrobe and dressing area, and a door leading onto the balcony. There is a modern bathroom with separate shower cubicle.

42 Portman Square sits close to The Portman Estate's New Quebec Street and Seymour Place, a favourite for locals, providing a village vibe in the heart of London.



Portman Square, London, W1H

Seventh Floor

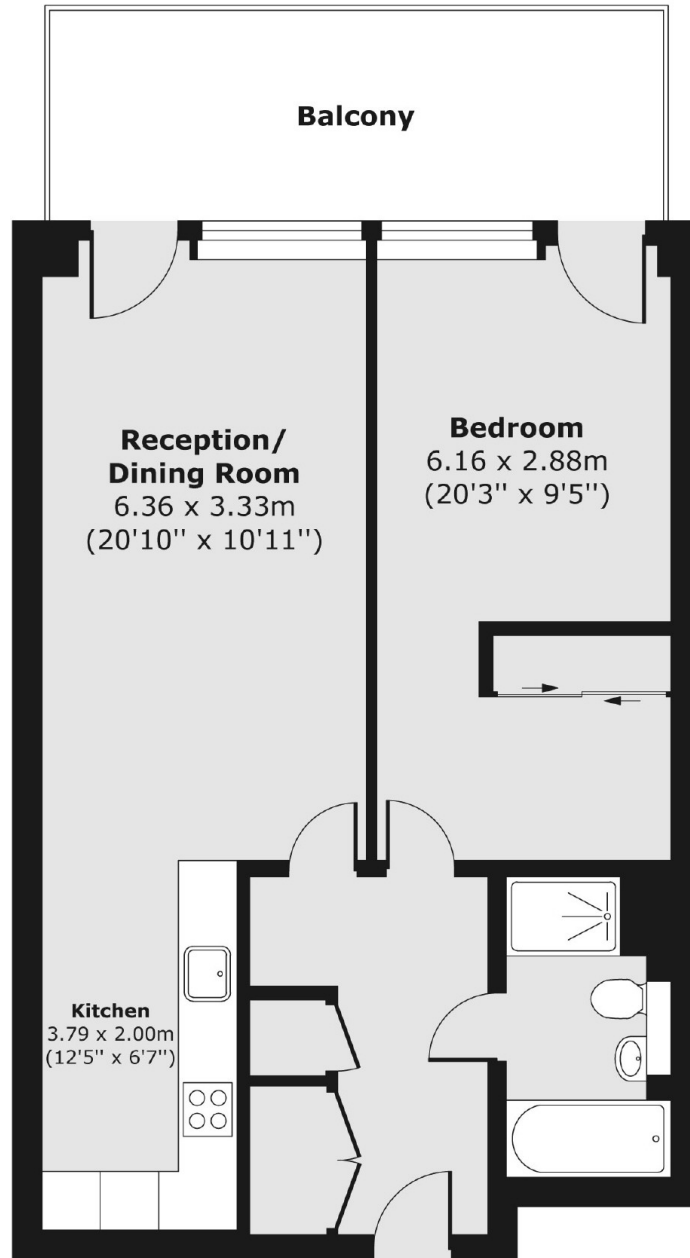

Total area (approx.) 63.60 sq. m (685 sq. ft)
Balcony area (approx.) 13.59 sq. m (146 sq. ft)