

## Upper Berkeley Street, W1H

£650 Per week

This one bedroom apartment forms part of an attractive period building close to Portman Village, with a kitchen/reception room, double bedroom and bathroom.

Upper Berkeley Street is located moments from Portman Village, home to a variety of independent coffee shops and restaurants, whilst Marylebone High Street is only a short walk away. The open spaces of Hyde Park are nearby and there are great transport links from Marble Arch, Bond Street and Baker Street stations.

### Features

- One Bedroom
- One Bathroom
- Unfurnished
- Owned and Managed by The Portman Estate
- Complimentary Membership to Portman Concierge

# Upper Berkeley Street, London, W1H

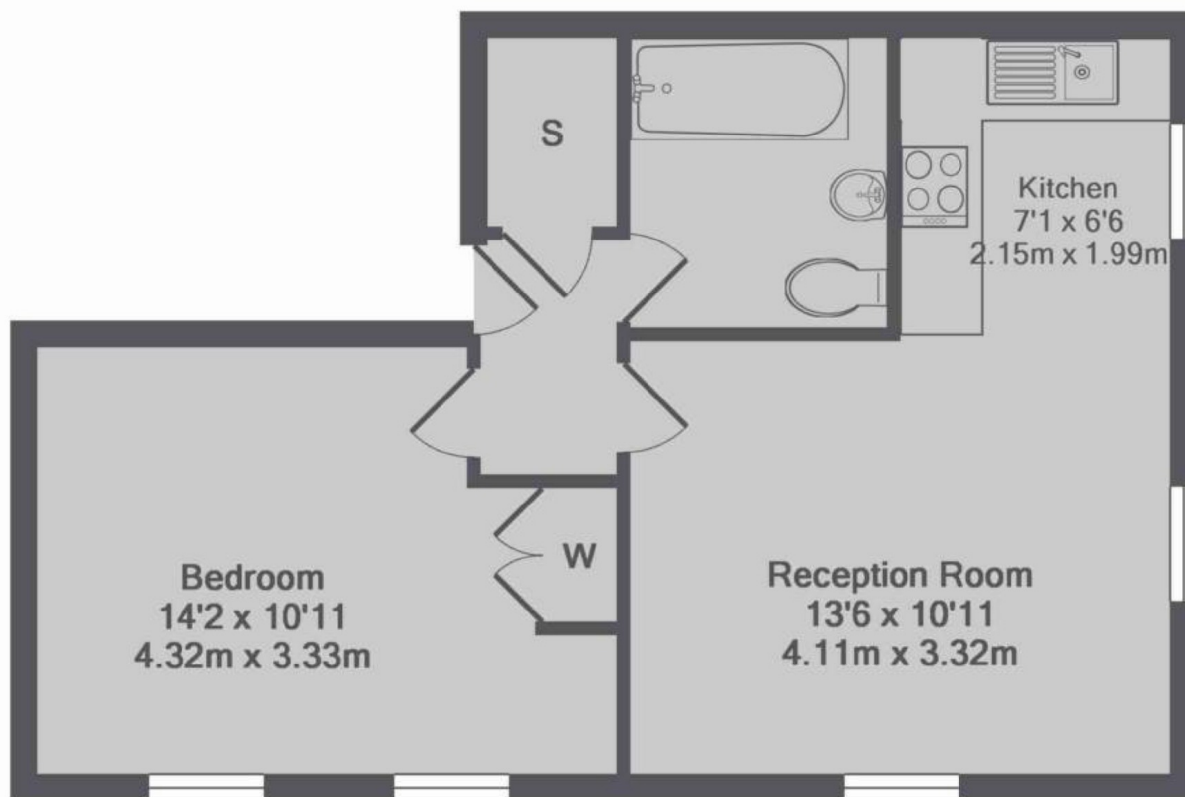

Upper Berkeley Street W1H  
Total Approx. Floor Area 432 Sq.Ft. (40.2 Sq.M.)  
Made with Metropix ©2016