



Seymour Street, W1H

£850 Per week

A two bedroom apartment on the first floor of this portered block on Seymour Street. The flat has a reception, separate kitchen, two bedrooms and one bathroom.

Seymour Street sits on the edge of Portman Village which is a favourite for locals, providing a village vibe in the heart of central London. The vibrant shops, bars and restaurants of Marylebone High Street are also within easy reach.

Features

Portered Building
First Floor
Two Bedrooms
One Bathroom
Separate Kitchen
Reception

Seymour Street, London, W1H

First Floor

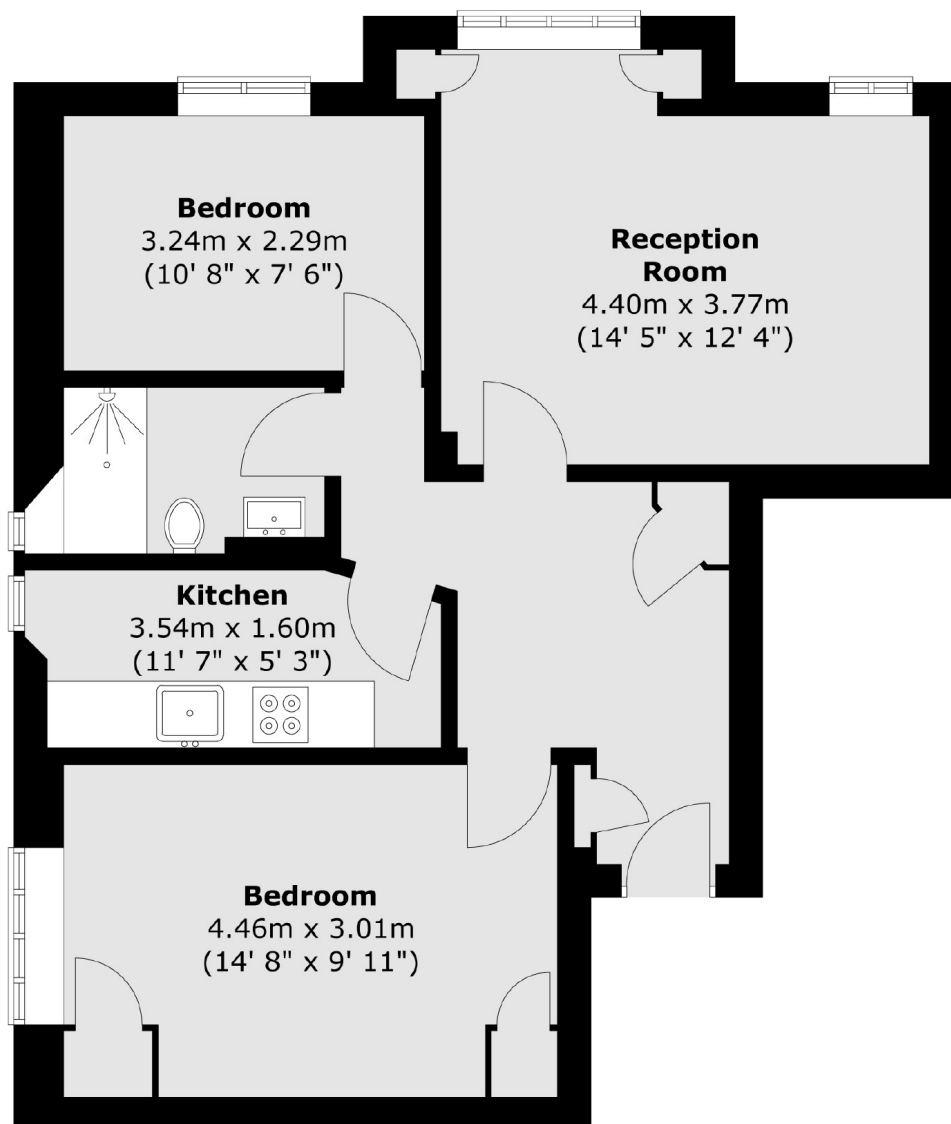

Total area (approx.) : 58 sq. m (624 sq. ft)