

## Great Cumberland Place, W1H

**£830** Per week

This two bedroom apartment is on the seventh floor of a portered building close to Marble Arch, with an open-plan kitchen/reception room, two bedrooms and one bathroom.

Great Cumberland Place is a short walk from the boutique shops, bars and restaurants of Marylebone High Street. Portman Village, which has become the culinary centre for Marylebone's foodies, is just a few streets away; the independent restaurants, cafés and wine bars are popular with locals and tourists alike.

### Features

Portered Building  
Seventh Floor, With Lift  
Two Bedrooms  
One Bathroom  
Kitchen/Reception  
Furnished

# Great Cumberland Place, London, W1H

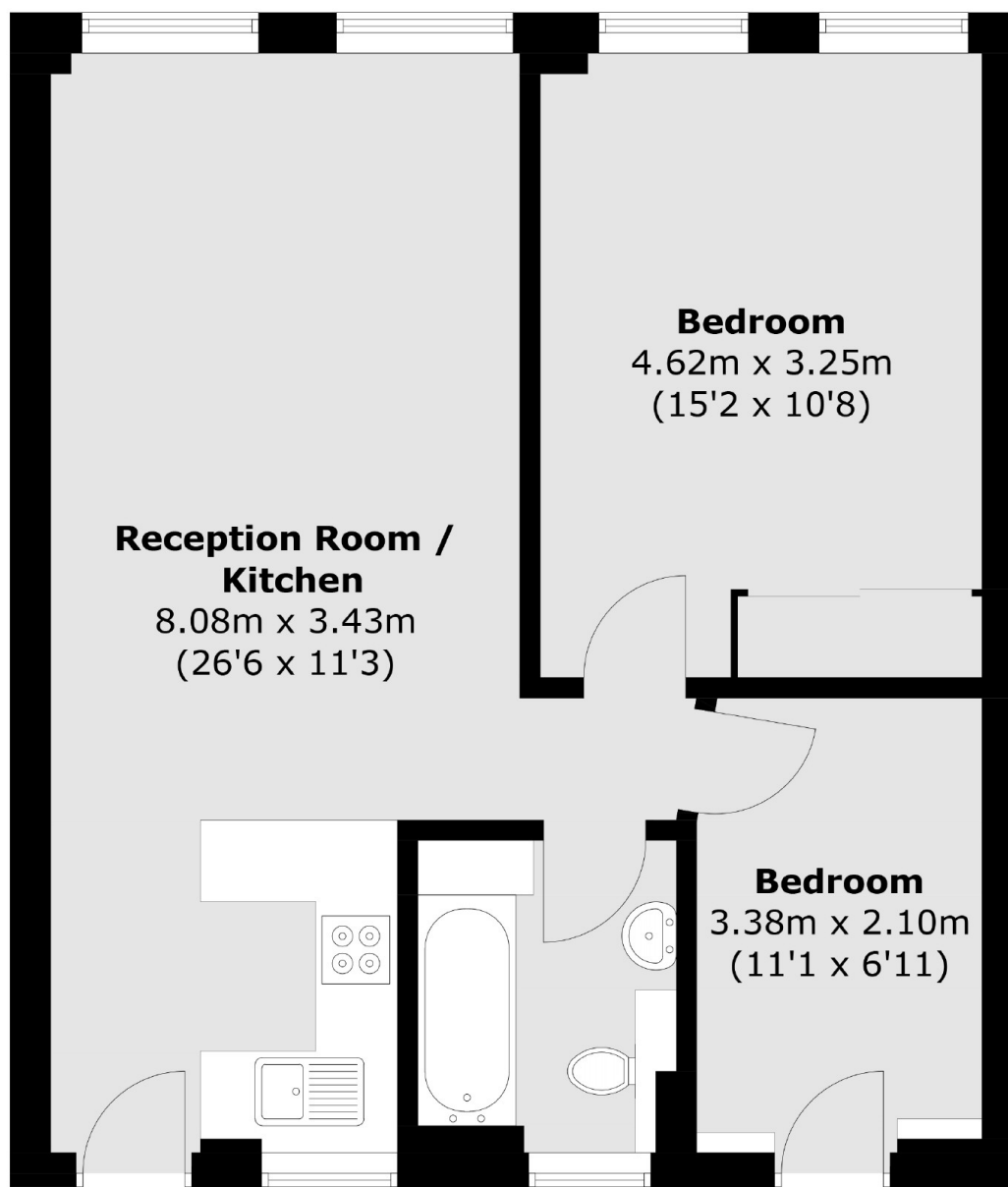

Total area (approx.): 55.7 sq. m (599.5 sq. ft)

## Dexters

Marylebone  
53-55 Weymouth Street  
London  
W1G 8NJ  
Lettings  
0207 224 5545

Energy Rating: C. We aim to make our particulars both accurate and reliable. However they are not guaranteed; nor do they form part of an offer or contract. If you require clarification on any points then please contact us, especially if you're traveling some distance to view. Please note that appliances and heating systems have not been tested and therefore no warranties can be given as to their good working order.

 **RICS** | Regulated  
Estate Agent  
and Letting Agent

[dexters.co.uk](https://www.dexters.co.uk)