

## George Street, W1H

£692 Per week

This two bedroom apartment is on the lower ground floor of this portered block close to Hyde Park. The flat has two double bedrooms, one bathroom and is being offered on a furnished basis.

George Street is moments from Hyde Park, and is served by the famous Portman Village for an array of fashionable boutique shops and restaurants.

### Features

Lift And Porter  
Two Bedrooms  
One Bathroom  
Furnished  
Modern Spec

# George Street, London, W1H

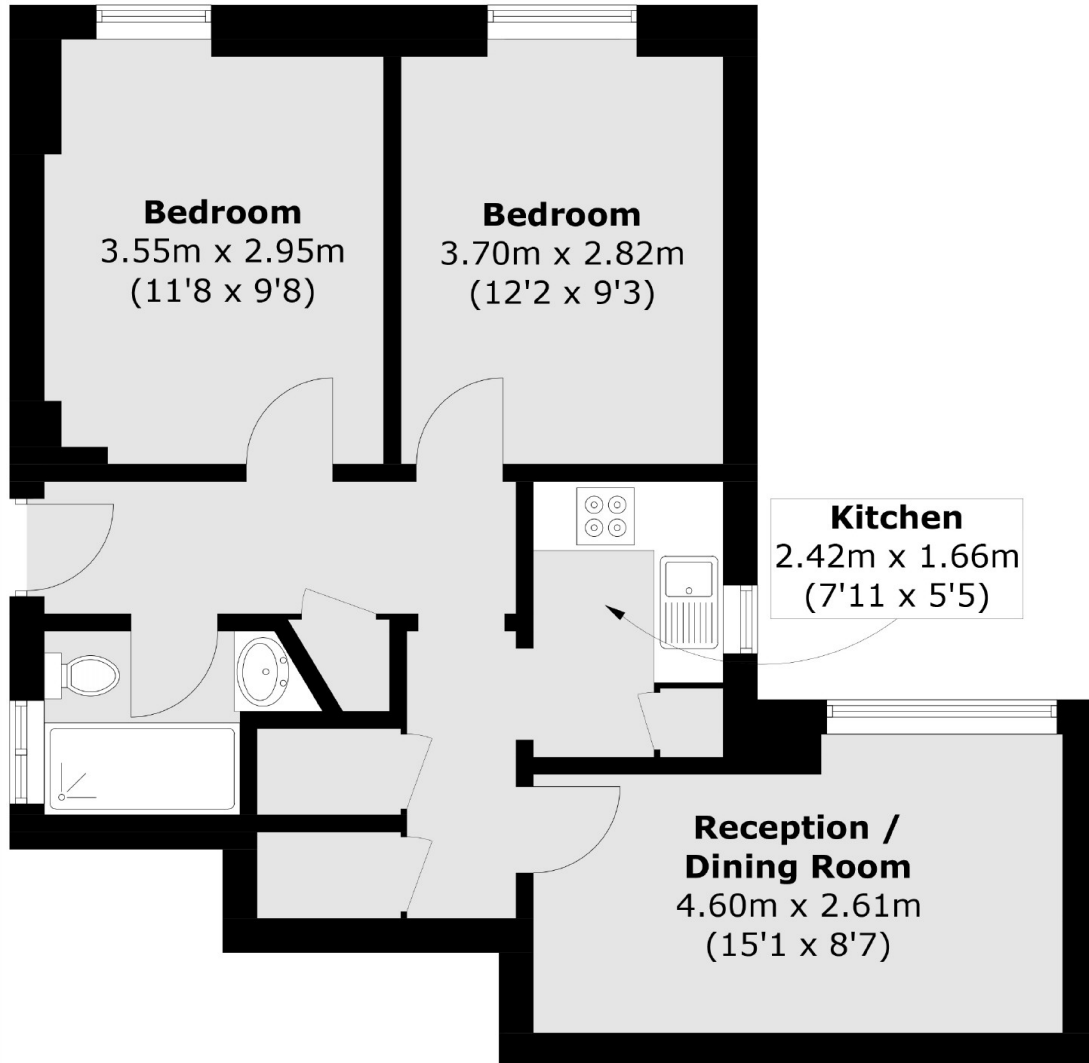

## Lower Ground Floor

Total area (approx.): 52.4 sq. m (564.0 sq. ft)