



## Melcombe Place, NW1

£725,000

A bright one bedroom penthouse apartment situated in a period building. Presented in excellent condition with far reaching views, includes share of head lease. Guide price is £725,000 to £750,000.

Located opposite Marylebone Station providing easy access to the TFL network and the Chiltern Line links to Oxford and Birmingham. Baker Street, Regents Park and Marylebone High Street are a short walk away

### Features

- Top Floor With Views
- Share of Head Lease to 2172
- Service Charge £6000.00
- Passenger Lift
- Access to Balcony
- Chain Free

# Melcombe Place, London, NW1

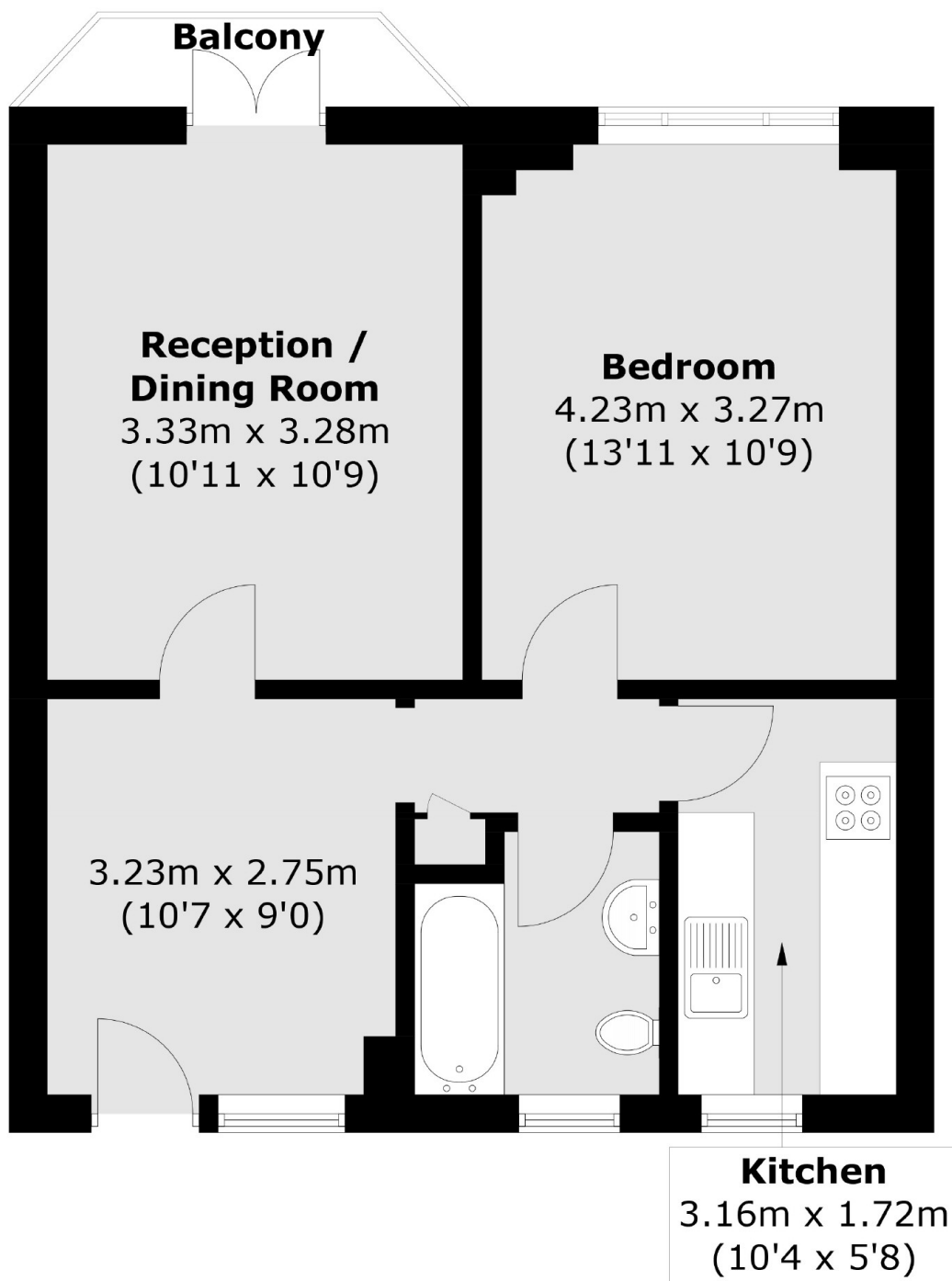

Total area (approx.): 50.6 sq. m (544.6 sq. ft)  
Balcony area : 2.0 sq. m (21.5 sq. ft)