



## Homer Street, W1H

£525,000

A bright one bedroom apartment on the second floor of an Edwardian apartment building. Located in a one way street in the Portman Estate Conservation area.

Local stations are Marylebone and Edgware Road. The waterside reception area of Paddington Basin is close by with Paddington Station beyond.

### Features

- 999 year lease from 2001
- One Bedroom
- Reception Room
- Kitchen
- Bathroom
- Chain Free

# Homer Street, London, W1H

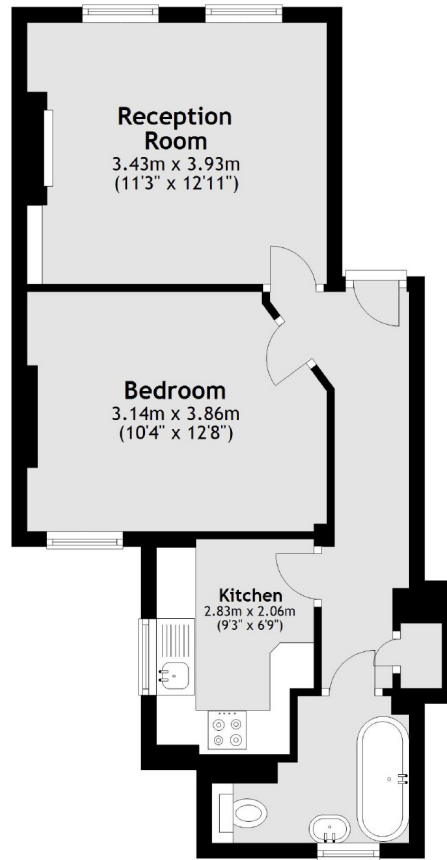

Total area: approx. 42.8 sq. metres (461.0 sq. feet)