



Portman Square, W1H

£800 Per week

A one bedroom apartment on the seventh floor of this prestigious development on Portman Square with a balcony. There is an open-plan kitchen/reception, double bedroom with built-in storage and bathroom.

42 Portman Square sits close to The Portman Estate's New Quebec Street and Seymour Place, a favourite for locals providing a village vibe in the heart of London. There are fantastic transport connections with Marble Arch and Bond Street Underground stations nearby. The open spaces of Hyde Park are only a short walk away.

Features

- Garden Square
- Modern
- Seventh Floor
- Lift & 24 Hour Security
- Kitchen/Reception
- Double Bedroom

Portman Square, London, W1H

Seventh Floor

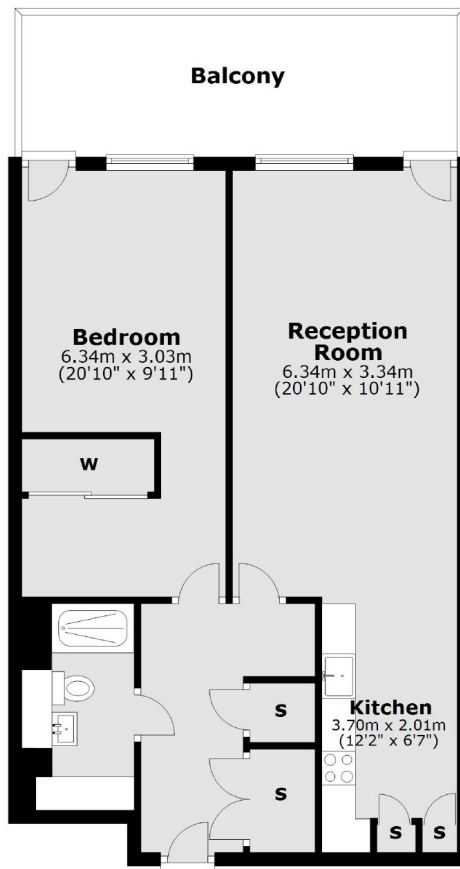

Main area: Approx. 64.5 sq. metres (694.2 sq. feet)
Plus balconies, approx. 14.3 sq. metres (153.8 sq. feet)