



Upper Berkeley Street, W1H

£250 Per week

A modern bedsit on the third floor of a period conversion on Upper Berkeley Street. The bedsit has wood flooring and an open-plan kitchen with modern appliances.

Upper Berkeley Street is opposite the boutique shops on Seymour Place and New Quebec Street.

Features

- Bedsit
- Shared Bathroom
- Newly Refurbished
- Unfurnished
- Modern Appliances
- The Portman Estate

**Upper Berkeley Street,
London, W1H**

First Floor

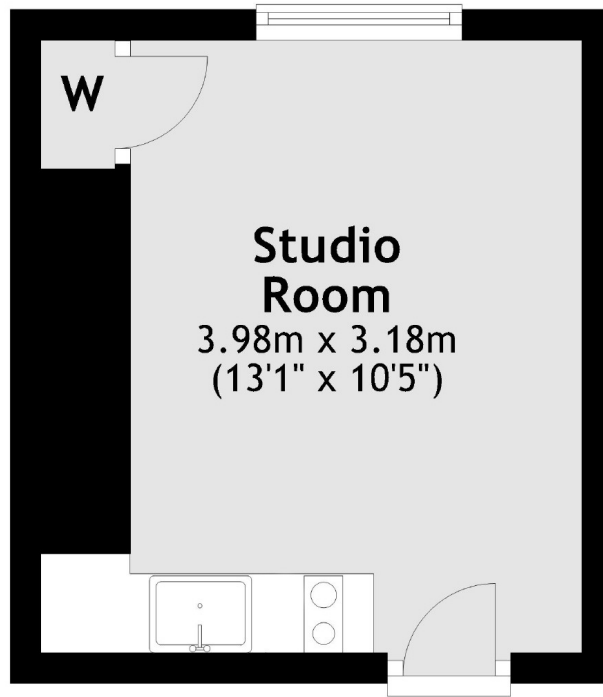

Total area: approx. 14.0 sq. metres (150.5 sq. feet)