



Picton Place, W1U

£945 Per week

A well-presented and modern two bedroom apartment on the third floor of an attractive portered block, moments from Oxford Street.

The open spaces of Hyde Park are within a short walk away and there are fantastic transport links from Bond Street, Oxford Circus and Marble Arch Underground stations.

Features

- Lift And Porter
- Kitchen/Reception
- Two Bedrooms
- Bathroom
- Private Balconies
- Prime Location



Picton Place, W1U

There is an open-plan kitchen/reception room with wood flooring, high ceilings and doors leading onto a private balcony. There are two good sized bedrooms with built-in wardrobes and a shower room.

The location is unrivalled, with Selfridges adjacent to Picton Place and the shops, bars and restaurants of St.Christopher's Place on your doorstep.



Picton Place, London, W1U

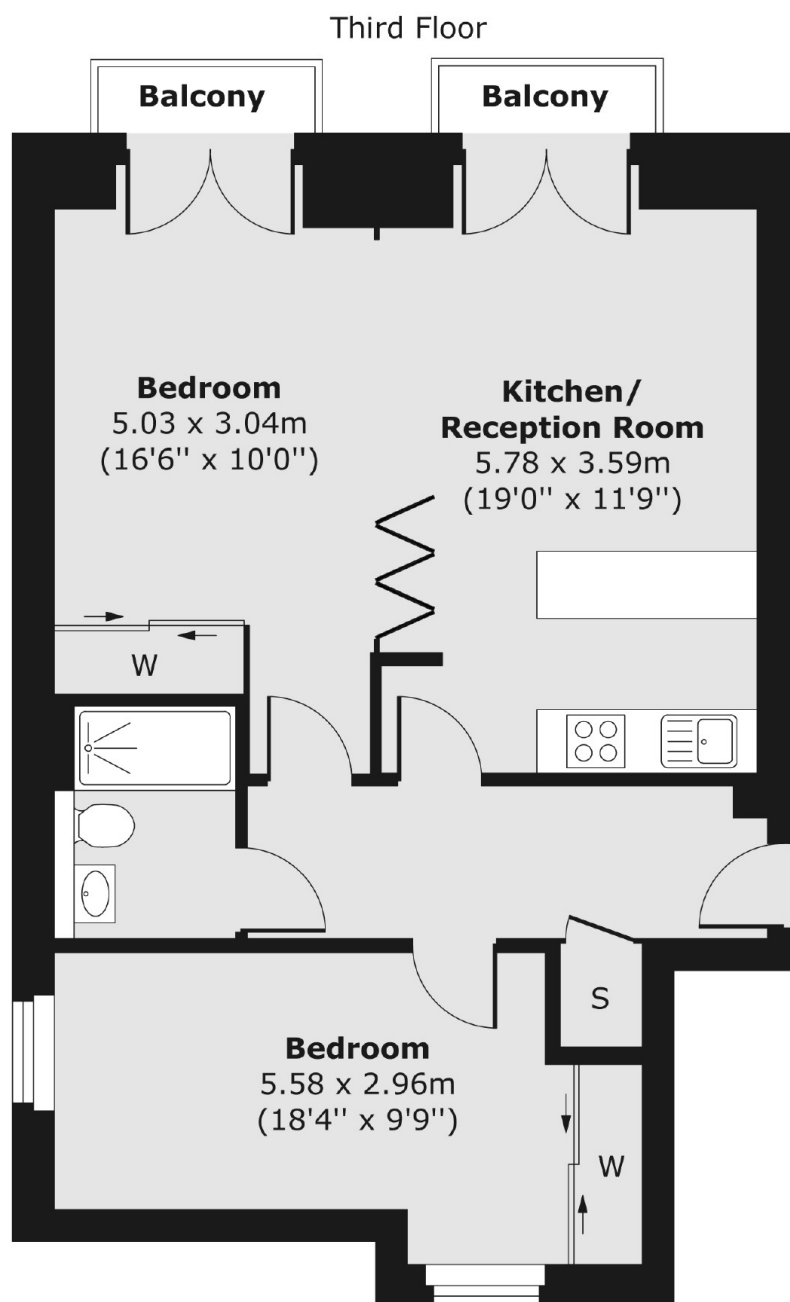

Total area (approx.) 63.13 sq. m (680 sq. ft)
Balcony area (approx.) 2.62 sq. m (28 sq. ft)