



Park Crescent, W1B

£1,000,000

Dexters



Park Crescent, W1B

Offers in excess of £1.0 million. A bright westerly facing apartment in a high end residential block with uniformed concierge. Located in a prime central London address opposite Regents Park.

The building has been refurbished to a high end finish with a grand entrance with 24-hour concierge, security services and modern passenger lifts, and sits behind a rebuilt facade that is influenced by the original 1820 build for the Prince Regent, later George IV, and designed by famed architect John Nash.

The apartment enjoys a westerly facing aspect and has a modern neutral theme. There is a double bedroom with built-in storage, reception room with adequate space to dine, separate modern kitchen and a bathroom.

Residents of the block are able to subscribe to use of the beautiful gated gardens of Park Crescent, where an underpass provides a pedestrian link to the gardens of Park Square. Regents Park is then located beyond.

The crescent is fronted by an elegant stuccoed terrace designed by John Nash.

Features

- One Bedroom
- Reception/Dining Room
- Kitchen
- Bathroom
- Lift
- Uniformed Concierge



Park Crescent, London, W1B

Fourth Floor

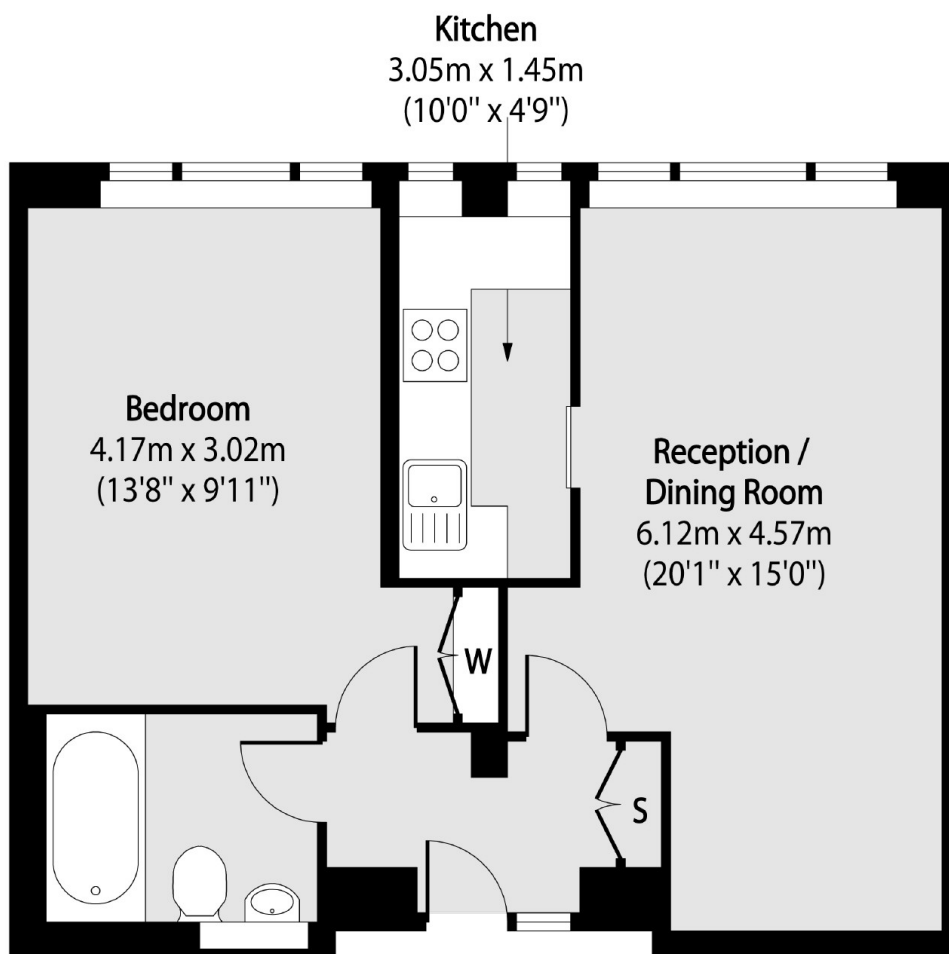

Total area (approx): 45.24 sq m (487 sq. ft)