

Homer Street, W1H

£460 Per week

This well-presented one bedroom apartment has been decorated throughout. There is a separate modern kitchen, reception room, double bedroom and bathroom and the flat is being offered on a furnished basis.

Homer Street is a short walk from the open spaces of Regent's Park and Hyde Park. The closest transport links can be found at Edgware Road, Marylebone and Baker Street stations, and the vibrant shops, bars, cafes and restaurants of Marylebone Village and Portman Village are nearby.

Features

- Newly Redecorated
- Fully Furnished
- One Bedroom
- One Bathroom
- Wood Flooring
- Separate Kitchen

Homer Street, London, W1H

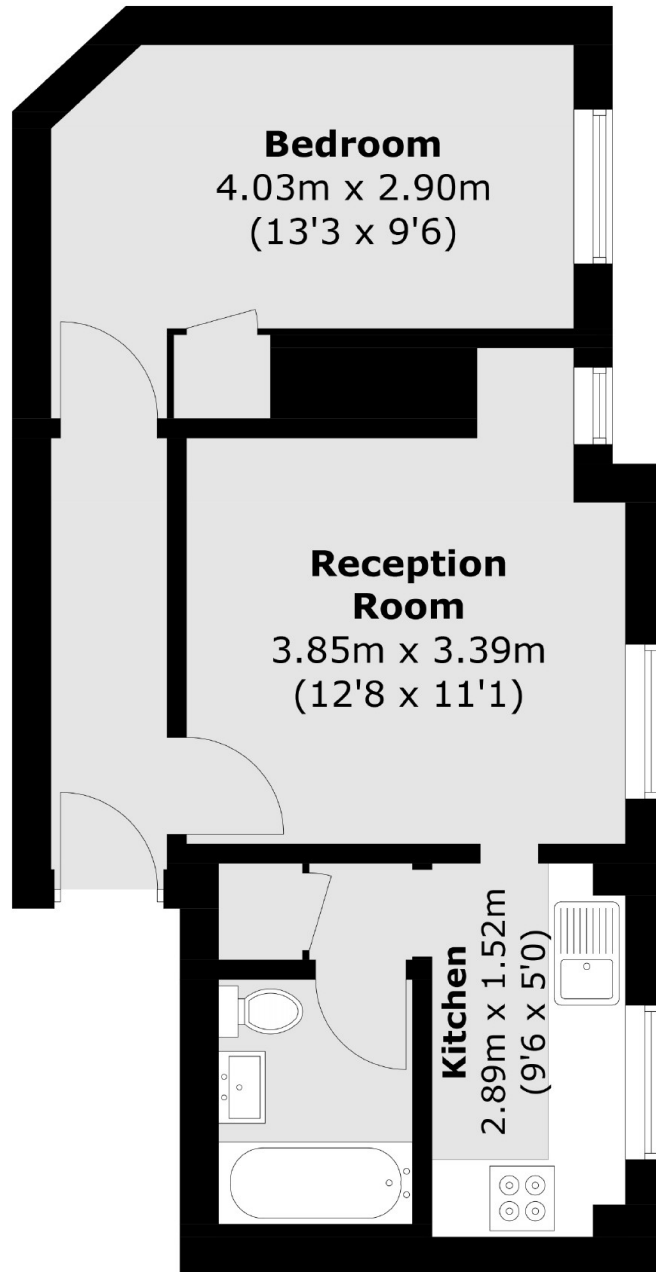

Total area (approx.): 35.9 sq. m (386.4 sq. ft)