



## Luxborough Street, W1U

£725 Per week

A well-presented two bedroom apartment on the first floor of a red-brick mansion block on Luxborough Street. The property has high ceilings and wood flooring throughout.

The open spaces of Regent's Park are moments away, along with Baker Street, Marylebone and Regent's Park Underground stations.

### Features

- First Floor Apartment
- Two Bedrooms
- One Bathroom
- Separate Kitchen
- Marylebone Village
- High Ceilings

# Luxborough Street, London, W1U

## First Floor

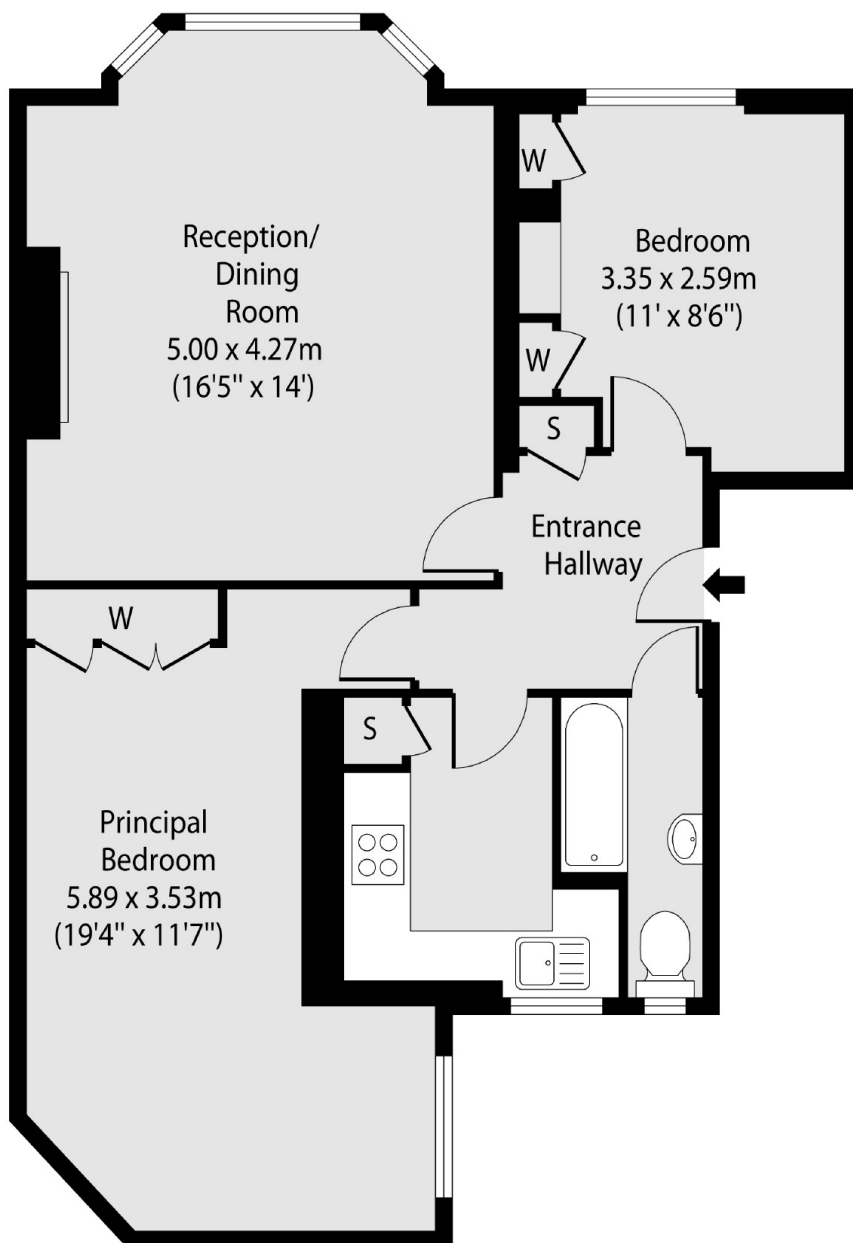

Total area (approx): 63.55 sq m (684 sq. ft)