



Harrowby Street, W1H

£400,000

A one bedroom apartment situated in a Marylebone red brick building with reception and 24 hour porter and lift. With a long lease of 999 years from 2002 this contemporary styled home is offered chain free.

Located between two of London's most prized parks, retail and transport links of Oxford Street and Marble Arch. A 0.5 miles to the glorious green gardens of Hyde Park and Paddington Station and 0.8 miles to Regents Park.

Features

- One Bedroom
- Kitchen-Reception
- Bathroom
- Porter And Lift
- Lease 999 Years From 2002
- Chain Free

Harrowby Street, London, W1H

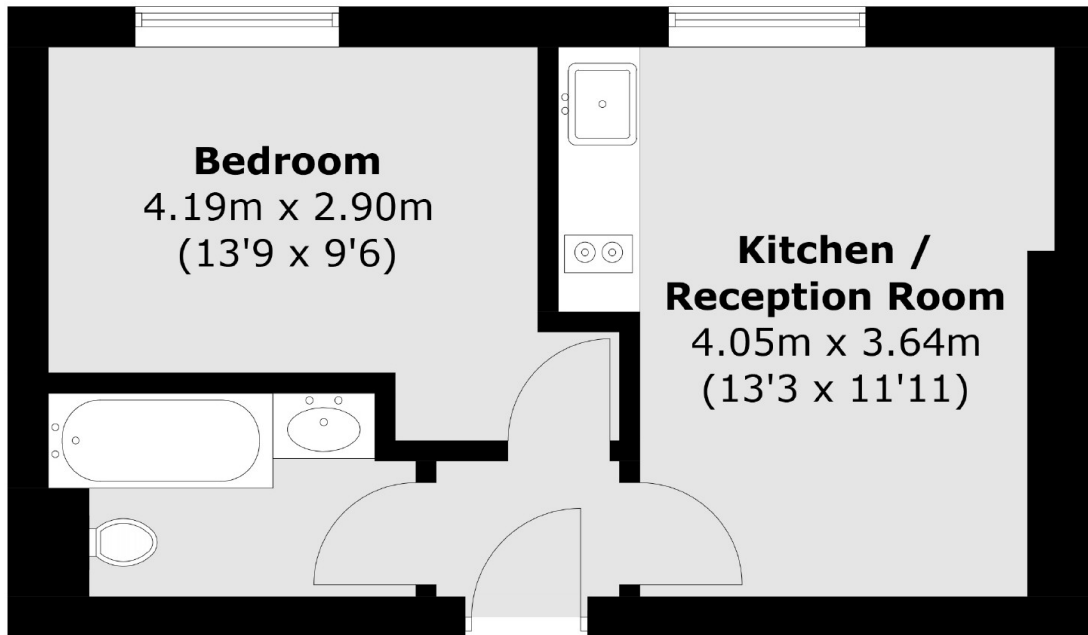

Total area (approx.): 30.1 sq. m (323.9 sq. ft)