



Harrowby Street, W1H
£850,000

Dexters



Harrowby Street, W1H

A two double bedroom apartment situated in a red brick residential block. Located moments from the boutiques, shops and restaurants of Portman and Connaught Villages and Hyde Park.

Located in Central London the property could suit either a homeowner or a buy to let investor. The building has a welcoming entrance lobby where a desk is staffed by a uniformed concierge team.

Conveniently located for the transport links of Marble Arch and London Marylebone. Hyde Park and Paddington Basin are easily accessible.

Features

- Two Double Bedrooms
- En Suite
- Uniformed Concierge
- Lift
- Lease 999 From 2002
- Chain Free



Harrowby Street, London, W1H

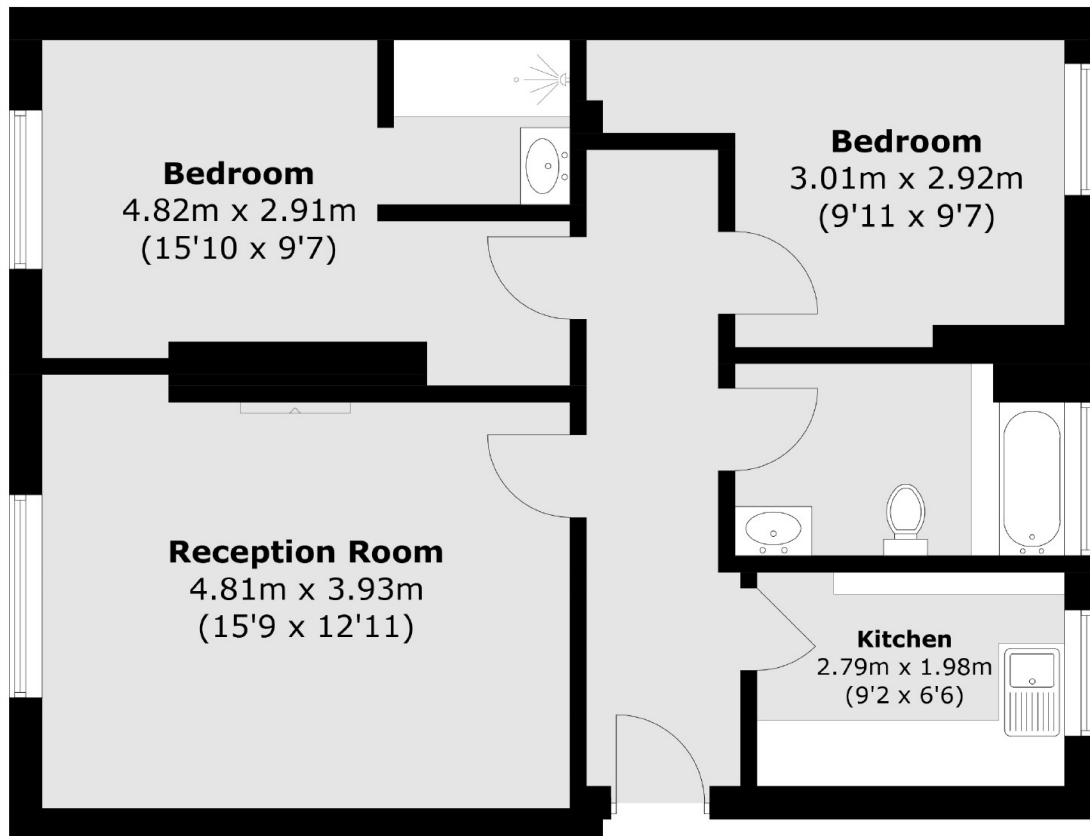

Total area (approx.): 64.3 sq. m (692.1 sq. ft)