

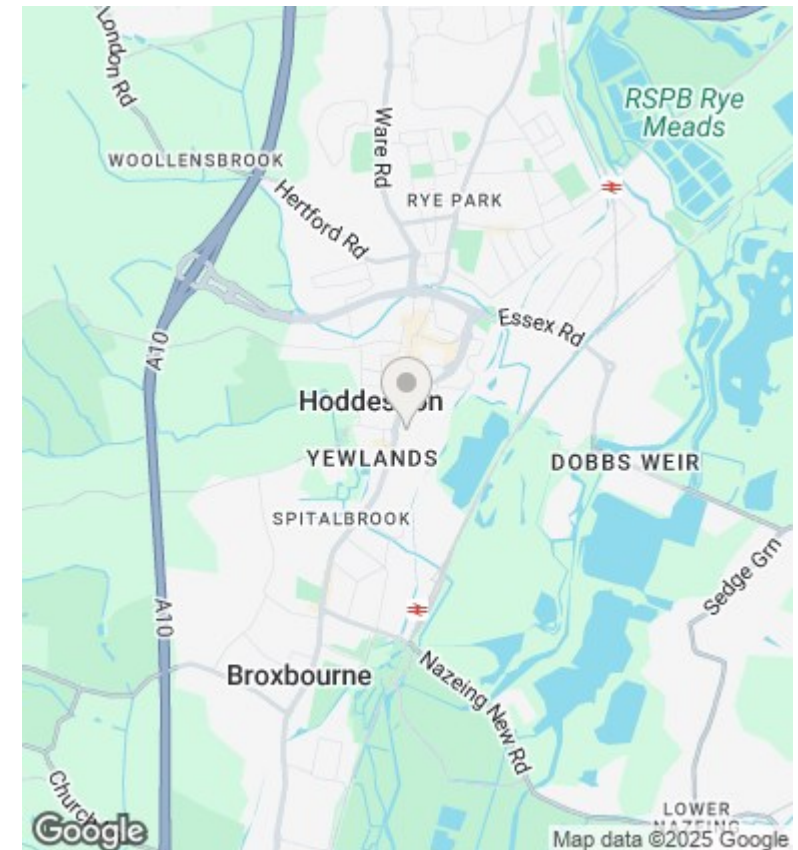

## 35 Woodgrange Court, Hoddesdon, Herts, EN11 8DQ

£1,150 PCM

- 1 BEDROOM APARTMENT CLOSE TOWN CENTRE
- PARKING UNDERGROUND
- BRAND NEW KITCHEN
- BRAND NEW BATHROOM
- NEWLY DECORATED THROUGHOUT
- BRAND NEW CARPETS
- BRAND NEW HEATING

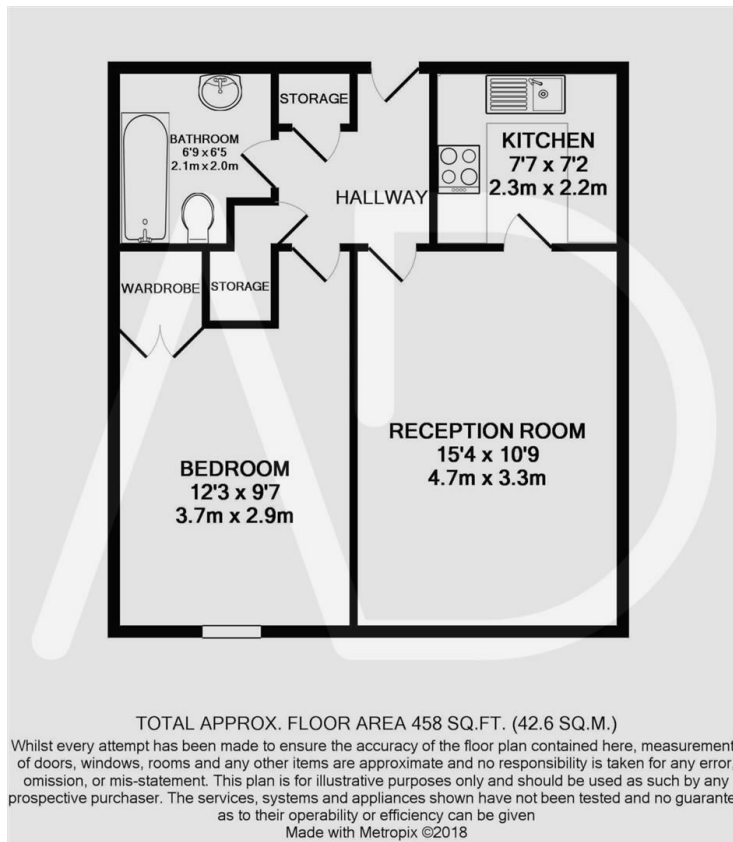

## Directions

## Viewings

Viewings by arrangement only. Call 01992 470335 to make an appointment.

## Council Tax Band

B

## EPC Rating:

E

Energy Efficiency Rating		
	Current	Potential
Very energy efficient - lower running costs		
(92 plus) <b>A</b>		
(81-91) <b>B</b>		81
(69-80) <b>C</b>		
(55-68) <b>D</b>		
(39-54) <b>E</b>	51	
(21-38) <b>F</b>		
(1-20) <b>G</b>		
Not energy efficient - higher running costs		
<b>England &amp; Wales</b>	EU Directive 2002/91/EC	