



11 WYBURN PLACE

AYR

www.corumproperty.co.uk





3 | BEDROOMS

2 | BATHROOMS

2 | PUBLIC ROOMS

A modern semi-detached villa providing well presented accommodation with gardens and detached garage within a quiet residential cul-de-sac.

Number 11 is a modern semi-detached villa presented in good decorative order and ideally suited to the family market. The property enjoys a corner position within a quiet cul-de-sac close to a wide range of amenities including Newton-on-Ayr railway station, shops and schooling.

Further features and benefits include a fitted kitchen, gas central with a 'Vaillant' boiler, double glazing and neutral decoration.

In summary the accommodation extends to, on the ground floor, a vestibule, reception hallway, open plan lounge/dining room and fitted kitchen. Upstairs there are three bedrooms (two with fitted wardrobe/cupboard space and a three piece bathroom.

Externally the front and side gardens are laid to lawn with shrubbery border and a driveway to the rear culminating in the detached garage. The fully enclosed rear garden is predominantly laid to decorative paving slabs.









Ground Floor

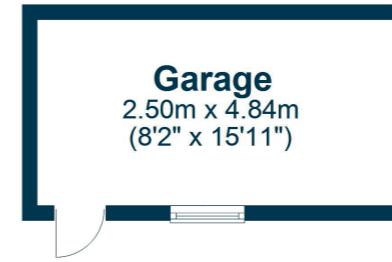

First Floor

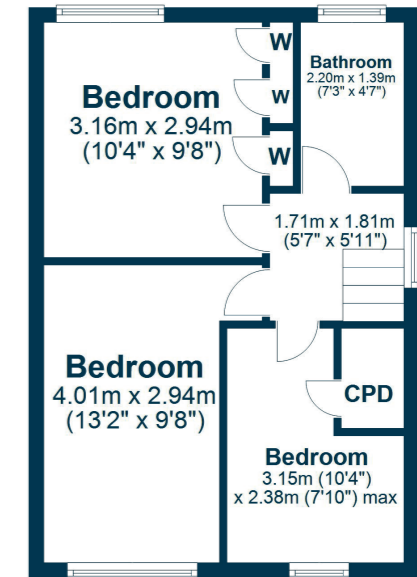
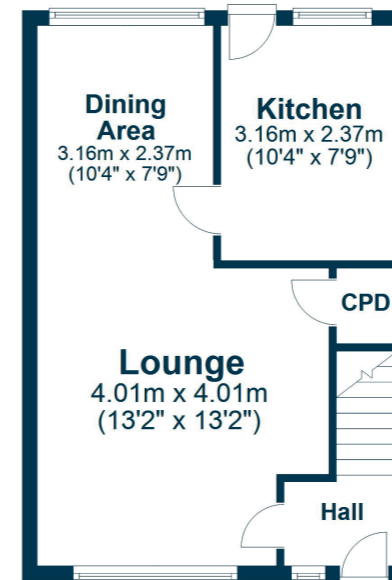

Wyburn Place is an extremely quiet residential cul-de-sac located in north Ayr within close proximity to Newton-on-Ayr railway station linking to Ayr and Glasgow and with excellent schooling nearby. Ayr town centre is around one mile distant and provides a comprehensive range of amenities including supermarket and retail shopping, transport and recreational facilities.

AY5394 | Sat Nav: 11 Wyburn Place, Ayr, KA8 9AY

For the full home report visit www.corumproperty.co.uk

* All measurements and distances are approximate Floorplans are for illustration purposes and may not be to scale.

WE'RE **SOLD** ON
YOUR FUTURE



c o r u m

Corum Ayr
10 Beresford Terrace, Ayr, KA7 2EG

Tel: 01292 880 888

Email: ayr@corumproperty.co.uk

www.corumproperty.co.uk