



63 ORANGEFIELD DRIVE
PRESTWICK

www.corumproperty.co.uk





2 | BEDROOMS

1 | BATHROOM

1 | PUBLIC ROOM

An immaculately presented family home with spacious accommodation, an open outlook across public green space, low maintenance garden grounds & set close to excellent schools within a quiet residential area of Prestwick.

Orangefield Drive is ideally positioned within walking distance of Prestwick Academy and excellent primary schools, the town centre, the seafront and first class transport links to surrounding districts. Number 63 is a beautifully presented mid terraced villa that offers a wealth of fantastic family accommodation that will suit a range of buyers. The property is thoroughly modern throughout and includes a luxury bathroom suite, a combi boiler powered heating system, gorgeous decor and quality fittings. This family home has a downstairs area open plan into the lounge, offering great flexibility within the internal living space. There are also low maintenance gardens to the front and landscaped gardens to the rear that complement the interior perfectly.

In more detail, the internal accommodation extends to an entrance hallway with stairs leading to the upper floor, a spacious lounge with under stairs storage and an open plan dining area, and a door leading through to the fitted kitchen with ample wall and base units. On the upper floor there is loft access, a fully tiled family bathroom suite and two large double bedrooms, both with fitted wardrobes and one with a wardrobe that also extends over the stairs.

Externally the gardens to the front are laid with decorative pebbles and paved pathways. The rear garden has a west facing aspect and has a mixture of lawn, paving, decorative shrub borders, fencing all around and a garden shed.







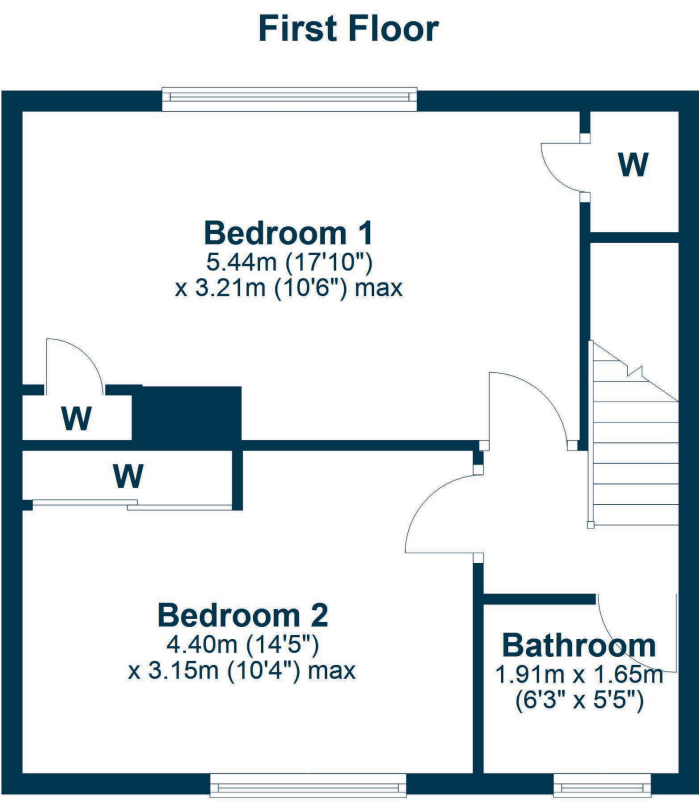
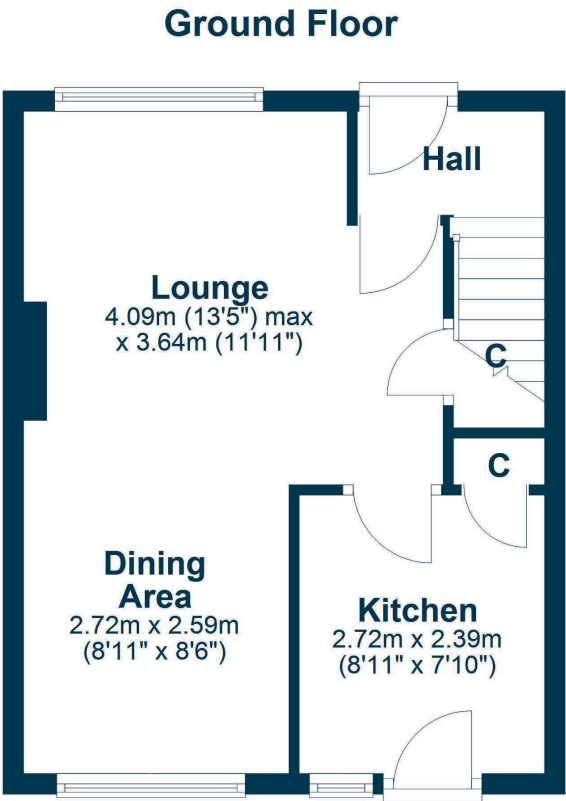

Orangefield Drive is a quiet residential address close to the centre of Prestwick, which provides a plethora of boutique shops, bars, and restaurants. In addition, there is first class road links to both Ayr and Glasgow and excellent primary and secondary schooling, Prestwick International Airport, and mainline rail links all within walking distance.

AY5173 | Sat Nav: 63 Orangefield Drive

For the full home report visit www.corumproperty.co.uk

* All measurements and distances are approximate Floorplans are for illustration purposes and may not be to scale.

WE'RE **SOLD** ON
YOUR FUTURE



Corum Ayr
10 Beresford Terrace, Ayr, KA7 2EG

Tel: 01292 880 888

Email: ayr@corumproperty.co.uk

www.corumproperty.co.uk