



3G MILTON WYND

TURNBERRY

www.corumproperty.co.uk





2 | BEDROOMS

2 | BATHROOMS

1 | PUBLIC ROOM

An immaculate modern first floor apartment providing spacious accommodation set within extensive and secluded, communal gardens with parking adjacent to the Trump Turnberry hotel and golf courses.

3G is a contemporary executive apartment, within the Abbotsford building, occupying a preferred first floor position with beautifully presented accommodation suited to a variety of potential purchasers. The property, which enjoys a particularly private position, has been comprehensively upgraded and modernised by the current owners and provides bright and spacious accommodation with an excellent level of fixture and finish throughout. The property has a short let license in place if required whilst being enjoyed as a primary residence currently.

Features and benefits include a modern fitted kitchen with integrated appliances, stylish three piece shower room and bespoke en-suite bathroom to the master bedroom, video security entry, generous cupboard and wardrobe space, double glazing, upgraded gas central heating with remote Wi-Fi controlled Hive thermostat, quality floor coverings and neutral decoration.

In summary the accommodation enjoys a shared reception hallway with lift and stair access to all apartments. Apartment 3G comprises a generous and welcoming reception hallway, spacious open plan lounge/dining room with a bright double aspect and balcony access to Ayrshire views, fitted kitchen and two double bedrooms including a master with en-suite bathroom. Completing the accommodation is a three piece shower room.

Externally the residents' gardens are predominantly laid to lawn with shrubbery, borders, mature plants and trees. Ample parking and discreet bin stores available onsite.







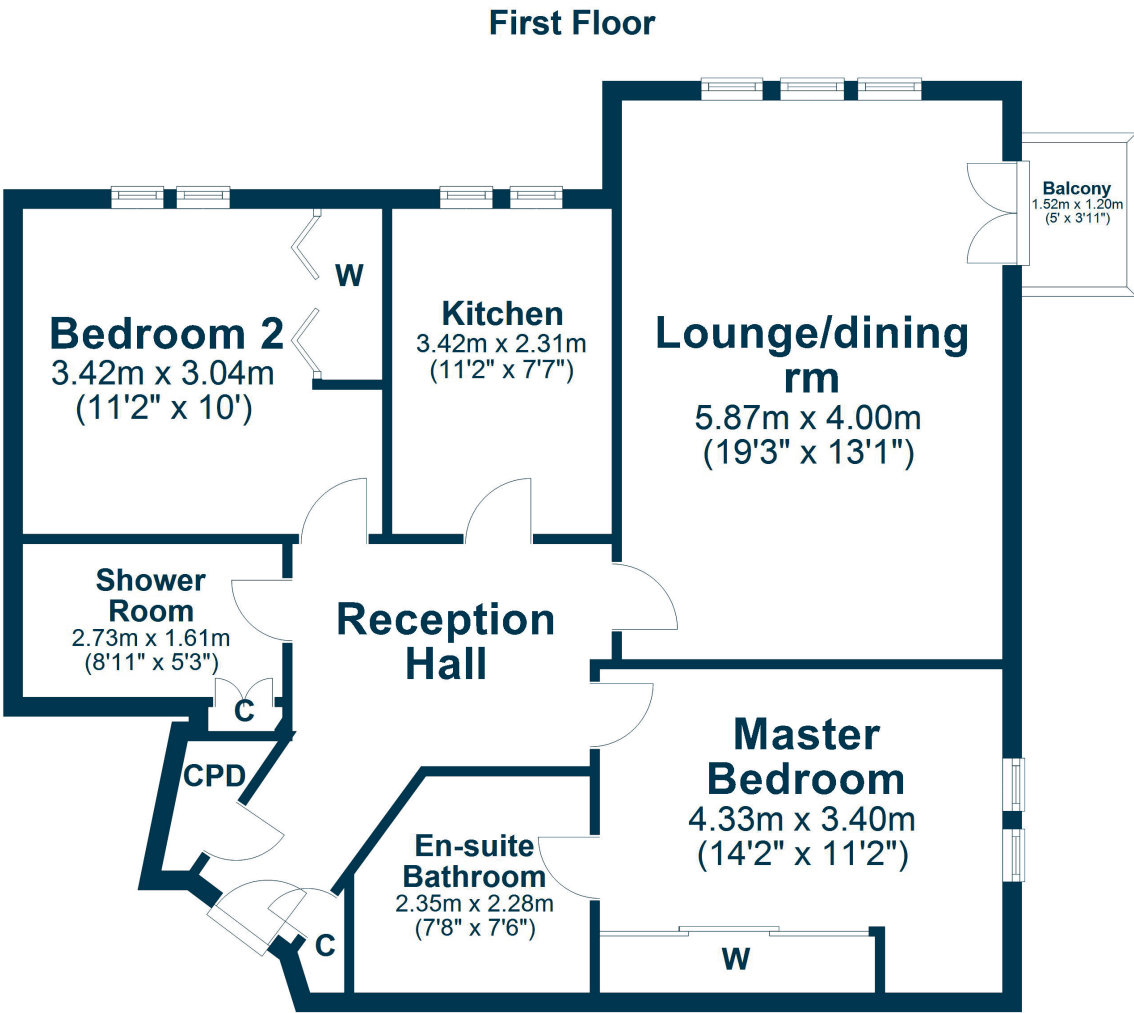

Turnberry is home to the world famous Trump Turnberry Hotel and Spa resort. The area abounds in sporting, cultural and leisure opportunities with Culzean Country Park, sailing, golf and fishing all available locally. The neighbouring village of Maidens with its picturesque fishing harbour is less than 2 miles away and has a highly-rated restaurant, coffee shop, grocer's and primary school. The town of Ayr is around 20 minutes drive and provides excellent transport links with Prestwick Airport close by and electrified train service to Glasgow and surrounding districts. Ayr is the foremost coastal town in southwest Scotland and offers all of the amenities one would expect including retail shopping, transport and recreational facilities. The A77/M77 road network provides swift commuting access to Glasgow City Centre and surrounding districts, while Prestwick International Airport offers enhanced services and regular flights to destinations throughout Europe.

AY5282 | Sat Nav: 3G Milton Wynd, Turnberry, KA26 9LG

For the full home report visit www.corumproperty.co.uk

* All measurements and distances are approximate Floorplans are for illustration purposes and may not be to scale.

WE'RE **SOLD** ON
YOUR FUTURE



Corum Ayr
10 Beresford Terrace, Ayr, KA7 2EG

Tel: 01292 880 888

Email: ayr@corumproperty.co.uk

www.corumproperty.co.uk