



**57 GLENALLA CRESCENT**

DOONFOOT

[www.corumproperty.co.uk](http://www.corumproperty.co.uk)

  
c o r u m





**4 | BEDROOMS**

**2 | BATHROOMS**

**3 | PUBLIC ROOMS**

**An impressive detached villa providing flexible accommodation of seven principle apartments formed across two levels with integral double garage and generous, private gardens.**

Number 57 is a modern detached villa particularly suited to the family market with spacious and flexible accommodation. Benefits of the property include a modern fitted kitchen with centre island, gas central heating, double glazing, neutral decor and good cupboard/wardrobe space.

The accommodation extends to, on the ground floor, a reception hallway, tiled cloaks/wc, front facing lounge with feature Limestone fireplace and double doors to the dining room, well proportioned conservatory overlooking the rear garden, fitted kitchen with useful utility room off and downstairs bedroom/study.

Upstairs there are three further bedrooms including a master with three piece en-suite shower room. Completing the accommodation is a three piece bathroom.

Externally the front garden is laid to lawn with chipped driveway parking providing space for several vehicles and culminating in the attached double garage (17' x 16'6 with twin doors (one automatic). In addition the garage has a courtesy door to the rear. The rear garden is extremely private and predominantly laid to lawn.















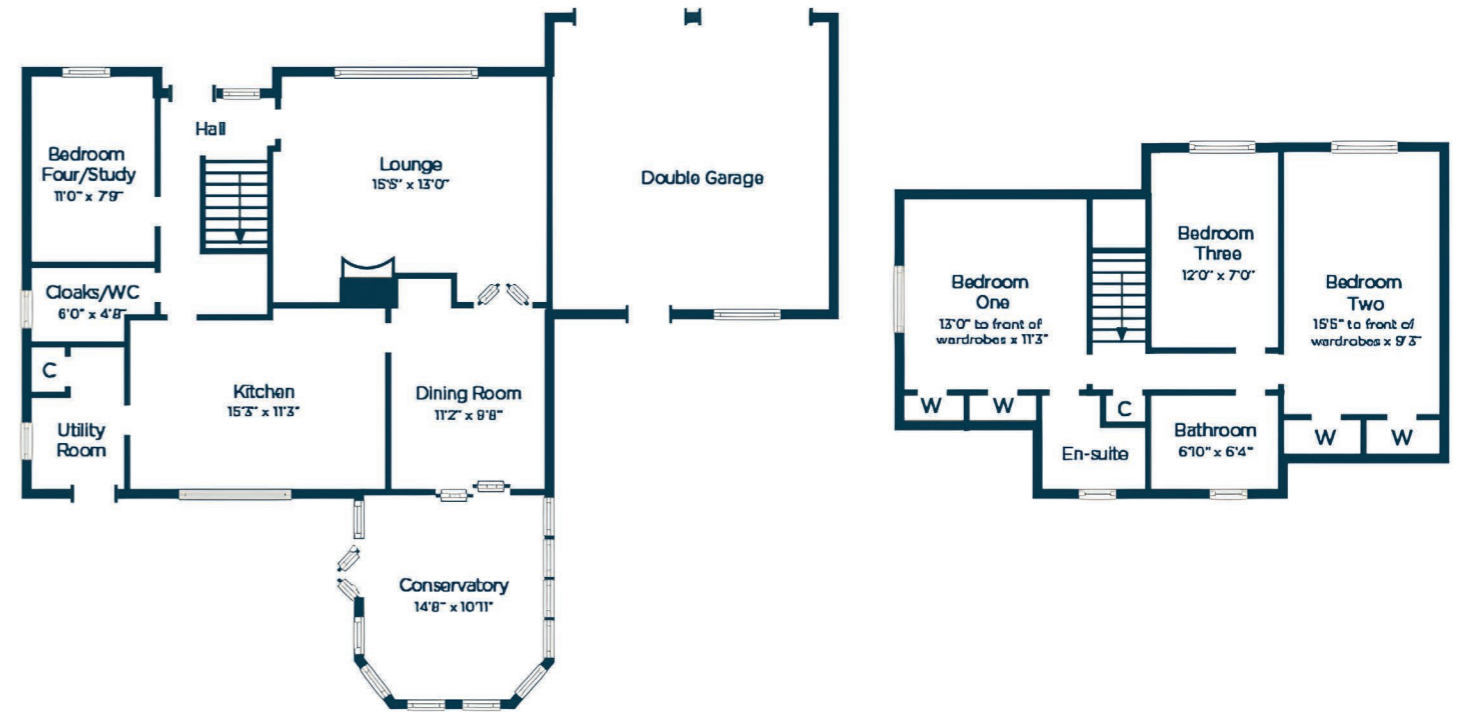

Glenalla Crescent is a truly picturesque and highly sought after residential address comprising of similarly styled villas and bungalow set in generous plots. The location is well placed for a wide range of amenities including the historic village of Alloway which is approximately 0.5 miles distant and provides amenities including primary school, village shop with Post Office, pharmacy and surgery.

**AY5037** | Sat Nav: 57 Glenalla Crescent, Doonfoot, KA7 4DA

For the full home report visit [www.corumproperty.co.uk](http://www.corumproperty.co.uk)

\* All measurements and distances are approximate Floorplans are for illustration purposes and may not be to scale.



WE'RE **SOLD** ON  
YOUR FUTURE



Corum Ayr  
10 Beresford Terrace, Ayr, KA7 2EG

**Tel:** 01292 880 888

**Email:** [ayr@corumproperty.co.uk](mailto:ayr@corumproperty.co.uk)

[www.corumproperty.co.uk](http://www.corumproperty.co.uk)