



19 SOUTHFIELD PARK

AYR

www.corumproperty.co.uk

c o r u m



3 | BEDROOMS

1 | BATHROOM

1 | PUBLIC ROOM

A well-presented and modern terraced family home nestled within the popular Belmont area of Ayr, with private gardens and ample resident's parking.

Southfield Park is located just a short walk from both Belmont Academy and the amenities of Ayr town centre, including transport links and retail shopping. Number 19 is a fantastic example of a mid terraced family villa that is presented to the market in good condition, with a tastefully decorated interior and a wealth of spacious accommodation and ample storage throughout. There are also enclosed low-maintenance gardens to the rear, a front garden and parking for both residents and visitors.

In more detail, the internal accommodation extends to an entrance hallway with stairs leading to the upper floor and a storage cupboard, a spacious lounge leading open plan to a dining area and a fitted dining kitchen with a large store and a door to the rear garden. On the upper floor there are two large double bedrooms, both with fitted wardrobes, a storage cupboard and loft access off the landing, a family bathroom suite and a single bedroom with a fitted wardrobe.

Externally there are gardens to the front, laid mainly with lawn, with paved pathways and the rear garden is fully enclosed, with gated access, a decked patio area, a garden shed and paving.

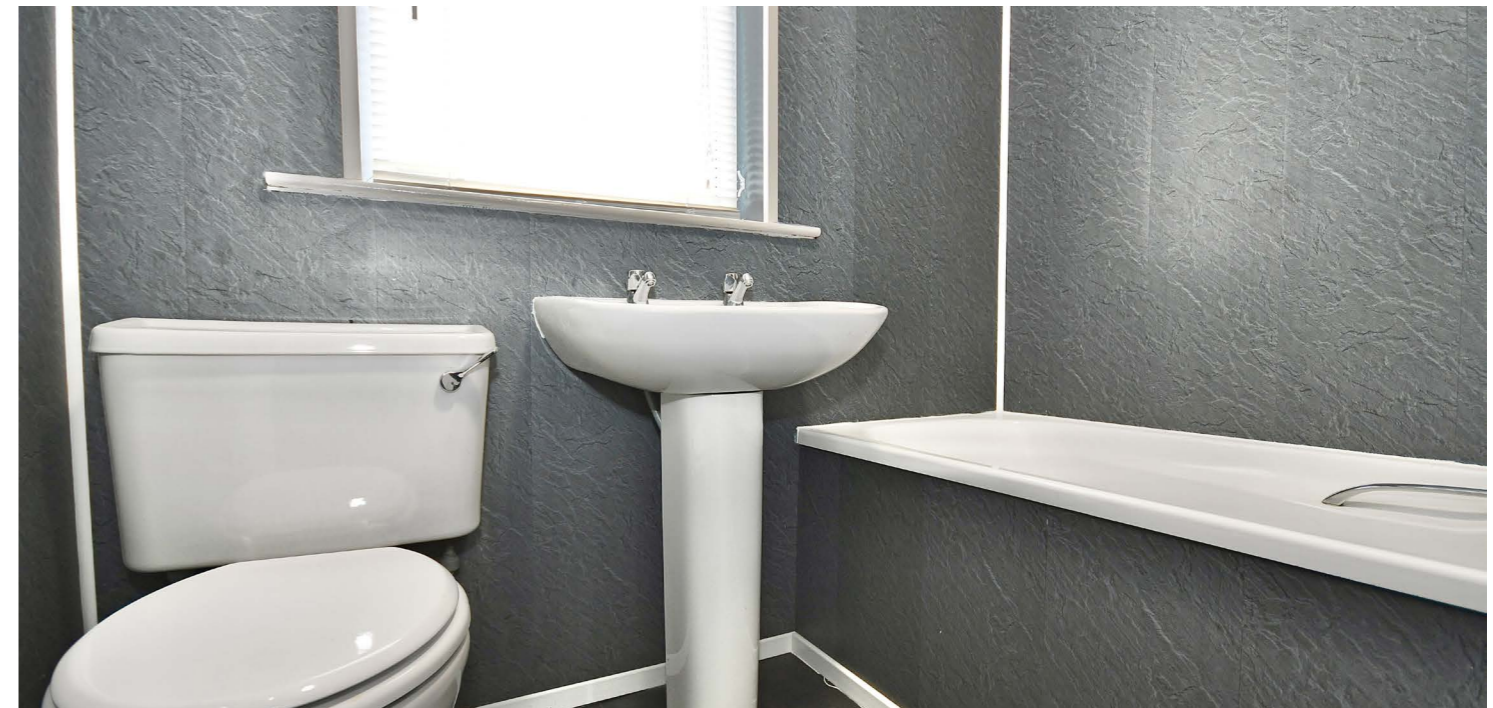

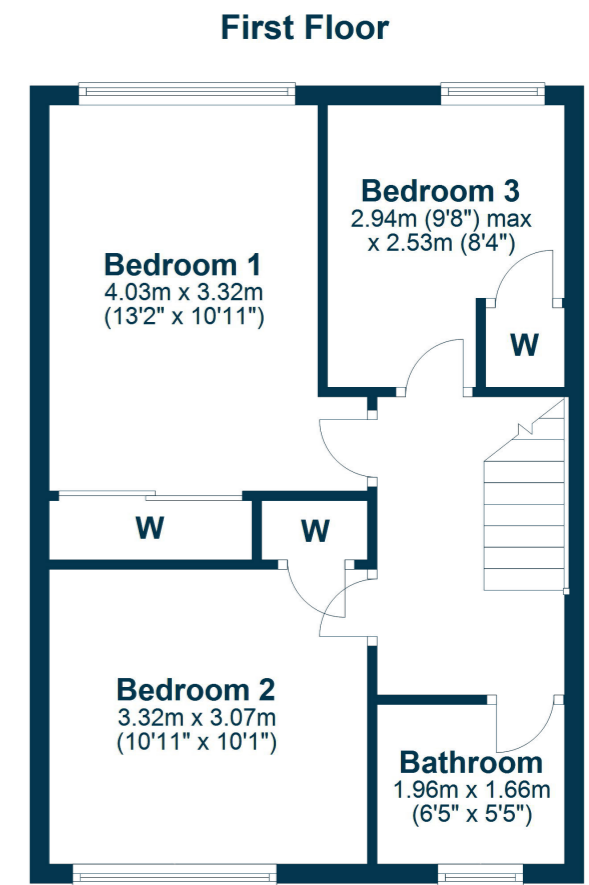
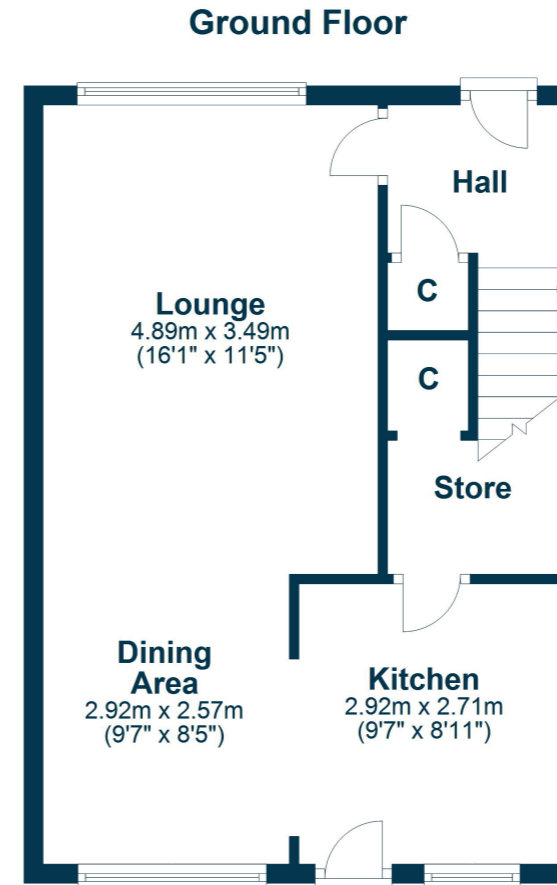

Southfield Park is a quiet residential address within the highly popular Belmont area. There are a number of local amenities including excellent schooling, while Ayr town centre is less than one mile distant and provides a more comprehensive range of amenities including supermarket and retail shopping.

AY4997 | Sat Nav: 19 Southfield Park, Ayr, KA7 2NU

For the full home report visit www.corumproperty.co.uk

* All measurements and distances are approximate Floorplans are for illustration purposes and may not be to scale.



WE'RE **SOLD** ON
YOUR FUTURE



Corum Ayr
10 Beresford Terrace, Ayr, KA7 2EG

Tel: 01292 880 888

Email: ayr@corumproperty.co.uk

www.corumproperty.co.uk