



2H VICTORIA PARK

AYR

www.corumproperty.co.uk





2 | BEDROOMS
1 | BATHROOMS
1 | PUBLIC ROOMS

A truly exceptional end terrace villa situated within the highly regarded Paddocks courtyard development by renowned local builders Lynch Homes.

Victoria Park is a charming tree-lined address set close to the seafront and the amenities of the town. Number 2H offers a rare opportunity to acquire a fabulous home with an enhanced and opulent level of specification combined with beautiful stylish decor. No expense has been spared in creating a sublime living space for a range of buyers and one that would serve all the requirements of those clients looking for a high quality base whilst travelling abroad.

In more detail, the internal accommodation extends to a spacious lounge with a feature fireplace, under stairs storage, a picture window out to the front and stairs leading to the upper floor, a luxury fitted breakfasting kitchen, a storage cupboard and a gorgeous downstairs shower room suite. On the upper floor there is a large double bedroom with fitted wardrobes and a door to the side, and a master bedroom suite with a walk-in wardrobe with access into the loft, fitted wardrobes and an en suite shower room.

Outside there are communal courtyard landscaped gardens, with monoblock paving, decorative plants and private parking with additional visitors spaces.



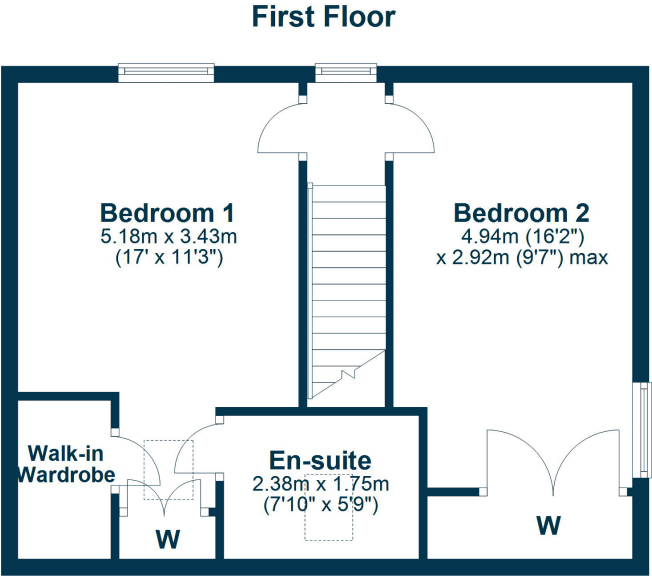
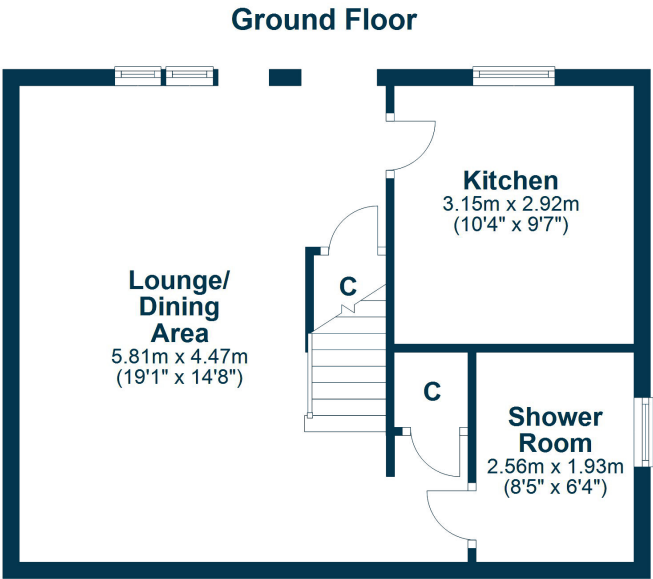

Victoria Park is a first class residential area located a short distance from the sea front and Ayr town centre. Here you will find a comprehensive range of retail shopping and recreational facilities. For the commuter there are excellent road and rail links to Glasgow.

AY4856 | Sat Nav: 2H Victoria Park, Ayr, KA7 2TR
For the full home report visit www.corumproperty.co.uk

* All measurements and distances are approximate Floorplans are for illustration purposes and may not be to scale.



WE'RE **SOLD** ON
YOUR FUTURE



Corum Ayr
10 Beresford Terrace, Ayr, KA7 2EG

Tel: 01292 880 888

Email: ayr@corumproperty.co.uk

www.corumproperty.co.uk