



The Hythe

Chickerell | Weymouth



The Hythe, Chickerell, Weymouth, Dorset DT3 4NE



Accommodation

This well-presented two-bedroom end of terrace house with garage is located in the popular setting of Chickerell, Weymouth. Entrance to the property is via the front door opening into the sitting room. A spacious room with front and smaller side aspect windows providing plenty of light. There is a modern gas fireplace offering a focal point and understairs storage cupboard. From the sitting room, a door opens into the kitchen/diner, a generous sized room with space for a table, rear aspect window and door opening into the rear garden. There is a selection of kitchen units providing plenty of storage, space for a range style cooker, washing machine and fridge/freezer.

From the sitting room, stairs rise to the first-floor landing with access to the remainder of the accommodation. Bedroom one is a good-sized double room with a cupboard over the stairs, front aspect window with open views and plenty of space for furniture. Bedroom two is a single bedroom with views over the rear garden. The modern bathroom offers a bath with shower over, low level WC and wash hand basin.



Outside

The rear garden is accessed from the kitchen/diner, fully enclosed and a generous size. There is a raised decking area abutting the property and patio area to the side. The remainder of the garden is laid to lawn with a path leading to the rear access gate to the off-road parking space. There is also access to the single garage with up and over door. The garage also offers eaves storage.

- Two Bedroom End of Terrace House
- Garage and Allocated Off Road Parking
- Well-Presented Through-out
- Kitchen/Diner
- Generous Garden

Location

Located close the heart of Chickerell, a peaceful coastal small town located next to the Fleet, the largest natural inlet of sea water in England. Chickerell itself has a local shop, two public houses, a restaurant, chemist, and post office. Nearby supermarket and industry shopping units include fast food and coffee shop units. There are lots of scenic coastal walks and links to the Southwest Coast path. A short drive away is Weymouth, a Georgian seaside resort with award winning sandy beach and town centre with a good range of high street names and quirky boutiques in the adjacent lanes as well as pubs, restaurants and cafes.

Directions

Coming into Weymouth on the A354 (Weymouth Way) at the first roundabout turn right (signposted B3157 Chickerell). At the next roundabout take the second exit and straight over at the next set of traffic lights. At the end of the road at the next set of lights turn right (signposted B3157 Abbotsbury). Follow the road and take the first right into Glennie Way, continue along and take the second left into Drake Avenue then first right into The Hythe. The property can be found a little way down on the left hand side.

Rating Authority

Dorset (Weymouth & Portland) Council. Council Tax Band B.

Services

Gas central heating. Mains electric & drainage.

Viewing Arrangements

Strictly by appointment through Avenue Sales & Lettings.

Telephone 01305 830022 or email info@avenuesalesandlettings.co.uk

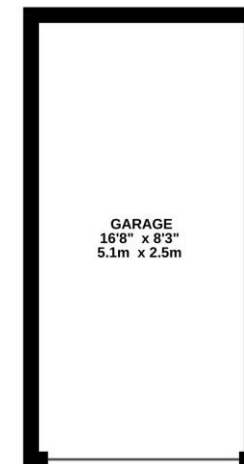
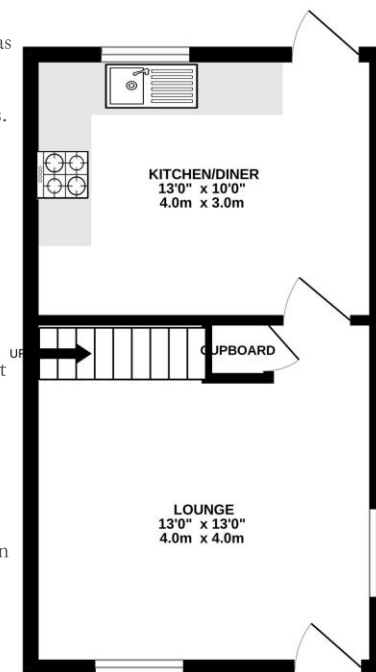
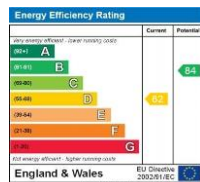

IMPORTANT: we would like to inform prospective purchasers that these sales particulars have been prepared as a general guide only. A detailed survey has not been carried out, nor the services, appliances and fittings tested. Room sizes should not be relied upon for furnishing purposes and are approximate. If floor plans are included, they are for guidance only and illustration purposes only and may not be to scale. If there are any important matters likely to affect your decision to buy, please contact us before viewing the property.