

Trusted since 1802
HENLEY-ON-THAMES | MARLOW | BASINGSTOKE

SIMMONS & SONS



Spring Gardens, Marlow

Guide Price £630,000

Extended and modernised mid-terrace house with no onward chain

Freehold

30 Spring Gardens, Marlow, SL7 3HS

- Spacious lounge with bay window and decorative fireplace
- Modern open plan kitchen/dining/living room
- Three bedrooms & family bathroom
- All windows and flooring newly fitted
- Low maintenance front and rear gardens
- 0.3 miles level walk to the top of Marlow High Street
- Selection of fantastic local schools for all ages
- Double garage with parking, gym area and car charger
- Gas central heating and additional under floor heating in the kitchen area



Located in the popular Spring Gardens, Marlow, this beautifully extended mid-terrace house has been thoughtfully modernised throughout in 2024, offering a perfect blend of stylish living and functional design. A welcoming front porch provides the ideal space to hang coats and store shoes, ensuring a neat and organised entrance. Step inside to discover a spacious, inviting lounge complete with a charming bay window and decorative fireplace, offering a cosy retreat for relaxing or entertaining guests. To the rear, the heart of the home awaits: a contemporary open plan kitchen, dining, and living area. Vaulted ceilings, Velux windows, and full-width bi-fold doors flood the space with natural light and create a seamless connection to the rear garden. The kitchen itself features a host of modern fittings, complemented by the luxurious touch of underfloor heating. Upstairs, three bedrooms and family bathroom provide comfortable accommodation for the whole family. Every aspect of this home has been finished to a high standard, with tasteful details and premium accessories throughout. Parking is effortless, thanks to a double garage to the rear of the property-completely rebuilt in 2024-which offers secure parking for one car, a dedicated home gym area, and is equipped with a 7kWh EV charger. The property is offered with no onward chain.



Exterior

To the front of the property there is a paved path leading to the front door and low maintenance shingled area. To the rear of the property it has been designed for low maintenance also and has a patio area, shingled area and path leading to the garage all enclosed by timber fencing. There is also outside power points and tap.

Situation

Marlow is a charming and historic town set in the banks of the River Thames and is surrounded by beautiful countryside. It is a perfect place for enjoying the river, shopping with a difference, walking around historical buildings or taking part in the many sports and recreational activities available within the local area. The railway station in Marlow provides access to London (Elizabeth Line and GWR) and access to the M4 and M40 is within a short drive. Excellent schools for children of all ages are available in Marlow and surrounding districts.



Services

Heating: Gas fired hot water radiators
Water: Mains Supply
Sewerage: Mains Supply

Agent's note - Pictures were taken in Jan 2025 before tenants moved in.

Local Authority - Buckinghamshire Council

Council Tax Band - D

Energy Performance Rating - C75

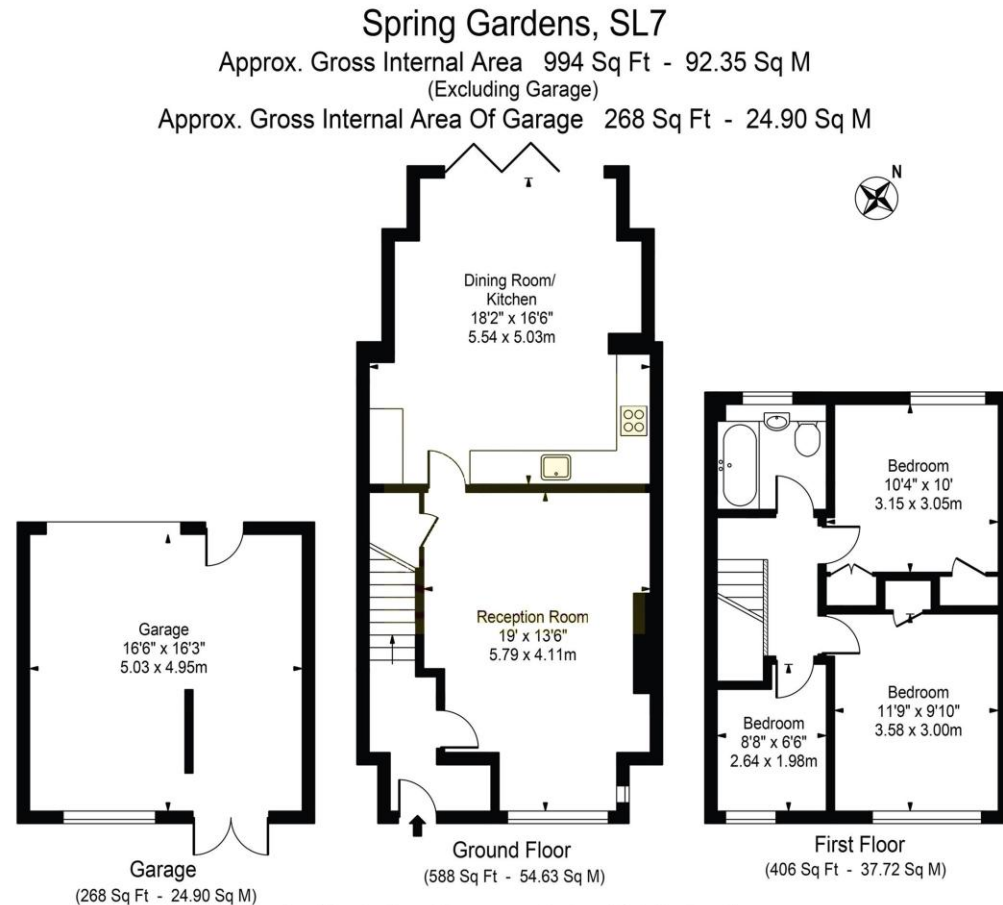

For Illustration Purposes Only - Not To Scale

This floor plan should be used as a general outline for guidance only and does not constitute in whole or in part an offer or contract.
Any intending purchaser or lessee should satisfy themselves by inspection, searches, enquiries and full survey as to the correctness of each statement.
Any areas, measurements or distances quoted are approximate and should not be used to value a property or be the basis of any sale or let.

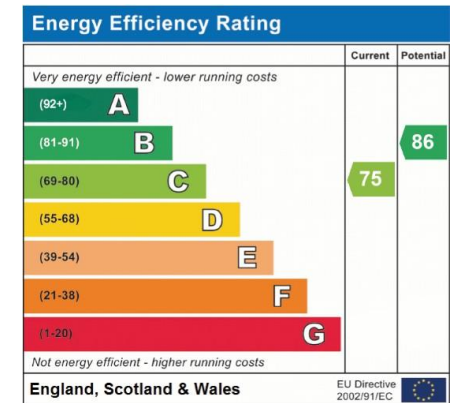

VIEWINGS - Strictly by appointment only
with Simmons & Sons - Marlow Sales

T: 01628 484353

E: marlowsales@simmonsandsons.com

W: <http://www.simmonsandsons.com>

Simmons & Sons Surveyors LLP for themselves and for the vendors or lessors of the property whose agents they are give notice that: (i) the particulars are produced in good faith, are set out as a general guide only and do not constitute any part of a contract or offer; (ii) all descriptions, dimensions, references to condition and necessary permissions for use and occupation, and any other details are given in good faith and are believed to be correct, but any intending purchasers or tenants should not rely on them as statements or representations of fact but must satisfy themselves by inspection or otherwise as to the correctness of each of them; (iii) No person in the employment of Simmons & Sons has any authority to make or give any representation or warranty whatsoever in relation to this property.

Sales

Lettings & Management

Commercial

Development

Rural

32 Bell Street
Henley-on-Thames
Oxon
RG9 2BH
T: 01491 571111

1 High Street
Marlow
Bucks
SL7 1AX
T: 01628 484353

12 Wote Street
Basingstoke
Hants
RG21 7NW
T: 01256 327711

Peper Harow
The Estate Office
Godalming
GU8 6BQ
T: 01483 418151

SIMMONS & SONS