



**HUNTERS**<sup>®</sup>  
HERE TO GET *you* THERE

Wiltshire Road, Wokingham, Berkshire , RG40

# Wiltshire Road, Wokingham, Berkshire , RG40

Per Calendar Month: £1,000.00

This delightful ground floor maisonette is conveniently located just a stone's throw away from Wokingham town centre. With the train station just a short walk away, along with local shops and restaurants all on your doorstep.

Located on the ground floor the property benefits from a lovely spacious living/dining room and a separate kitchen. This apartment offers two double bedrooms and a modern three piece shower bathroom suite.

The property benefits from off-road parking for one vehicle

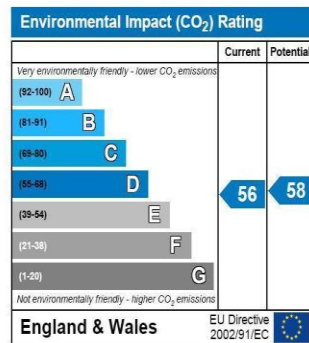
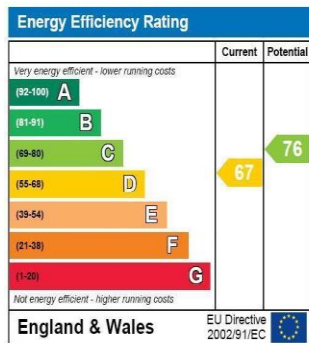

## ENERGY PERFORMANCE CERTIFICATE

The energy efficiency rating is a measure of the overall efficiency of a home. The higher the rating the more energy efficient the home is and the lower the fuel bills will be.

Hunters 43C Peach Street, Wokingham, RG40 1XJ | 0118 979 5618  
wokingham@hunters.com | www.hunters.com

VAT Reg. No 337 8387 59 | Registered No: 12191593 England and Wales | Registered Office: Flat 19 Old Bath Road, Charvil, Reading, RG10 9QB  
A Hunters Franchise owned and operated under licence by L & E Property Ltd t/a Hunters Wokingham





## **FRONT**

### **VIEWING ARRANGEMENTS**

By Appointment With: Hunters

Tel: 0118 979 5618

### **OPENING HOURS:**

Monday - Thursday: 08.30 - 18:00

Friday: 08.30 - 18:00

Saturday: 09:00 - 17:00

### **DISCLAIMER**

These particulars are intended to give a fair and reliable description of the property but no responsibility for any inaccuracy or error can be accepted and do not constitute an offer or contract. We have not tested any services or appliances (including central heating if fitted) referred to in these particulars and the purchasers are advised to satisfy themselves as to the working order and condition. If a property is unoccupied at any time there may be reconnection charges for any switched off/disconnected or drained services or appliances - All measurements are approximate.

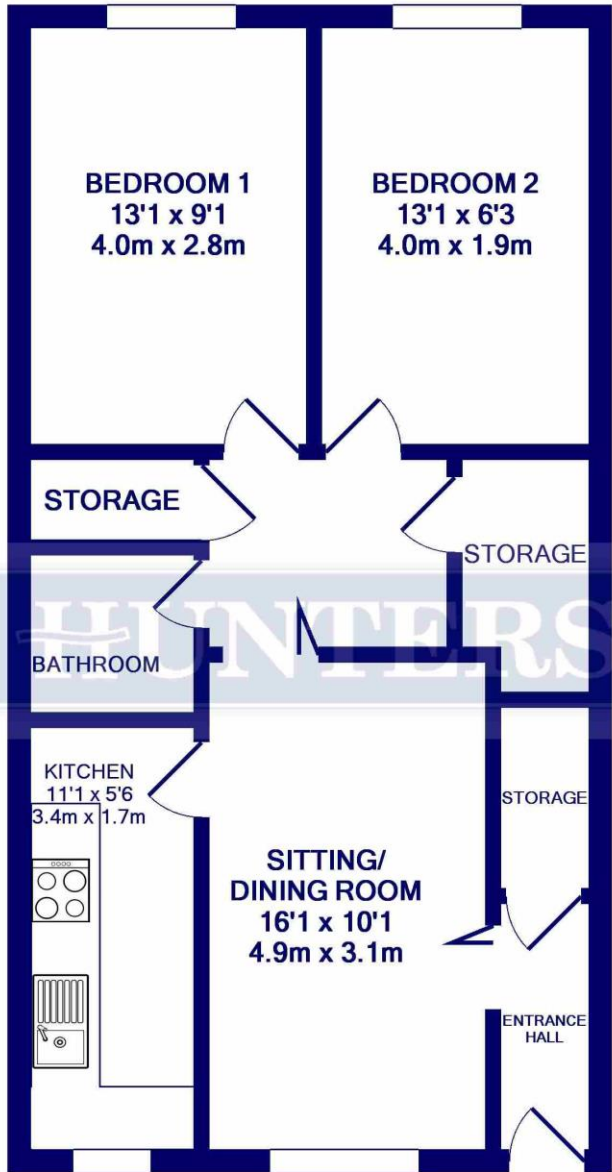

TOTAL APPROX. FLOOR AREA 623 SQ.FT. (57.8 SQ.M.)  
Measurements are approximate. Not to scale. Illustrative purposes only  
Made with Metropix ©2018





«Picture6»



«Picture7»

«Picture8»