

HUNTERS®

HERE TO GET *you* THERE

39 Coppice Road, Woodley, RG5 3RA

£2,000

Property Images



HUNTERS[®]

HERE TO GET *you* THERE

Property Images



HUNTERS[®]

HERE TO GET *you* THERE

Property Images



HUNTERS®

HERE TO GET *you* THERE

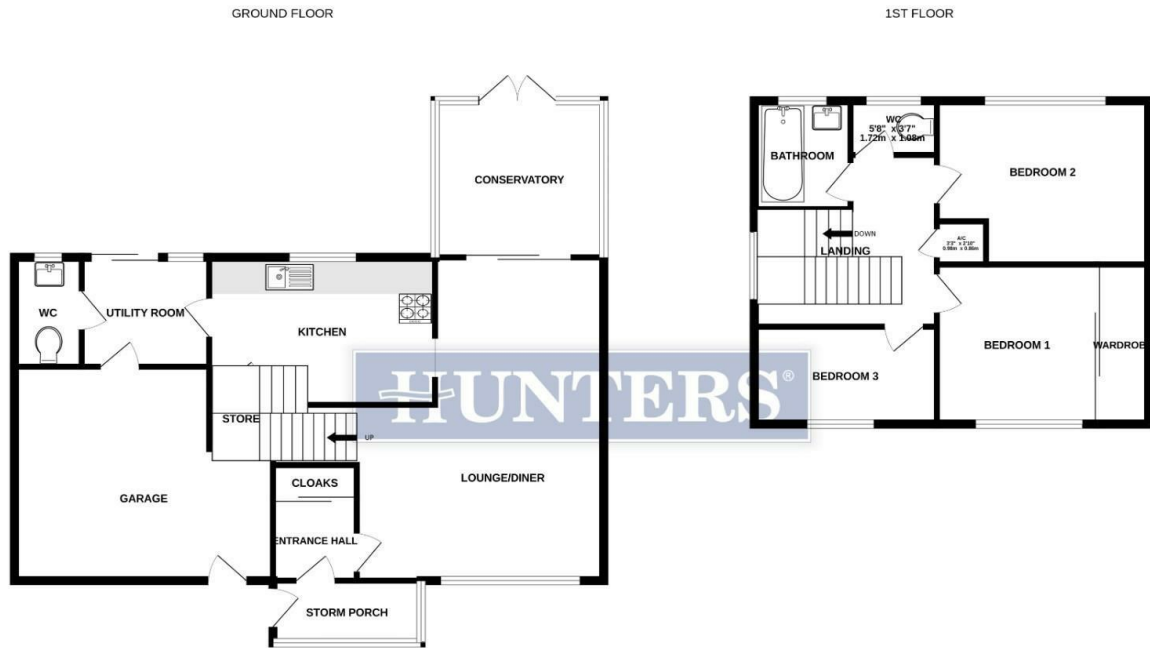

Measurements are approximate. Not to scale. Illustrative purposes only. Made with Metropix ©2024

EPC

Energy Efficiency Rating		Current	Potential
<i>Very energy efficient - lower running costs</i>			
(92 plus) A			
(81-91) B			81
(69-80) C			
(55-68) D		61	
(39-54) E			
(21-38) F			
(1-20) G			
<i>Not energy efficient - higher running costs</i>			
England & Wales	EU Directive 2002/91/EC		

Map

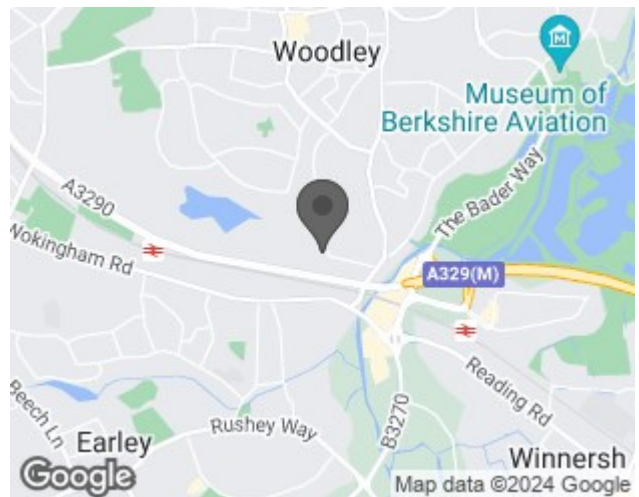

Details

Type: House - Detached Beds: 3 Bathrooms: 1 Receptions: 1 Tenure:

Summary

Welcome to this charming detached house located on Coppice Road in the lovely area of Woodley. This property boasts a spacious living room, perfect for relaxing with family and friends. The separate kitchen offers a great space for cooking up delicious meals and entertaining guests, conservatory and a separate utility room. Upstairs the property offers three good size bedroom and and a family bathroom

The property also features a garage, providing convenient storage space or parking for your vehicle.

The location is great for the commuter as the A329M and M4 are within five minutes drive. Woodley shopping precinct is within a fifteen minute walk which has a great range of shops including Lidl, Waitrose, Iceland, Boots and a selection of bars, take aways and restaurants. There is a regular bus service nearby to Reading, Wokingham and Bracknell. The mainline railway stations of Earley and Winnersh triangle are both within walking distance which connect Reading and London Waterloo (change at Reading for London Paddington) .

Features

- Detached House • Three double bedrooms • Good size living room • Separate kitchen • Conservatory • Utility room • Family bathroom • WC • Garage and driveway • Available now