

BRUCE MATHER

INDEPENDENT ESTATE AGENT



Low Road, Boston, PE21 7AS

Price Guide £379,500

A deceptively large four bedroom, three reception room, detached house in good condition, in a sought after edge of village location. Pictures do no justice to how much space is on offer here. The drive leads you to a well manicured garden, a double garage and the house which measures nearly 3000 sq ft, inside there is an abundance of space with four double bedrooms, three bathrooms, modern kitchen, utility, study, two reception room and a sun room. There is the potential to have guest/elderly part downstairs. Outside the beautifully maintained garden wraps around the house with grass and beds, pergolas and sheds for the keen gardener. Wyberton lies a couple of miles south of Boston for all your shopping and services. Please call Bruce Mather on 01205365032 to arrange a viewing.

Floor Plan

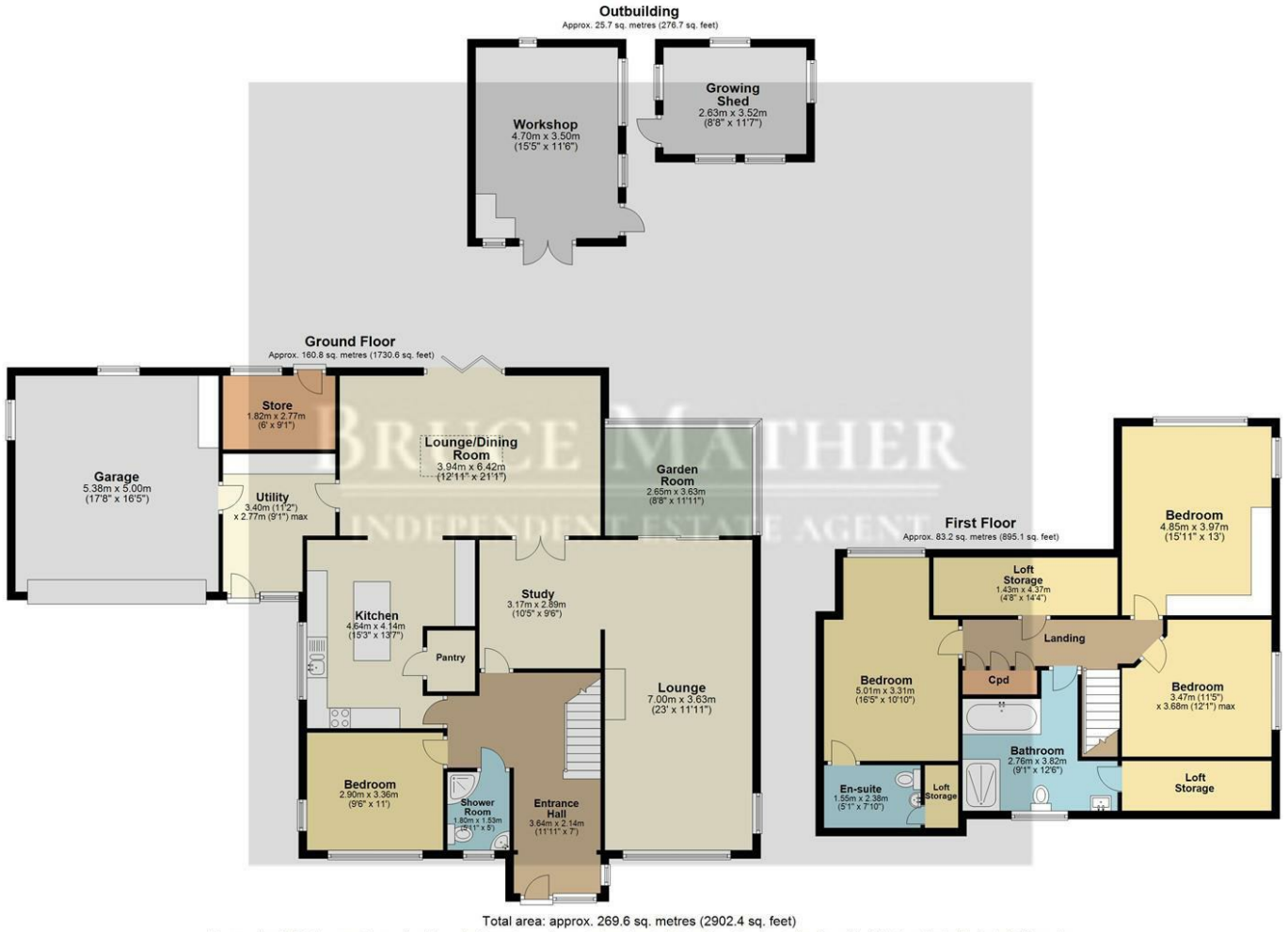

All images used are for illustrative purposes. Images are for guidance only and may not necessarily represent a true and accurate depiction of the condition of property. Floor plans are intended to give an indication of the layout only. All images, floor plans and dimensions are not intended to form part any contract.
Plan produced using PlanUp.

Area Map

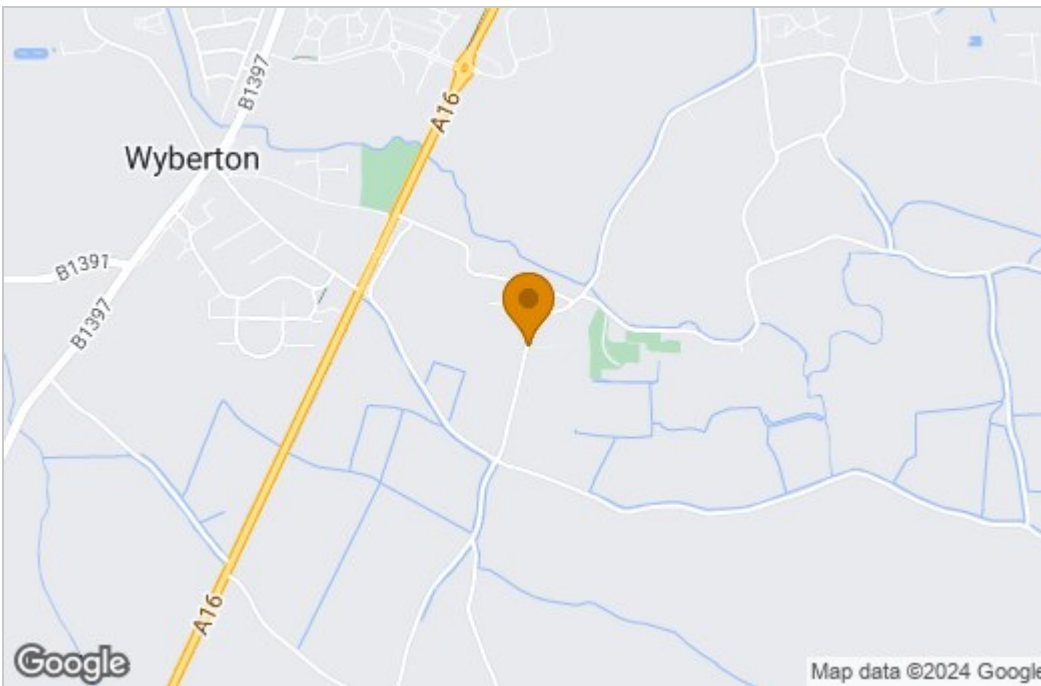

Energy Efficiency Graph

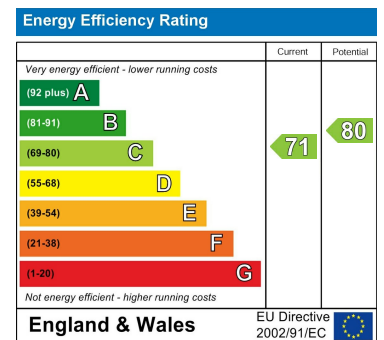

These particulars, whilst believed to be accurate are set out as a general outline only for guidance and do not constitute any part of an offer or contract. Intending purchasers should not rely on them as statements of representation of fact, but must satisfy themselves by inspection or otherwise as to their accuracy. No person in this firm's employment has the authority to make or give any representation or warranty in respect of the property.