

PRICE
£375,000

Freehold



**BRAND NEW 2 BED DETACHED
BUNGALOW UNDER CONSTRUCTION
WITH UNDERFLOOR HEATING AND A
PRIVATE DRIVEWAY!**

**Minster Road, Minster
ME12 3NR**



www.ruleandrule.co.uk
independent estate agents

 PrimeLocation.com
Find the home you deserve

 Zoopla
Smarter property search

 rightmove

 THE GUILD
PROPERTY
PROFESSIONALS

www.ruleandrule.co.uk | facebook.com/ruleandrule | T: 01795 662604



ESTAS
 ★★★★★
 ESTATE AGENT AWARDS 2022
BEST AGENCY NETWORK
 (RATED BY CUSTOMERS)
 The Guild of Property Professionals

BRAND NEW BUNGALOW ACCESSED VIA A PRIVATE DRIVEWAY!

Need to be close to local amenities? Look no further than this brand new 2 bed detached bungalow situated in the heart of Minster close to shops, schools and seafront.

Built by a reputable local builder, this compact bungalow will offer gas fired central heating, upvc double glazing, fitted kitchen and white bathroom suite. Outside, the property will be landscaped with off street parking.

This ideally located bungalow will be snapped up fast so don't delay in contacting us for full plans and specification.

EPC TO FOLLOW SOON

GROUND FLOOR
 735 sq.ft. (68.3 sq.m.) approx.

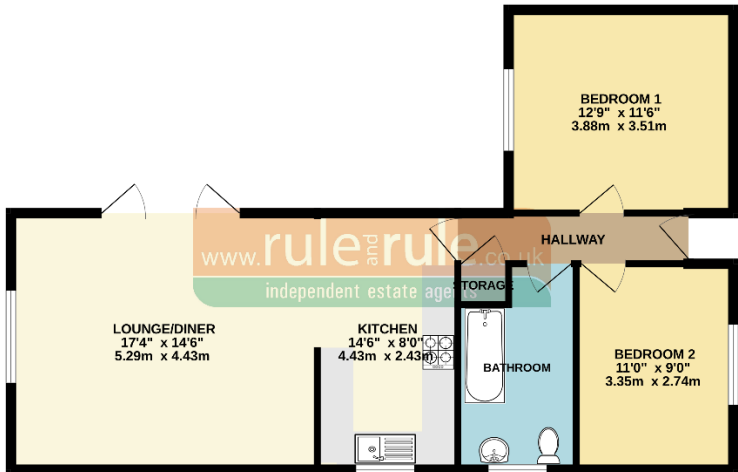

TOTAL FLOOR AREA - 735 sq.ft. (68.3 sq.m.) approx.
 While every attempt has been made to ensure the accuracy of the floorplan contained herein, measurements of doors, windows, rooms and any other items are approximate and no responsibility is taken for any errors, omissions or mis-statements. This plan is for illustrative purposes only and should be used as such by any prospective purchaser. The services, systems and appliances shown have not been tested and no guarantee as to their operability or efficiency can be given.
 Made with Metapic 1/2022

MONEY LAUNDERING REGULATIONS 2007: Intending purchasers will be asked to produce identification and proof of financial status when an offer is received. We would ask for your co-operation in order that there will be no delay in agreeing the sale. **THE PROPERTY MISDESCRIPTIONS ACT 1991 - Rule and Rule** has not tested any apparatus, equipment, fixtures and fittings or services and so cannot verify that they are in working order or fit for the purpose. A Buyer is advised to obtain verification from their Solicitor or Surveyor. References to the Tenure of a Property are based on information supplied by the Seller. Rule and Rule has not had sight of the title documents. A Buyer is advised to obtain verification from their Solicitor. You are advised to check the availability of this property before travelling any distance to view. We have taken every precaution to ensure that these details are accurate and not misleading. If there is any point which is of particular importance to you, please contact us and we will provide any information you require. This is advisable, particularly if you intend to travel some distance to view the property. The mention of any appliances and services within these details does not imply that they are in full and efficient working order. These particulars are in draft form awaiting Vendors confirmation of their accuracy. These details must therefore be taken as a guide only and approved details should be requested from the agents. Covenants may apply to this property.