







A spacious four double bedroomed chalet bungalow enjoying generous proportions and beautiful views throughout, just a short walk to the village centre and the golden sandy beaches of Outer and Inner Hope

- **Spacious detached bungalow**
- **Beautiful far reaching views**
- **Popular coastal location**
- **Short walk to the beach**
- **Single garage and workshop**
- **Four bedrooms**
- **Three bathrooms**
- **Large south facing sun terrace**
- **Light and airy throughout**
- **Versatile accommodation**
- **EPC E**

Anchorsholme

Grand View Road, Hope Cove, TQ7 3HE

A fantastic, four double bedroomed detached bungalow situated on the popular Grand View Road within the charming fishing village of Hope Cove. Just a short distance from the property is the South West Coast path taking you straight down into the village and the sandy beaches of Outer and Inner Hope offering miles of trails and beautiful scenery to explore.

Sitting centrally on a large plot, Anchorsholme enjoys a wonderful southerly aspect with beautiful rural and coastal views across the village and towards Bolt Tail. The living accommodation flows seamlessly between the kitchen, dining room and lounge all with charming outlooks over the front and rear gardens and beyond. There is also the benefit of two double bedrooms, one with en suite bathroom together with an additional shower room on the ground floor. Stairs ascend from the large entrance hallway to the first floor offering two further bedrooms boasting beautiful views and bathroom as well as ample eaves storage.

To the rear the property enjoys a large, gently sloping lawn wrapping around to a spacious south facing sun terrace providing the perfect spot for relaxing after a long day on the beach. The property also has the benefit of off road parking, a single garage and two additional storage rooms which could be used as a workshop or for kayaks and paddleboards.



2 Island Square, Island Street, Salcombe, Devon,
TQ8 8DP

Telephone 01548 843593

salcombe@luscombemaye.com
www.luscombemaye.com



Anchorsholme, Grand View Road, Hope Cove, Kingsbridge, TQ7 3HE

Approximate Gross Internal Floor Area = 156.6 sq m / 1687 sq ft
Garage Area = 28.0 sq m / 302 sq ft
Total Area = 184.7 sq m / 1988 sq ft

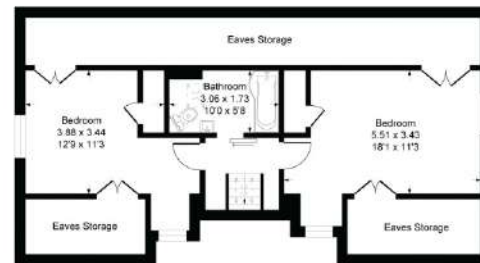

First Floor



Garage

Ground Floor

Illustration for identification purposes only, measurements are approximate, not to scale.

SERVICES: Mains electricity, water and drainage. Oil fired central heating.

COUNCIL TAX & LOCAL AUTHORITY: South Hams District Council, Follaton House, Plymouth Road, Totnes, TQ9 5NE. Tel 01803 861234

TENURE: Freehold

VIEWINGS: Strictly by appointment with Luscombe Maye, Salcombe. Tel: 01548 845 090.

DIRECTIONS: On the A381 from Kingsbridge drive for roughly 2 miles and turn right at the sign post for Hope Cove and continue through the hamlet of Galmpton. As you approach Hope Cove turn right into Weymouth Park and turn immediately left on to Grand View Road. Continue along Grand View Road and the property is situated about 3/4 of the way along on the right hand side.

Please scan the QR Code for further Material Information:

