

Cotterells

, Hemel Hempstead, HP1 1AQ

Offered with the benefit of NO UPPER CHAIN is this purpose built flat. Boasting two bedrooms, 19'8 open plan living room/kitchen, gas central heating, double glazing and allocated parking. Situated in the town centre and close to the local shops, schools, the M1, M25 and A41 road links and within easy reach of Hemel Hempstead train station with services to London Euston.

£250,000

Gade Place Cotterells

, Hemel Hempstead, HP1 1AQ



- Town Centre Location
- Purpose Built Flat
- Two Bedrooms
- 19'8 Open Plan Lounge/Kitchen
- Gas Central Heating
- Double Glazing
- Allocated Parking
- No Upper Chain

Communal Hallway

Entrance Hallway

Open Plan Lounge/Kitchen

19'8 x 12'3 (5.99m x 3.73m)

Kitchen

Bedroom One

12'1 x 11'0 (3.68m x 3.35m)

Bedroom Two

11'5 x 6'10 (3.48m x 2.08m)

Bathroom

Allocated Parking



Energy Efficiency Rating		
	Current	Potential
Very energy efficient - lower running costs		
(92 plus) A		
(81-91) B	80	82
(69-80) C		
(55-68) D		
(39-54) E		
(21-38) F		
(1-20) G		
Not energy efficient - higher running costs		
England & Wales	EU Directive 2002/91/EC	



Floor Plan

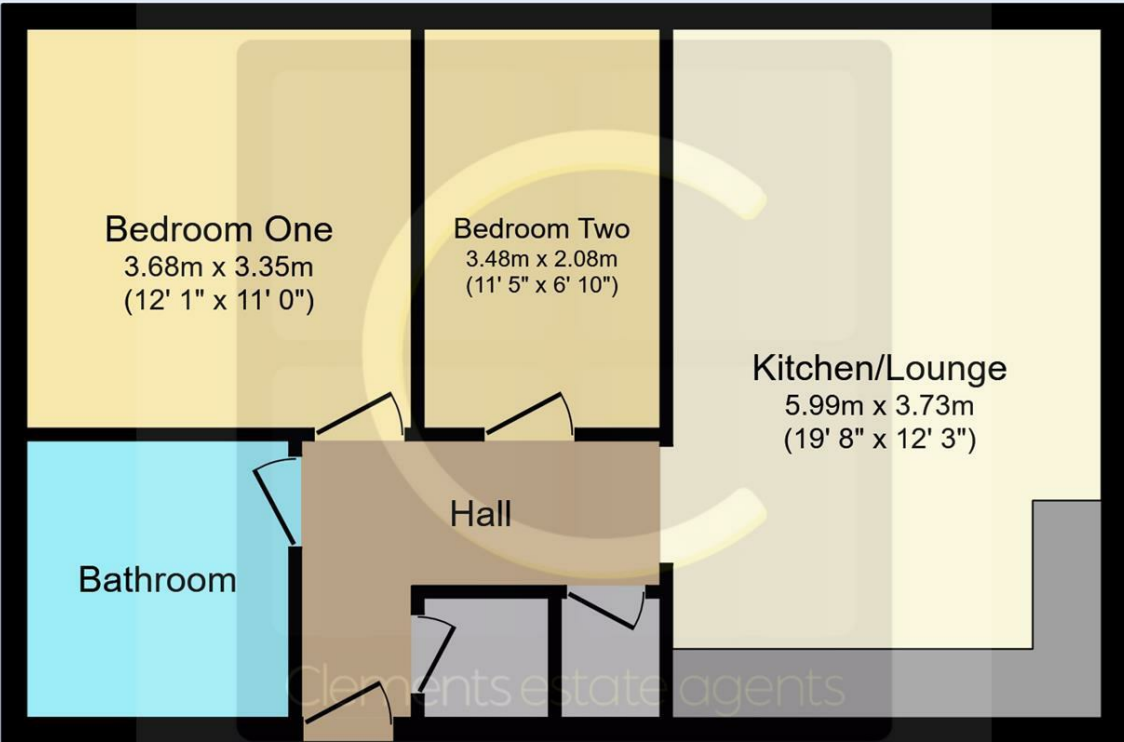

Floor Plan



This floor plan is for illustrative purposes only. It is not drawn to scale. Any measurements, floor areas (including any total floor area), openings and orientations are approximate. No details are guaranteed, they cannot be relied upon for any purpose and do not form any part of any agreement. No liability is taken for any error, omission or misstatement. A party must rely upon its own inspection(s). Powered by www.Propertybox.io

These particulars, whilst believed to be accurate are set out as a general outline only for guidance and do not constitute any part of an offer or contract. Intending purchasers should not rely on them as statements of representation of fact, but must satisfy themselves by inspection or otherwise as to their accuracy. No person in this firms employment has the authority to make or give any representation or warranty in respect of the property.

