

## Westerdale

, Hemel Hempstead, HP2 5TX

Clements are delighted to market this stunning ground floor SHARE OF FREEHOLD maisonette situated within a stones throw of local schools and amenities. The property benefits from DRIVEWAY PARKING, beautiful open plan living/kitchen area, double bedroom, modern bathroom and a great sized landscaped rear garden. VIEW IT OR MISS OUT.

**Asking Price £230,000**

# 39a Westerdale

, Hemel Hempstead, HP2 5TX



- Ground Floor Maisonette
- Modern & Bright
- Landscaped Rear Garden
- Driveway Parking
- Double Bedroom
- No Upper Chain
- Share of Freehold
- Open Plan Kitchen Area

**Living Room**  
16'10 x 14'7 (5.13m x 4.45m)

**Fitted Kitchen**  
12'5 x 8'5 (3.78m x 2.57m)

**Bedroom**  
12'7 x 8'8 (3.84m x 2.64m)

**Bathroom**

**Off Road Parking**

**Rear Garden**

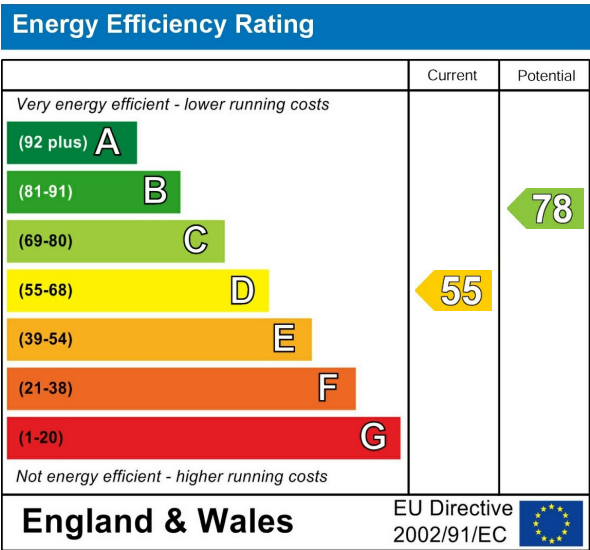







Floor Plan

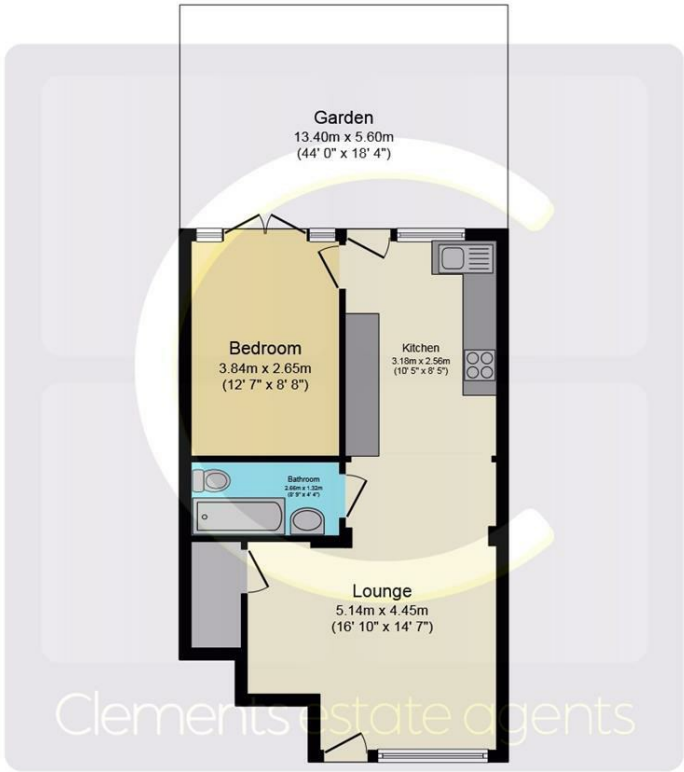

Floor Plan

Total floor area 46.4 sq.m. (499 sq.ft.) approx  
This plan is for illustration purposes only and may not be representative of the property. Plan not to scale. Powered by PropertyBox

These particulars, whilst believed to be accurate are set out as a general outline only for guidance and do not constitute any part of an offer or contract. Intending purchasers should not rely on them as statements of representation of fact, but must satisfy themselves by inspection or otherwise as to their accuracy. No person in this firms employment has the authority to make or give any representation or warranty in respect of the property.

