



Tattershall Drive, Hemel Hempstead, HP2 7QE

Price £375,000

Offered with the benefit of NO UPPER CHAIN is this staggered terrace house located in Woodhall Farm. Boasting three bedrooms, 23'10 max living room, fitted kitchen, double glazing, gas central heating, well kept gardens and garage. Situated within easy reach of the local shops and the M1, M25 and A41 road links.

Entrance Porch

Double glazed door, coving, storage cupboard and radiator.

Living Room 23'10 max x 15'10 max (7.26m max x 4.83m max)



Double glazed window, two radiators, dado rail, coving, brick built feature fireplace with gas effect fire, double glazed patio doors to garden, understairs cupboard and stairs to first floor.

Kitchen 8'8 x 7'10 (2.64m x 2.39m)



Fitted kitchen comprising wall and base units with work surfaces to compliment, 1 1/2 bowl sink with drainer double glazed window, plumbing for washing machine, electric cooker point with cooker hood over, tiled flooring and walls.

Landing



Loft access, storage cupboard, dado rail and coving.

Bedroom One 12'11 x 9'4 (3.94m x 2.84m)



Double glazed window and radiator.

Bedroom Two 10'10 x 9'4 max (3.30m x 2.84m max)



Double glazed window and radiator.

Bedroom Three 9'11 into recess x 6'4 (3.02m into recess x 1.93m)



Double glazed window, radiator and cupboard housing boiler.

Bathroom



Frosted double glazed window, bath with mixer taps and shower over, pedestal wash hand basin, low level wc and tiled walls.

Rear Garden

Paved with flower and shrub borders, shed, and rear access.

Garage

In block.

Floor Plan

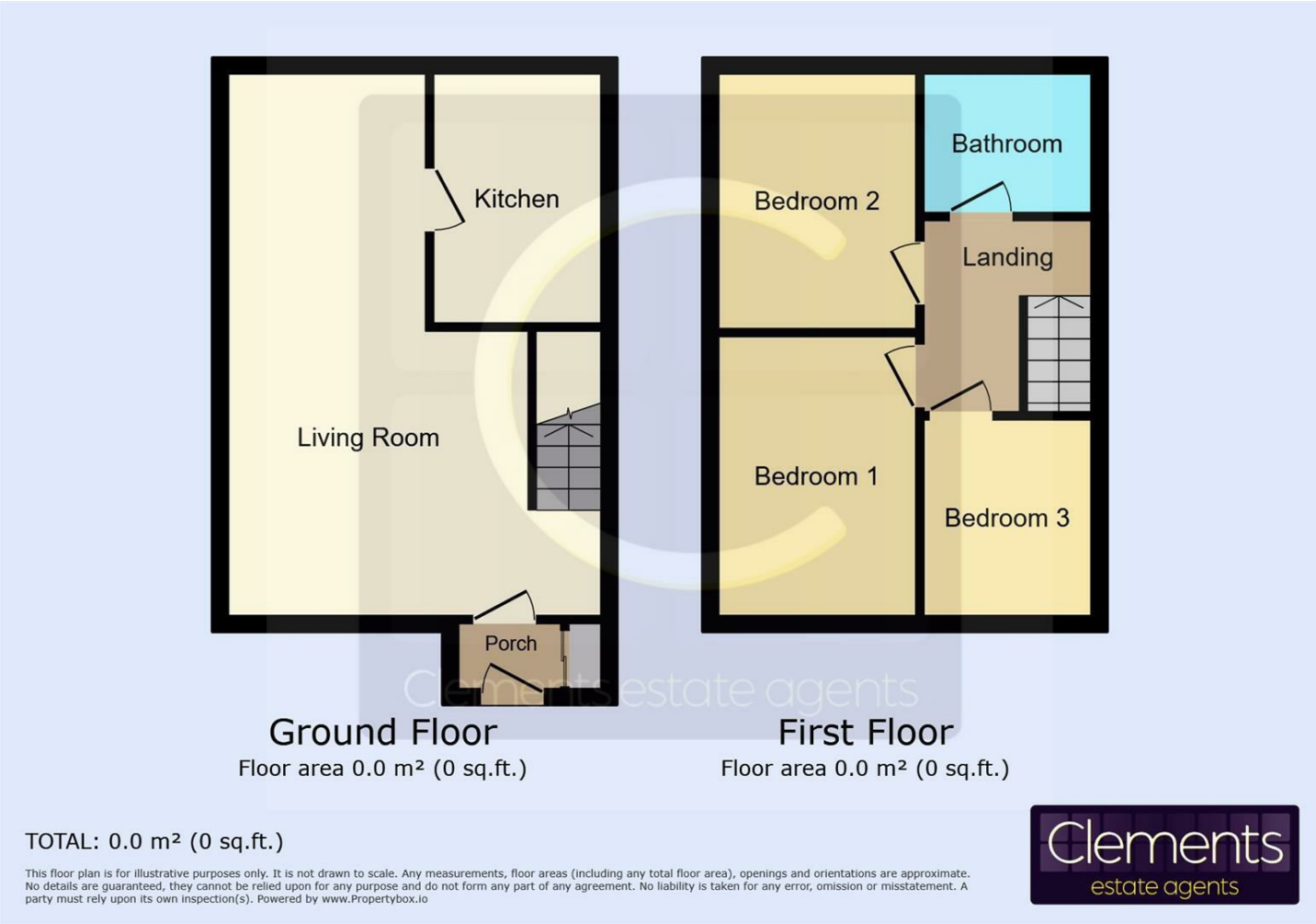

Area Map



Energy Efficiency Graph

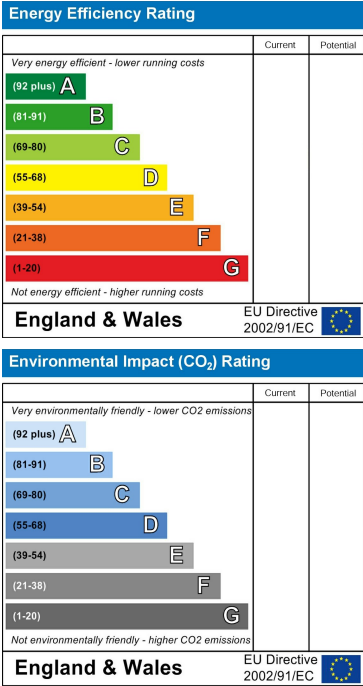

These particulars, whilst believed to be accurate are set out as a general outline only for guidance and do not constitute any part of an offer or contract. Intending purchasers should not rely on them as statements of representation of fact, but must satisfy themselves by inspection or otherwise as to their accuracy. No person in this firms employment has the authority to make or give any representation or warranty in respect of the property.