



Wolsey Road, Hemel Hempstead, HP2 4TU
Offers In Excess Of £180,000

Clements are delighted to market this perfectly presented one bedroom first floor flat ideally situated in the town centre close to all local amenities as well as being walking distance to Hemel Train Station. Offering stylish and open plan living accommodation including dual aspect living/kitchen area and modern fitted bathroom, underfloor heating, energy efficient electric throughout and ample storage. Ideal investment opportunity or first time buy.

Communal Entrance

Door to front with security system and stairs to lift to all floors.

Entrance Hall

Door to front with entry phone and storage cupboard.

Living Area



Dual aspect double glazed windows, TV point and underfloor heating.

Living/Kitchen Area 14'4" x 9'4" (4.37m x 2.84m)



Kitchen Area



Fitted with wall and base units with work surfaces to compliment, sink/drainer with splashbacks, electric oven and hob with cookerhood, plumbing for washing machine.

Bedroom 13'1" max x 10'9" (3.99m max x 3.28m)



Double glazed window , TV point and underfloor heating.

Bathroom



Fitted with bath with mixer taps, shower, wash hand basin, low level WC, underfloor heating

and part tiling.

Floor Plan

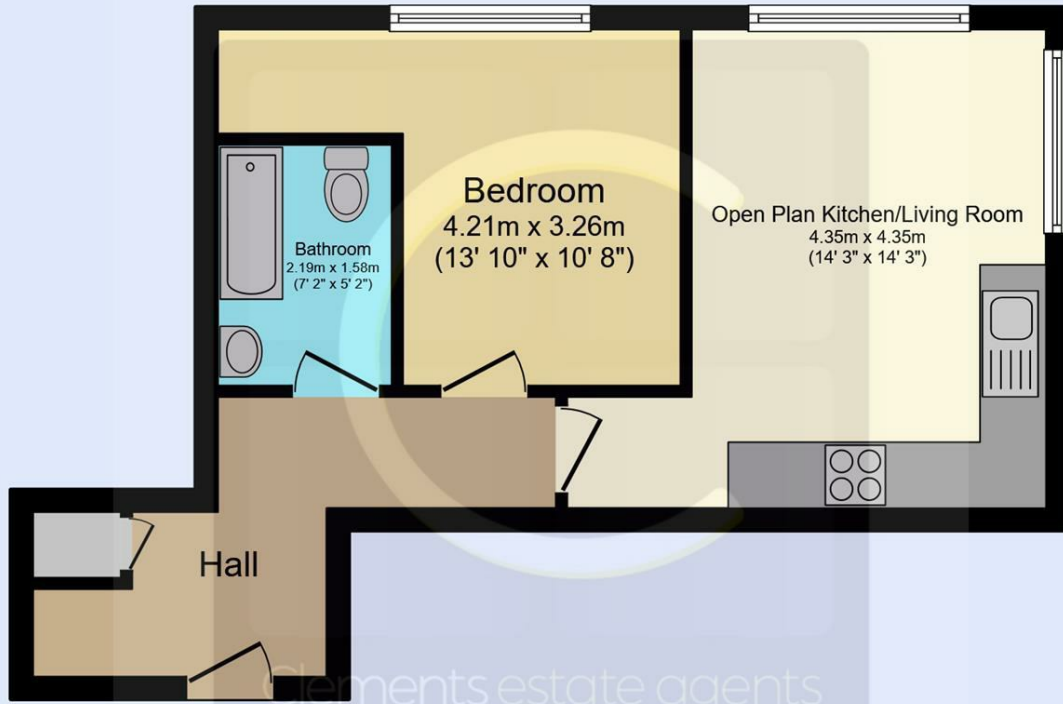

Floor Plan

Floor area 36.7 m² (395 sq.ft.)

TOTAL: 36.7 m² (395 sq.ft.)

This floor plan is for illustrative purposes only. It is not drawn to scale. Any measurements, floor areas (including any total floor area), openings and orientations are approximate. No details are guaranteed, they cannot be relied upon for any purpose and do not form any part of any agreement. No liability is taken for any error, omission or misstatement. A party must rely upon its own inspection(s). Powered by www.Propertybox.io



Area Map

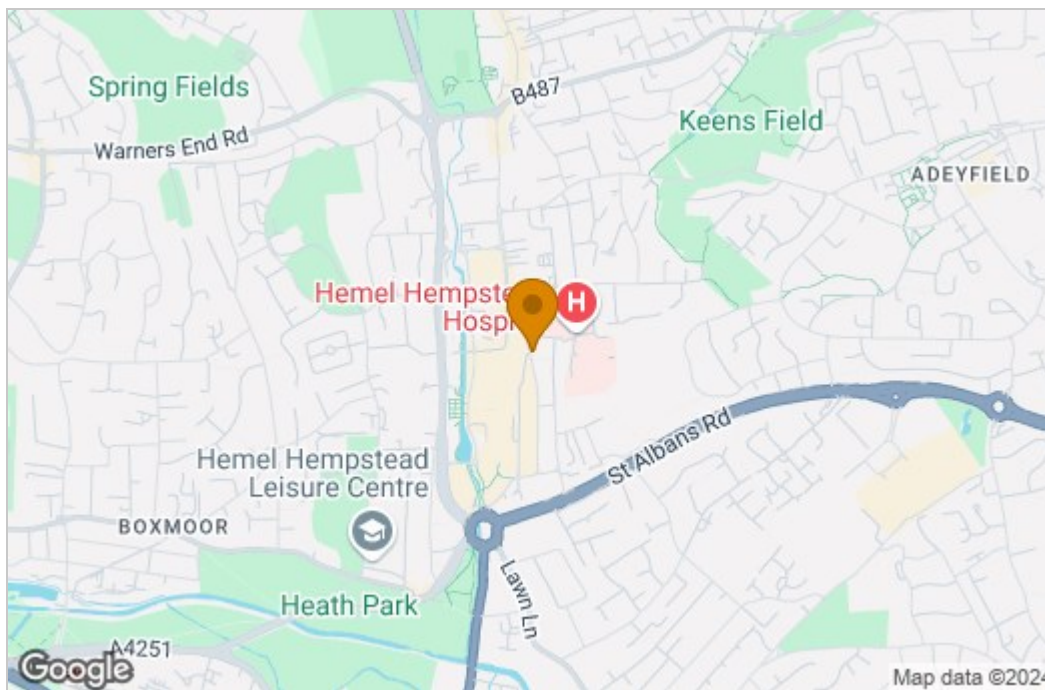

Energy Efficiency Graph

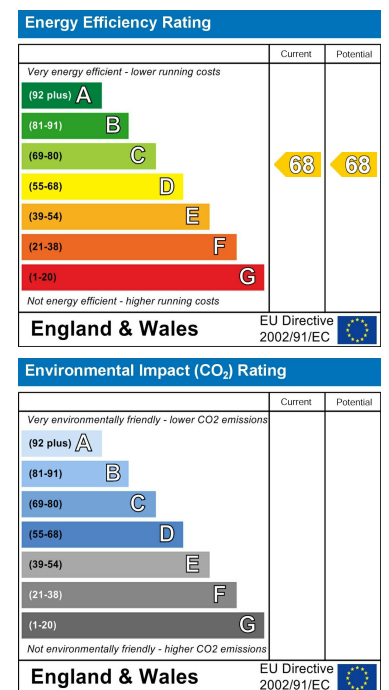

These particulars, whilst believed to be accurate are set out as a general outline only for guidance and do not constitute any part of an offer or contract. Intending purchasers should not rely on them as statements of representation of fact, but must satisfy themselves by inspection or otherwise as to their accuracy. No person in this firm's employment has the authority to make or give any representation or warranty in respect of the property.

45 Marlowes, Hemel Hempstead, Hertfordshire, HP1 1LD

Tel: 01442 214151 Email: sales@clementsestateagents.co.uk <https://www.clementsestateagents.co.uk>