



Longman House, Nash Mills Wharf, Hemel Hempstead, HP3 9GH Offers Invited £300,000

CHAIN FREE! Clements are delighted to offer to the market this STUNNING two bedroom luxury apartment situated on the third floor of this lovely block set in this desirable development. Benefits include excellent decorative order with a modern fitted kitchen, two bathrooms, balcony, allocated parking & well kept communal gardens. The property is located at the popular canal-side Nash Mills Wharf development with an excellent range of amenities and transport links.

ENTRANCE WITH LIFT TO THE 3rd FLOOR

ENTRANCE HALLWAY

OPEN PLAN LOUNGE / DINER / KITCHEN 21'7 x 11'10 (6.58m x 3.61m)



BALCONY

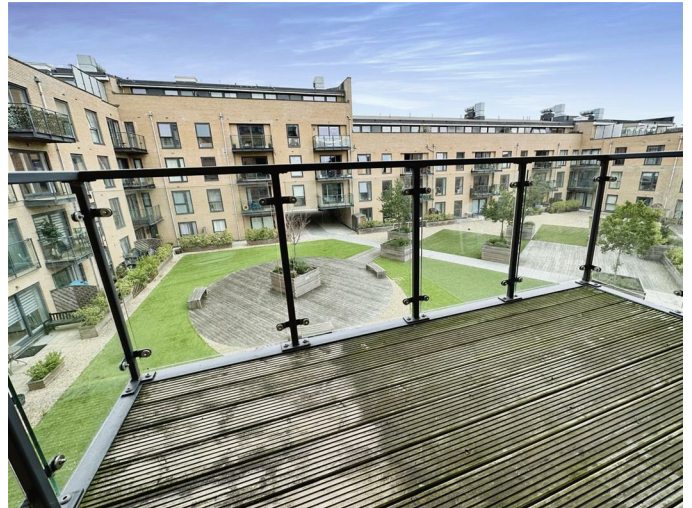

BEDROOM ONE 11'5 x 10 (3.48m x 3.05m)



LOUNGE / DINING AREA



EN SUITE SHOWER ROOM



KITCHEN AREA



BEDROOM TWO 11'5 x 8'7 (3.48m x 2.62m)



BATHROOM



OUTSIDE



COMMUNAL AREAS & ALLOCATED PARKING

Floor Plan

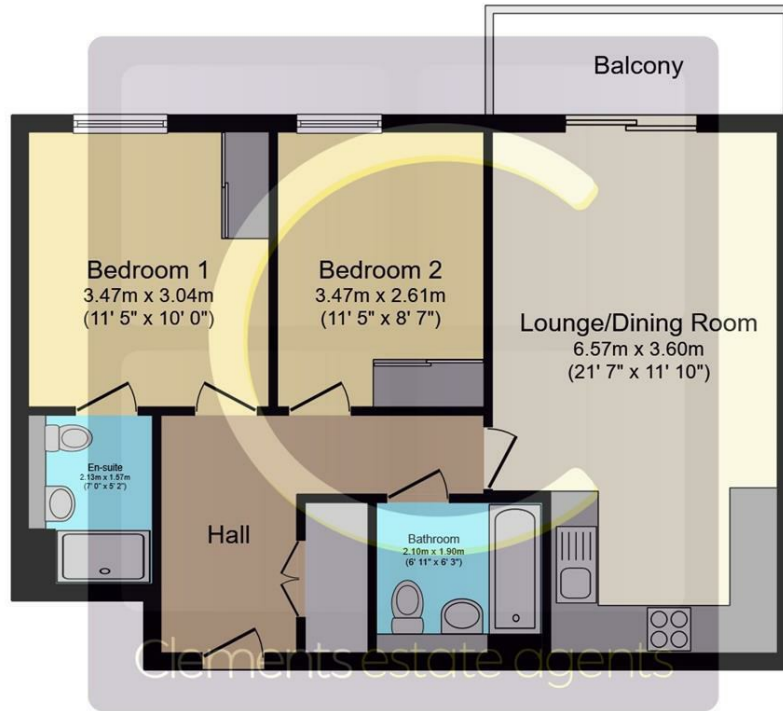

Floor Plan

Floor area 60.6 sq.m. (653 sq.ft.) approx

Total floor area 60.6 sq.m. (653 sq.ft.) approx

This Floor Plan is for illustration purposes only and may not be representative of the property. The position and size of doors, windows and other features are approximate. Unauthorized reproduction prohibited. © PropertyBOX

Area Map

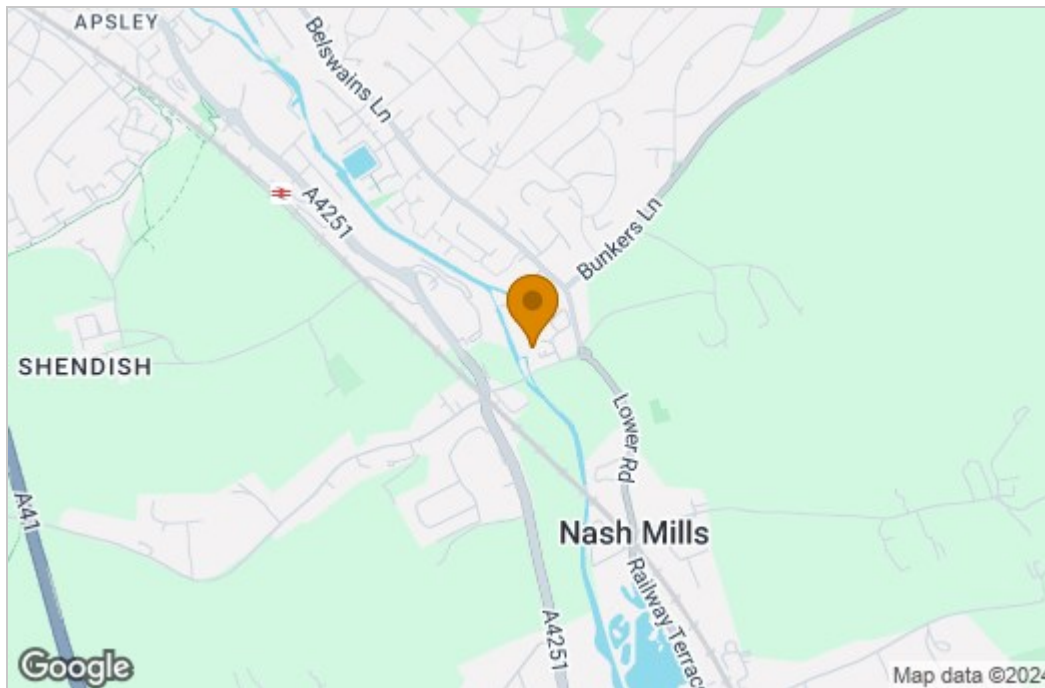

Energy Efficiency Graph

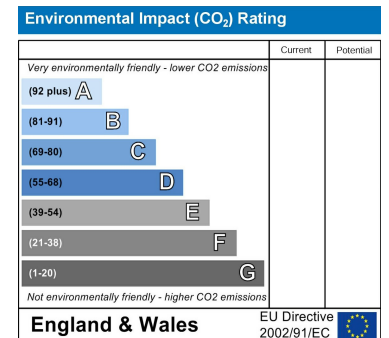
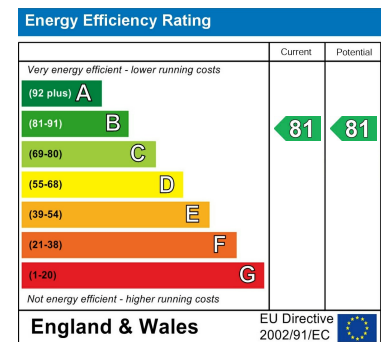

These particulars, whilst believed to be accurate are set out as a general outline only for guidance and do not constitute any part of an offer or contract. Intending purchasers should not rely on them as statements of representation of fact, but must satisfy themselves by inspection or otherwise as to their accuracy. No person in this firm's employment has the authority to make or give any representation or warranty in respect of the property.

45 Marlowes, Hemel Hempstead, Hertfordshire, HP1 1LD

Tel: 01442 214151 Email: sales@clementsestateagents.co.uk <https://www.clementsestateagents.co.uk>