



Flat 3 Clevedon Court Clive Road

, SE21 8BT

Asking Price £300,000

Nestled in the charming Clevedon Court on Clive Road, this well-presented one-bedroom apartment offers a delightful living experience in the desirable area of West Dulwich.

The property is immaculately presented throughout boasting lots of natural light and benefits from having a modern fitted kitchen with white goods included, gas central heating, and double glazing. Situated in an ideal location within easy reach of West Dulwich, Dulwich Village, and West Norwood with an array of shops, restaurants, and bars as well as being within close proximity to West Dulwich, West Norwood, and Tulse Hill train stations, all providing commuters' flexible access into Central London. There are also some fabulous green spaces nearby including Belair and Dulwich Park.

Lambeth Council
Council Tax Band B £1,451.00pa

Tenure: Leasehold

Lease Term: 164 years

Lease Commencement Date: 189 years from 24 June 1999

Service Charge: The service charge is currently £1,700 (paid in 2 installments of £850 every 6 months)

Ground Rent: £0

The vendor has provided the above information in good faith. Galloways have not yet had this information verified. Any buyer should seek their own independent legal advice before proceeding.

Viewing

Please contact our Galloways West Norwood Office on 020 8766 6111

if you wish to arrange a viewing appointment for this property or require further information

- ONE BEDROOM
- SECURE GATED DEVELOPMENT
- WELL PRESENTED THROUGHOUT
- BRIGHT AND AIRY
- GREAT LOCATION
- CLOSE TO LOCAL AMENITIES
- STYLISH BATHROOM SUITE
- GAS CENTRAL HEATING / DOUBLE GLAZING
- 0.7 MILES FROM WEST DULWICH TRAIN STATION
- (DISTANCES ESTIMATED VIA GOOGLE MAPS)



1



1



1



1



1

Floor Plan

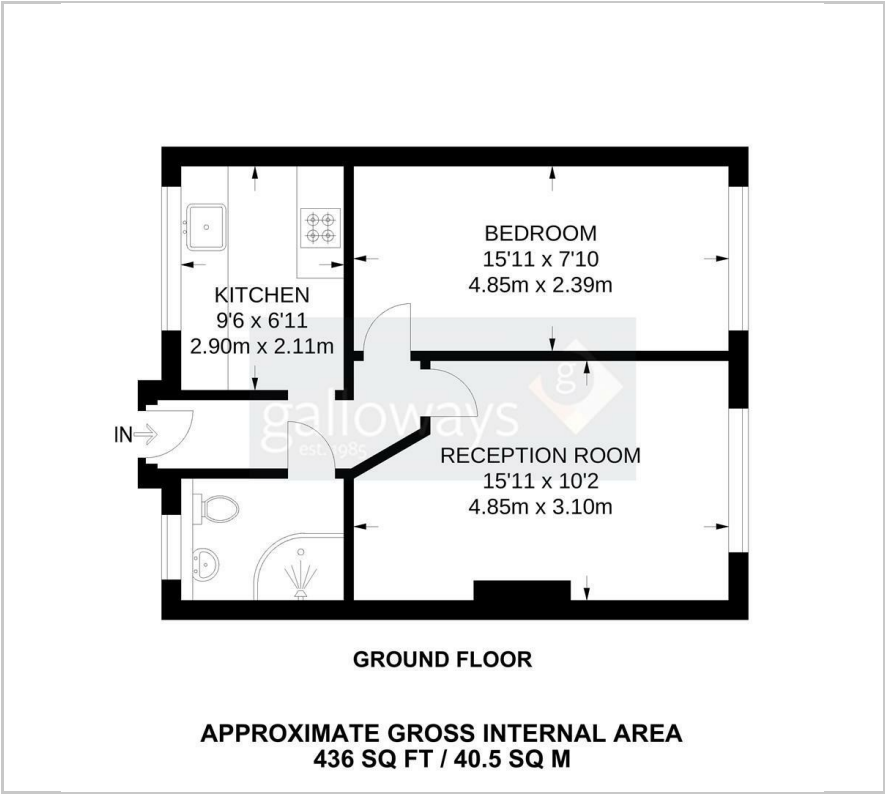

Area Map



Energy Efficiency Graph

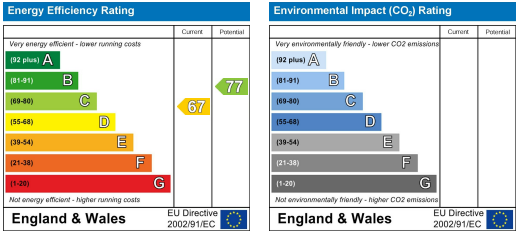

These particulars, whilst believed to be accurate are set out as a general outline only for guidance and do not constitute any part of an offer or contract. Intending purchasers should not rely on them as statements of representation of fact, but must satisfy themselves by inspection or otherwise as to their accuracy. No person in this firms employment has the authority to make or give any representation or warranty in respect of the property.