



42 Elder Road

London, SE27 9ND

Asking Price £535,000

Nestled in the heart of West Norwood, this charming Victorian terraced house on Elder Road presents an excellent opportunity for both first-time buyers and investors alike. With two well-proportioned bedrooms, a separate kitchen and reception room, and a thoughtfully designed bathroom, this property is both functional and inviting.

The interior is well-presented throughout, offering a blank canvas for you to personalise and make your own. The potential for extension exists, subject to planning permission, allowing you to enhance the living space to suit your needs.

Location is key, and this property does not disappoint. It is conveniently situated within walking distance of a fantastic array of local amenities, ensuring that everything you need is just a stone's throw away. Additionally, West Norwood train station and bus station are nearby, providing excellent transport links to central London and beyond. The property also benefits from being opposite Norwood Park and is in the catchment area of some outstanding schools.

This delightful home combines the charm of Victorian architecture with the potential for modern living, making it a must-see for anyone looking to settle in a vibrant and well-connected community. Don't miss the chance to explore the possibilities this property has to offer.

Tenure: Freehold
Lambeth Council
Council Tax Band: D (£1865.00)

Viewing

Please contact our Galloways West Norwood Office on 020 8766 6111

if you wish to arrange a viewing appointment for this property or require further information

- TWO DOUBLE BEDROOMS
- CHARMING VICTORIAN TERRACED HOUSE
- FREEHOLD
- REAR GARDEN
- GREAT LOCATION
- GAS CENTRAL HEATING
- MODERN FITTED KITCHEN
- OPPOSITE NORWOOD PARK
- WITHIN WALKING DISTANCE TO WEST NORWOOD HIGH STREET
- WITHIN WALKING DISTANCE TO WEST NORWOOD TRAIN STATION



2



1



null



D

Floor Plan

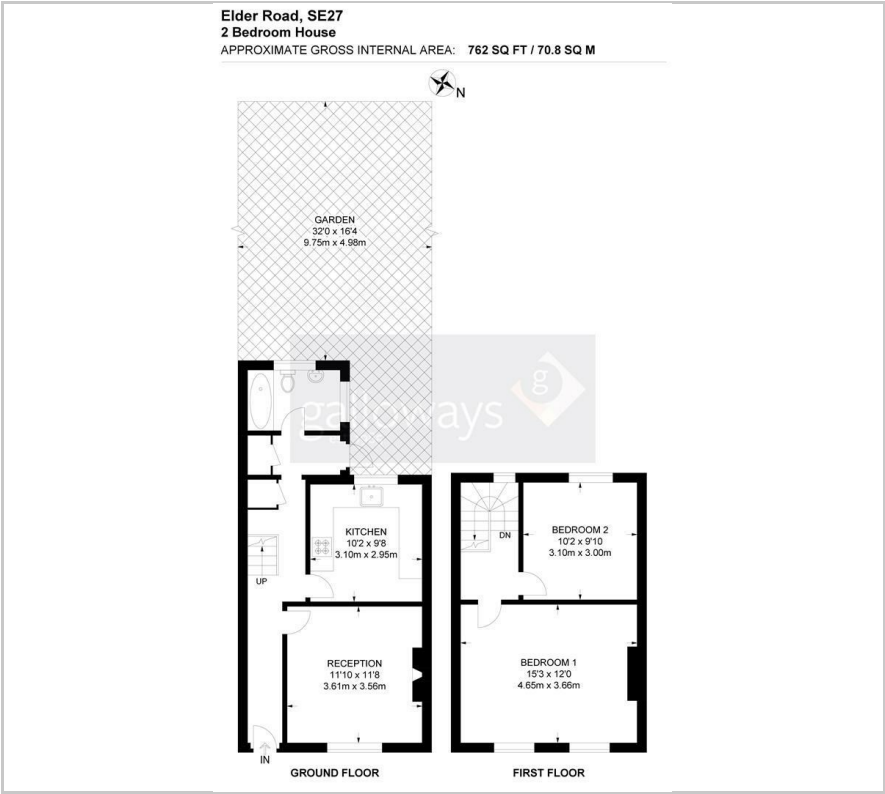

Area Map



Energy Efficiency Graph

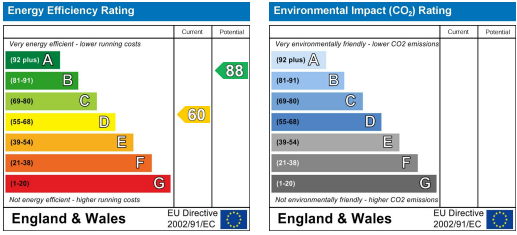

These particulars, whilst believed to be accurate are set out as a general outline only for guidance and do not constitute any part of an offer or contract. Intending purchasers should not rely on them as statements of representation of fact, but must satisfy themselves by inspection or otherwise as to their accuracy. No person in this firms employment has the authority to make or give any representation or warranty in respect of the property.