



167c Auckland Hill

West Norwood, SE27 9PG

Asking Price £450,000

Galloways are delighted to present to the market this stunning two-bedroom Victorian conversion on Auckland Hill. The property has been refurbished to an incredible standard throughout. It benefits from being sold chain-free with a share of the freehold and features, two double bedrooms, a modern state-of-the-art fitted kitchen with built-in appliances, a stylish bathroom suite with feature panelling perfect for relaxing after a long day, and direct access to a beautifully landscaped rear garden perfect for outside enjoyment and entertaining.

The property is situated in an ideal location in the heart of West Norwood, with a fantastic range of amenities on your doorstep, including the West Norwood Picturehouse, an abundance of shops, restaurants, cafés, and some great pubs. There is also a superb choice of green spaces, including Brockwell Park and Norwood Park. West Norwood train station is just a 5-minute walk away, with Tulse Hill station also within close proximity. The property benefits from excellent transport links, with multiple bus routes nearby and easy access to Brixton's Victoria Line Tube station providing commuters easy access to the city and surrounding areas.

This is a rare opportunity to acquire a beautifully refurbished property in a sought-after location, offering a perfect blend of modern living and Victorian charm. Don't miss out on the opportunity to own this stunning Victorian flat in the heart of West Norwood and book your appointment today.

Lambeth Council
Council Tax Band C £1476.00pa

Viewing

Please contact our Galloways West Norwood Office on 020 8766 6111

if you wish to arrange a viewing appointment for this property or require further information

- STUNNING TWO DOUBLE BEDROOM VICTORIAN CONVERSION
- IMMACULATLY REFURBISHED THROUGHOUT
- SHARE OF FREEHOLD
- CHAIN FREE
- NEW HOWDENS FITTED KITCHEN WITH BUILT-IN APPLIANCES
- STYLISH BATHROOM SUITE WITH FEATURE PANNELLING
- BEAUTIFULLY LANDSCAPED REAR GARDEN
- NEW BOILER AND NEW DOUBLE GLAZED WINDOWS
- 5 MINUTE WALK FROM WEST NORWOOD STATION
- (TIMES ESTIMATED VIA GOOGLE MAPS)



Floor Plan

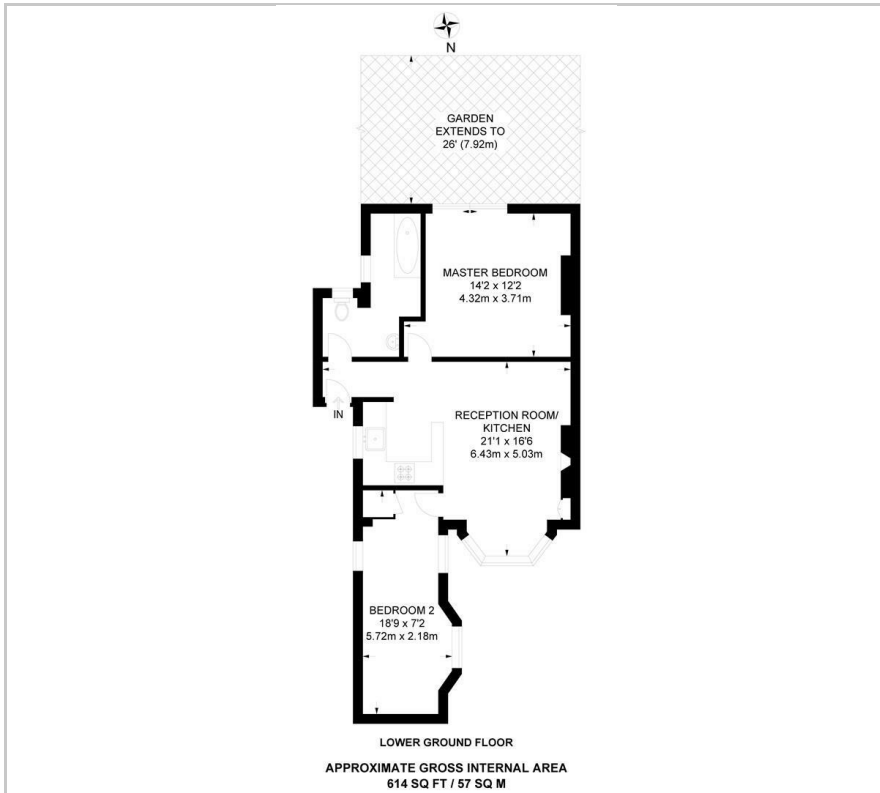

Area Map



Energy Efficiency Graph

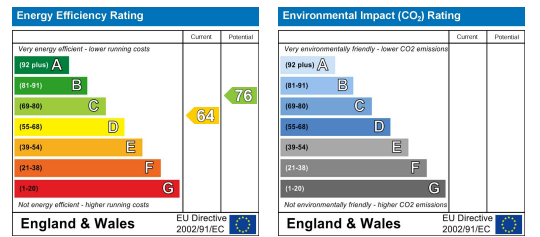

These particulars, whilst believed to be accurate are set out as a general outline only for guidance and do not constitute any part of an offer or contract. Intending purchasers should not rely on them as statements of representation of fact, but must satisfy themselves by inspection or otherwise as to their accuracy. No person in this firm's employment has the authority to make or give any representation or warranty in respect of the property.