



# 1 Durban Road

, SE27 9RW

**£1,500 PCM**

A fantastic two-bedroom ground floor Victorian maisonette with its own rear garden, located on the borders of Dulwich and within walking distance of West Norwood train station. The property has just been decorated throughout and has had new carpets fitted. The flat also comes with its own parking space to the rear.

Lambeth Council

Council Tax Band C £1658.00pa

Total Deposit £1730.75 (5 Weeks Rent)

## Viewing

Please contact our Galloways West Norwood Office on 020 8766 6111

if you wish to arrange a viewing appointment for this property or require further information

- A TWO DOUBLE BEDROOM GROUND FLOOR VICTORIAN MAISONETTE
- OWN FRONT DOOR
- CONTEMPORARY FITTED KITCHEN WITH INTEGRATED APPLIANCES
- DOUBLE GLAZED WINDOWS
- OPEN PLAN KITCHEN/RECEPTION ROOM
- NEW FITTED CARPETS
- MODERN FITTED SHOWER ROOM
- SOLE USE OF THE REAR GARDEN
- LOCATED ON THE BORDERS OF DULWICH
- OFF STREET PARKING



## Floor Plan

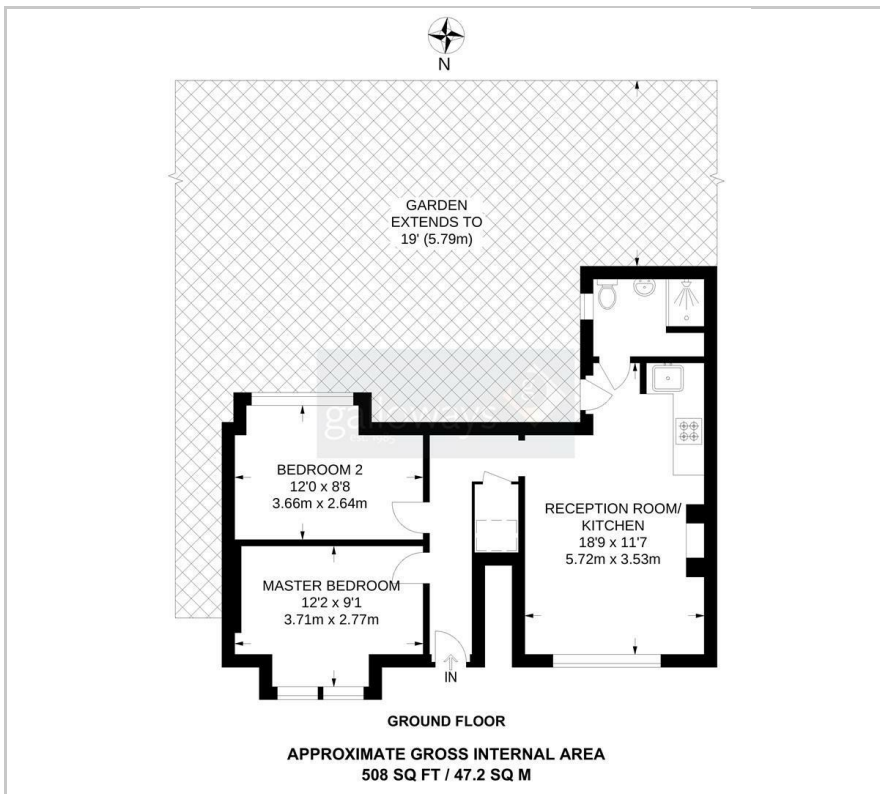

## Area Map



## Energy Efficiency Graph

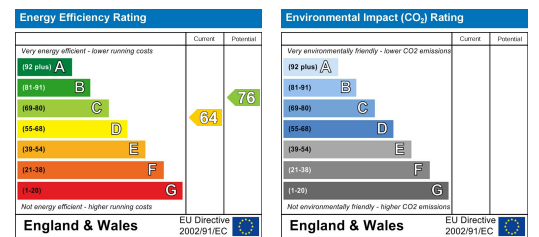

These particulars, whilst believed to be accurate are set out as a general outline only for guidance and do not constitute any part of an offer or contract. Intending purchasers should not rely on them as statements of representation of fact, but must satisfy themselves by inspection or otherwise as to their accuracy. No person in this firm's employment has the authority to make or give any representation or warranty in respect of the property.