



## 156A Norwood Road

London, SE27 9AZ

**£1,100 PCM**

A bright, airy, and spacious studio apartment situated in an ideal location within easy reach of a fantastic array of local amenities, transport links, and green spaces. Brockwell Park is a 10-minute walk away and Tulse Hill Train Station is a 3-minute walk away. (Times estimated via Google Maps).

Lambeth Council

Council Tax Band A £1244.00pa

Total Deposit £1269.25 (5 Weeks Rent)

### Viewing

Please contact our Galloways West Norwood Office on 020 8766 6111

if you wish to arrange a viewing appointment for this property or require further information

- A SPACIOUS STUDIO APARTMENT
- BRIGHT AND AIRY
- AVAILABLE FROM THE 7TH OF JUNE
- FANTASTIC LOCATION
- 3 MINUTE WALK TO TULSE HILL STATION
- 10 MINUTE WALK TO BROCKWELL PARK
- (TIMES ESTIMATED VIA GOOGLE MAPS)



1



1



0



3

D

## Floor Plan

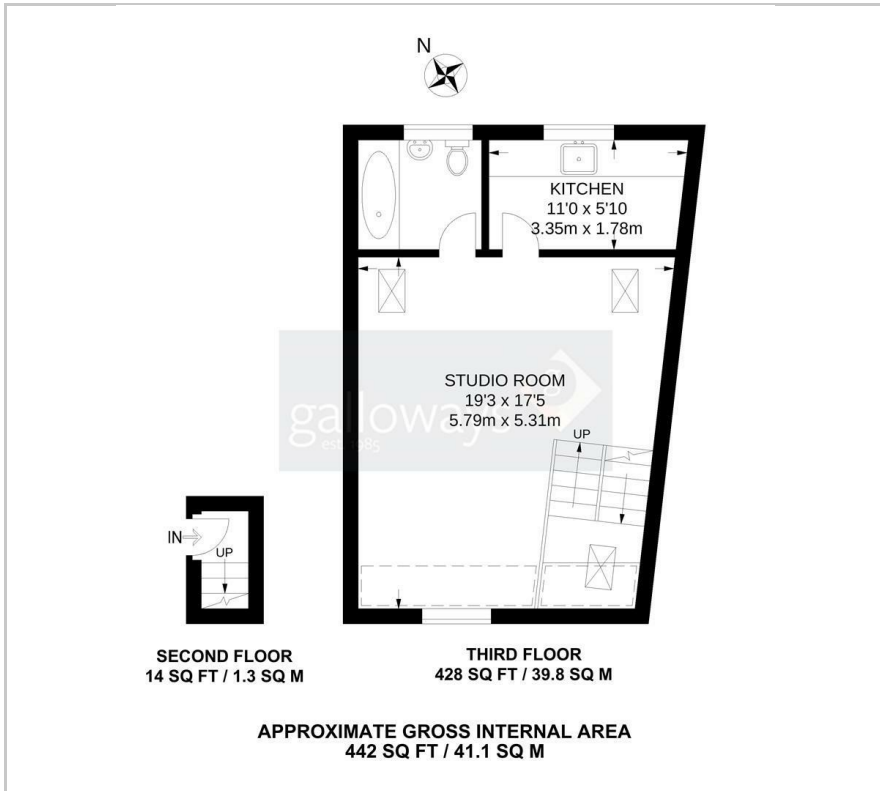

## Area Map

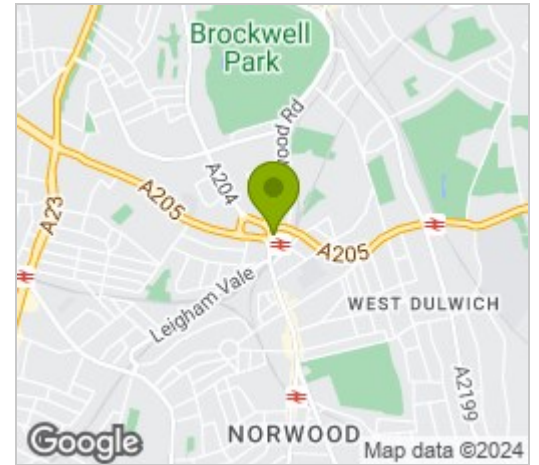

## Energy Efficiency Graph

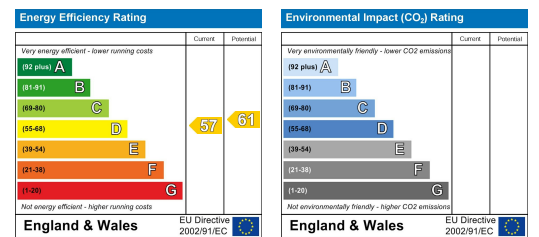

These particulars, whilst believed to be accurate are set out as a general outline only for guidance and do not constitute any part of an offer or contract. Intending purchasers should not rely on them as statements of representation of fact, but must satisfy themselves by inspection or otherwise as to their accuracy. No person in this firm's employment has the authority to make or give any representation or warranty in respect of the property.