



Church Road, Surrey, TW20 9HZ

£1,100 pcm Guide Price



A modern first floor one bedroom apartment, with use of communal courtyard, situated in central Egham and within walking distance of mainline train station, as well as Magna Square with Everyman Cinema. The property comprises of a fully fitted kitchen, separate cloakroom, lounge with dining area and bathroom. Further benefits include electric central heating, double glazing, security door entrance system and allocated underground parking.

AVAILABLE 3RD APRIL 2023 - FURNISHED

Church Road, Egham, Surrey, TW20 9HZ

FLOOR PLAN

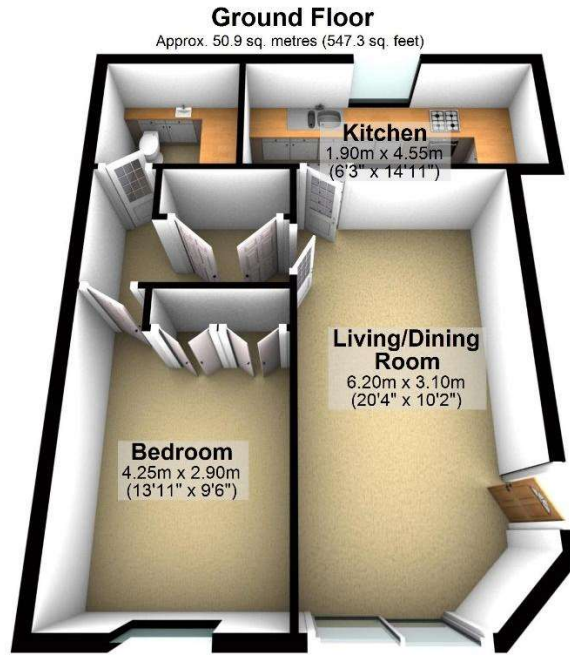

Total area: approx. 50.9 sq. metres (547.3 sq. feet)

All measurements are approximate. Nevin and Wells Residential have not tested any systems or appliances.

EPC

