

TO LET

3 Wessex Court Albert Street, Fleet, Hampshire, GU51 3YD

£1,100 PCM



- One Double Bedroom
- Modern Bathroom
- Built-In Wardrobe
- Two Allocated Parking Spaces
- Council Tax Band C
- Spacious Lounge
- Modern Fitted Kitchen with Integrated Appliances
- Gas Central Heating
- 5 Week Deposit £1269.23
- EPC Energy Rating Band (C) 73

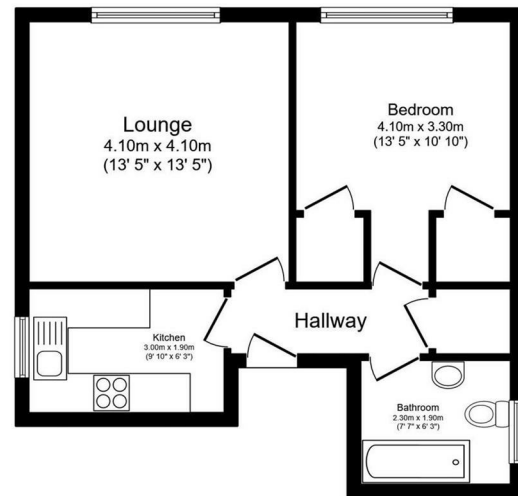

Floor Plan

Total floor area 45.0 sq.m. (485 sq.ft.) approx

This plan is for illustration purposes only and may not be representative of the property. Plan not to scale. Powered by PropertyBox

THE PROPERTY

This spacious one bedroom first floor flat is situated just a stone's throw away from Fleet high street. The property offers a spacious lounge/dining room, a fully fitted kitchen with integrated white goods and a modern bathroom with electric shower over bath. It also includes gas central heating, double glazed windows and two allocated parking spaces. Inside the generous sized double bedroom, you will also find built-in wardrobes.

The property is walking distance of the Mainline Railway Station and local amenities, with easy access to the M3 and the A30. Available mid-July.

About Fleet

Fleet is situated in the north-east corner of Hampshire, near the M3 motorway and surrounded by small thriving towns and many parishes of unspoiled villages.

The Basingstoke Canal runs through the area and is a popular area for walking, cycling and fishing. You will also find the Yateley Common Country Park which contains nearly 500 acres of heathland and Fleet Pond is the largest lake in Hampshire.

This historic town also benefits from the Hart Leisure Centre, plenty of pubs and restaurants and convenient amenities.

SITUATION

Directions

The Wellington Centre, 10 Low Walk, Aldershot, Hampshire, GU11 1DB

Tel: 01252 344333 Email: lettings@fostersestateagents.com fostersestateagents.com